

# CENTERLINE TIES TRACT NO. 29766

X-Street: SELINA ST.

OFFICIAL USE ONLY

Street: BERRY RD.

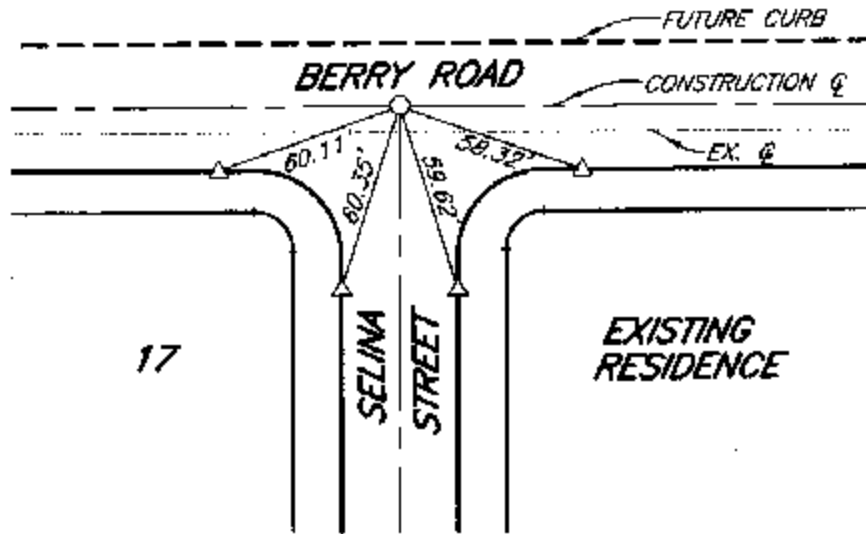

17

SELINA  
STREET

EXISTING  
RESIDENCE

### LEGEND:

- INDICATES SET BOAT SPIKE AND LS 4311 WASHER, FLUSH.
- INDICATES SET LEAD AND LS 4311 TAG ON TOP OF CONCRETE CURB.
- △ INDICATES SET LEAD AND BRASS PIN ON TOP OF CONCRETE CURB.



SCALE IN FEET

**KWG ENGINEERS**

CIVIL ENGINEERING, PLANNING AND CONSTRUCTION MANAGEMENT  
1880 COMPTON AVENUE, SUITE 100 • CORONA, CA 92681-3370 • 909-734-2130

11281.TIF

PRINTED: 00-00-04 1M