

11314 JIF

Street:

JANET AVENUE

X-Street

END W. OF PICKER

OFFICIAL USE ONLY

SWING TIES

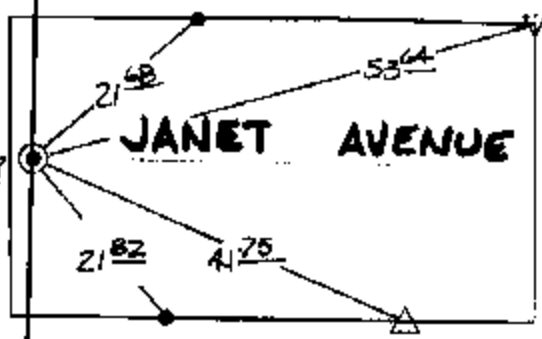

FD 1/2" I.P. PBR.
 CITY TIE SH. FOR
 INT. OF TR. BNDY
 + JANET & W/L
 5091 ON 0.15'

- ✕ FD. Ramset Nail on T/C
 - FD. LD. & TK. on T/C
 - FD. "C" Nail on T/C
 - Set LD. & TK. on T/C
- P.K. and City Engineer tag to be set @ surface after street construction is complete. (if possible)*

Scale: 1" = 20'
 Date: 04/01/04
 Drawn by: SURVEY
 F.B.:
 TR-Sec: T3SR6W-1

OFFICIAL TIE PLAT

CITY OF RIVERSIDE

These ties are for the purpose of perpetuating the found monumentation. No claim is made as to the relationship of the points or lines shown hereon to true boundary locations.



Sheet 1 of 1
 Cadme MB: 50-5