

RIVERSIDE, CALIFORNIA 9-3-90

STREET: CAMINO DEL SOL X-STREET GREENOCK WAY

OFFICE USE ONLY

LEGEND

- -- SET 1" I.P. w/RCE 17550 PASTIC PLUG FLUSH
- -- SET RAMSET NAIL ON T.C.
- △ -- SET NAIL w/RCE 17550 TAG ON T.C.
- -- SET SPIKE w/WASHER STAMPED RCE 17550 FLUSH

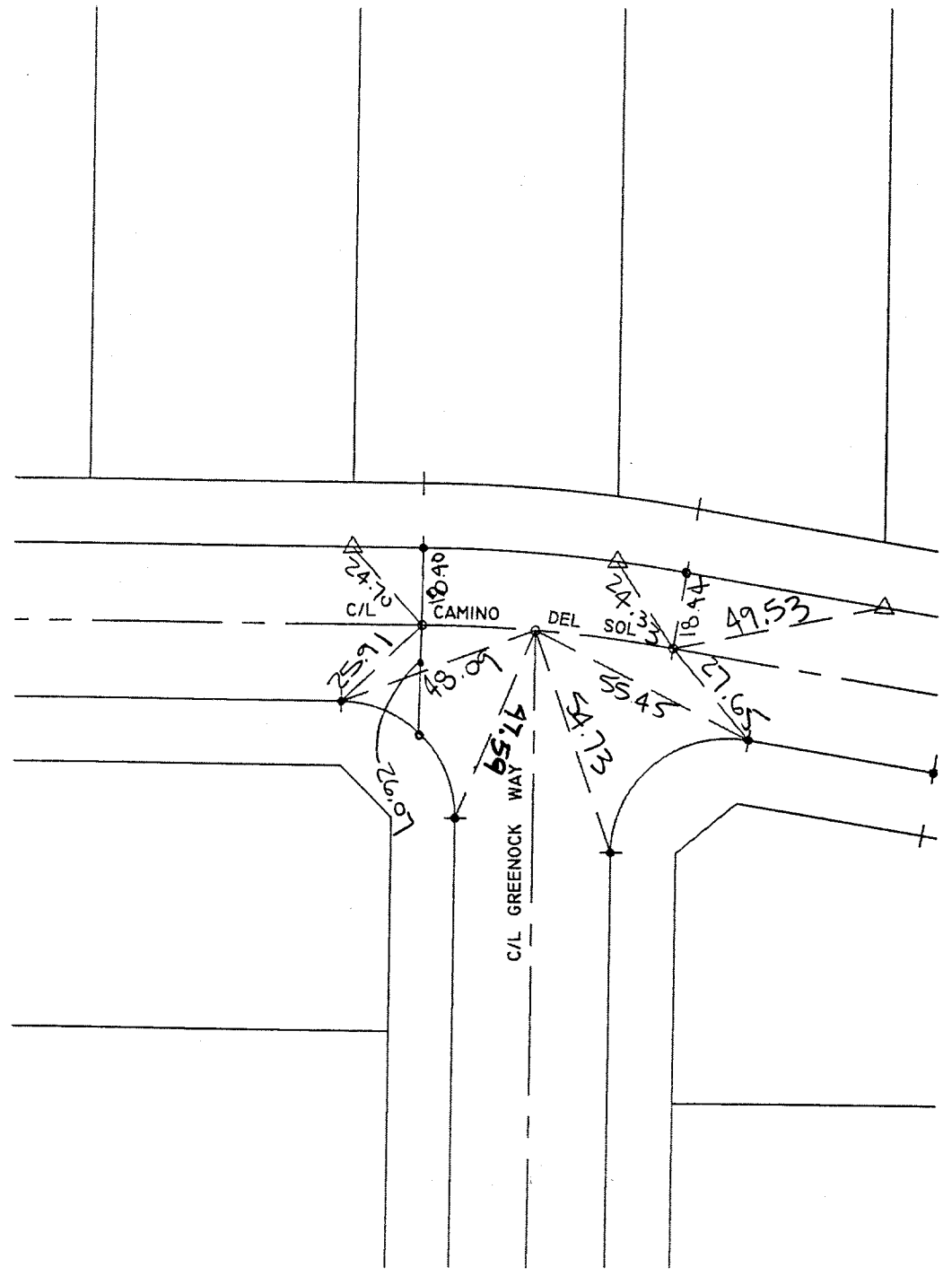

TR.27982-3

1161-TIF

SCALE: 1"=40'

DATE: 9.3.90

DR. BY: PP

F.B.:

OFFICIAL TIE PLAT
CITY OF RIVERSIDE

CEC CANTY ENGINEERING GROUP, INC.
 CIVIL ENGINEERING - PLANNING - SURVEYING
 2020 IOWA AVENUE, SUITE A-102, P.O. BOX 52050, RIVERSIDE, CA 92517
 TEL (909) 683 - 5234 FAX (909) 683 - 5301

SHEET
2
 OF 9 SHEETS
 FILE NO:
1092-006