

750116A, GRAYBILL 1-3-10

STREET: CAMINO DEL SOL X-STREET TWEED WAY

OFFICE USE ONLY

**LEGEND**

- -- SET 1" I.P. w/RCE 17550 PASTIC PLUG FLUSH
- -- SET RAMSET NAIL ON T.C.
- △ -- SET NAIL w/RCE 17550 TAG ON T.C.
- ◊ -- SET SPIKE w/WASHER STAMPED RCE 17550 FLUSH

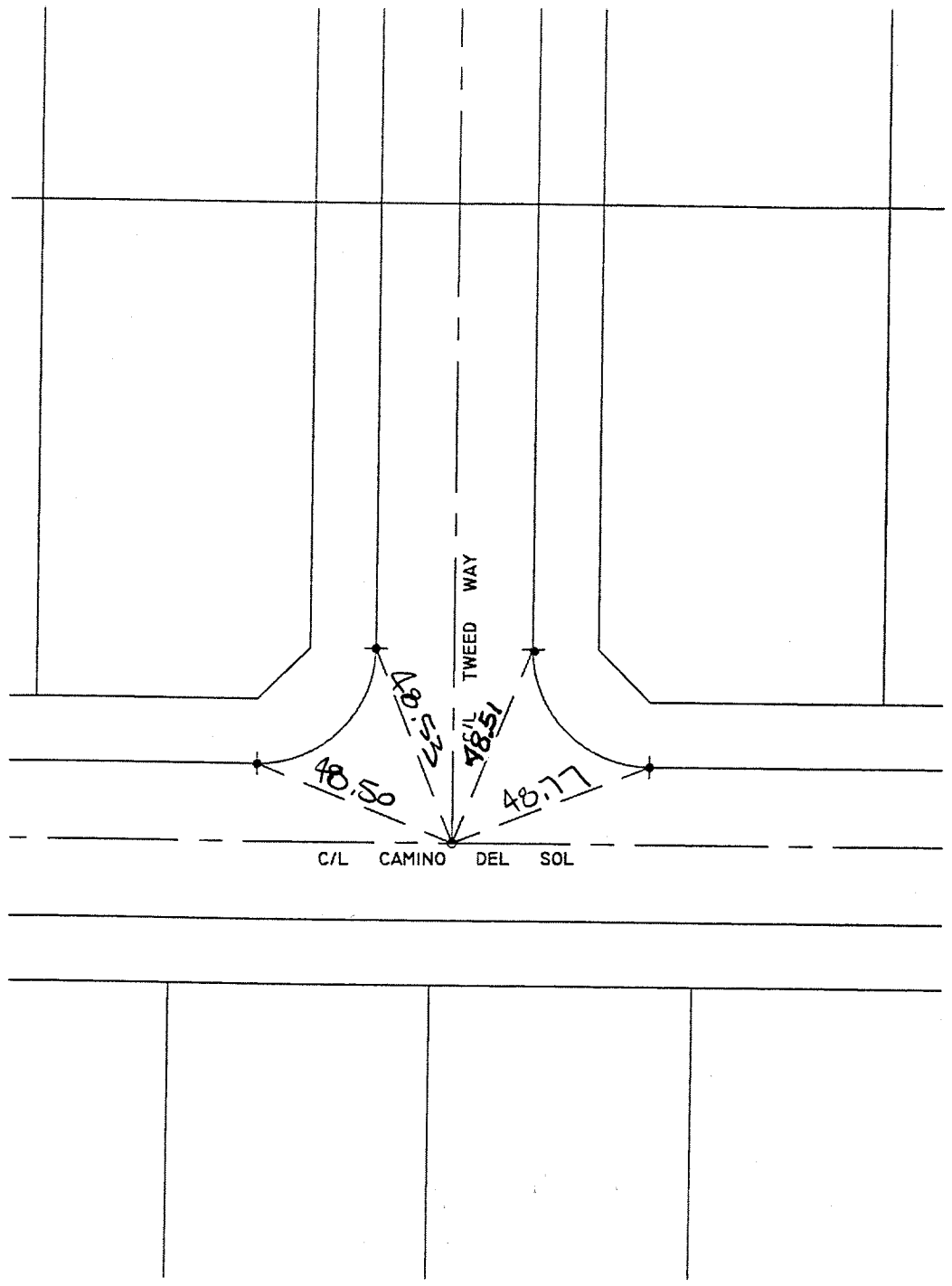
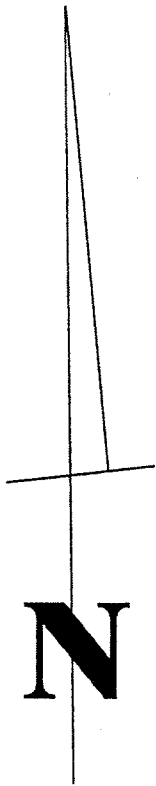

TR.27982-3

SCALE: 1"=40'

DATE: 9.3.98

DR. BY: RAP

F.B.:

**OFFICIAL TIE PLAT  
CITY OF RIVERSIDE**



**CANTY ENGINEERING GROUP, INC.**  
CIVIL ENGINEERING - PLANNING - SURVEYING

2020 IOWA AVENUE, SUITE A-102, P.O. BOX 52050, RIVERSIDE, CA 92517  
TEL (909) 683 - 5234 FAX (909) 683 - 5301

SHEET

**3**

OF 9 SHEETS

FILE NO:

**1032.006**

1162.TIF