

11992.TIF

Street: MARICOPA DRIVE

X-Street: OFFICIAL USE ONLY

BLAINE STREET

FD NOTHING @ SURFACE

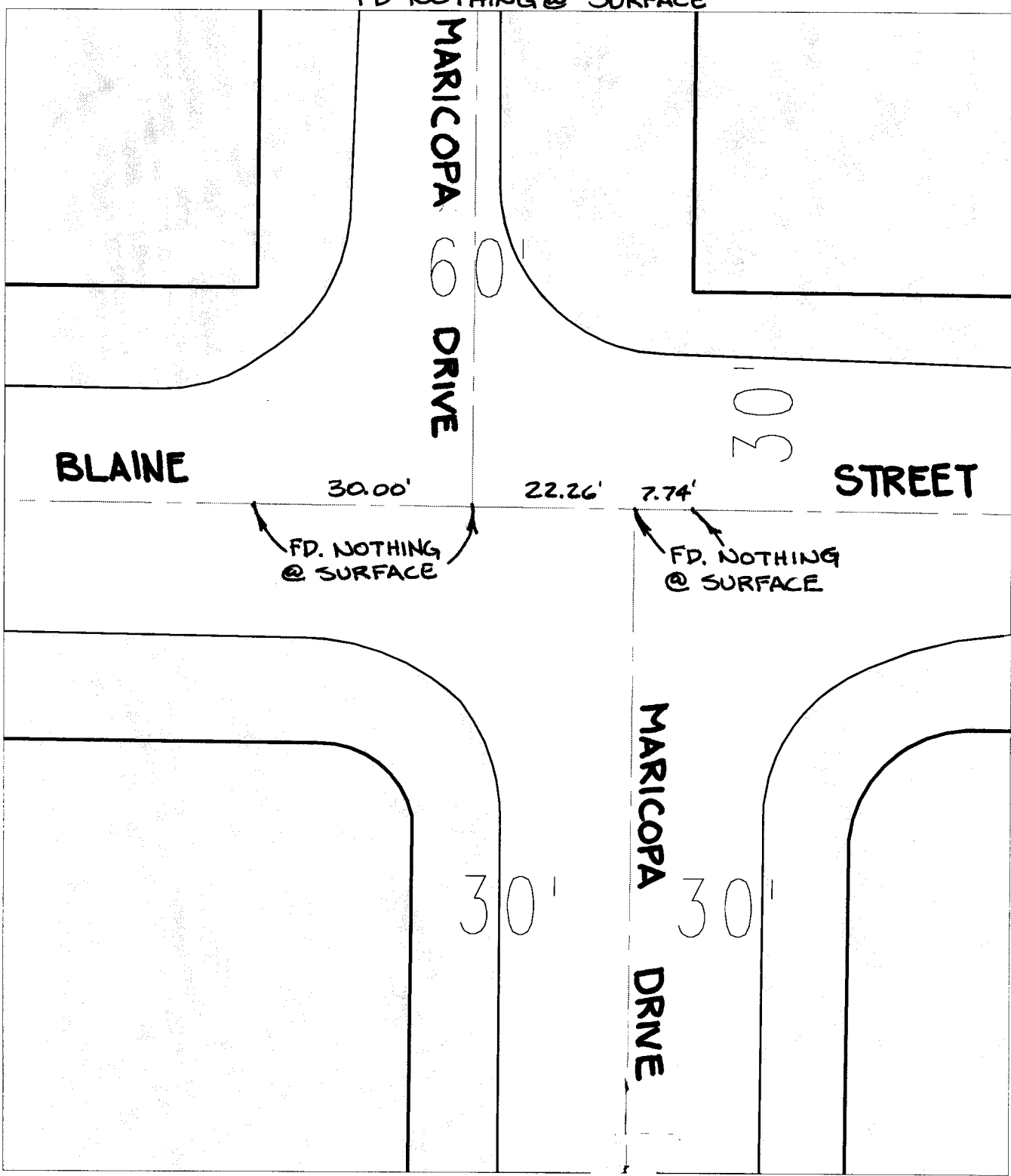

BLAINE

MARICOPA DRIVE

STREET

30.00'

22.26'

7.74'

FD. NOTHING @ SURFACE

FD. NOTHING @ SURFACE

MARICOPA DRIVE

30'

30'

- ✕ FD. Ramset Nail on T/C
- FD. "C" Nail on T/C
- FD. LD. & TK. on T/C
- Set LD. & TK. on T/C

P.K. and City Engineer tag to be set @ surface after street construction is complete. (If possible)

Scale: 1" = 20'

Date: 01/20/06

Drawn by: scurtis

F.B.:

TR-Sec: T2SR4W-21

OFFICIAL TIE PLAT

CITY OF RIVERSIDE

These ties are for the purpose of perpetuating the found monumentation. No claim is made as to the relationship of the points or lines shown hereon to true boundary locations.



Sheet 1 of 1

Cadme MB: 27-8