

Street: CASTLEMAN ST.

X-Street: MILLER
OFFICIAL USE ONLY

MILLER

CASTLEMAN ST.

@ MILLER

CREB

MILLER @ CASTLEMAN

F.B. 926/16

HISTORICAL DATA

PARCEL MAP 220

CREB 948

TRANSIT TIES

CREW

FRIC

NEW

MAY 12, 1971

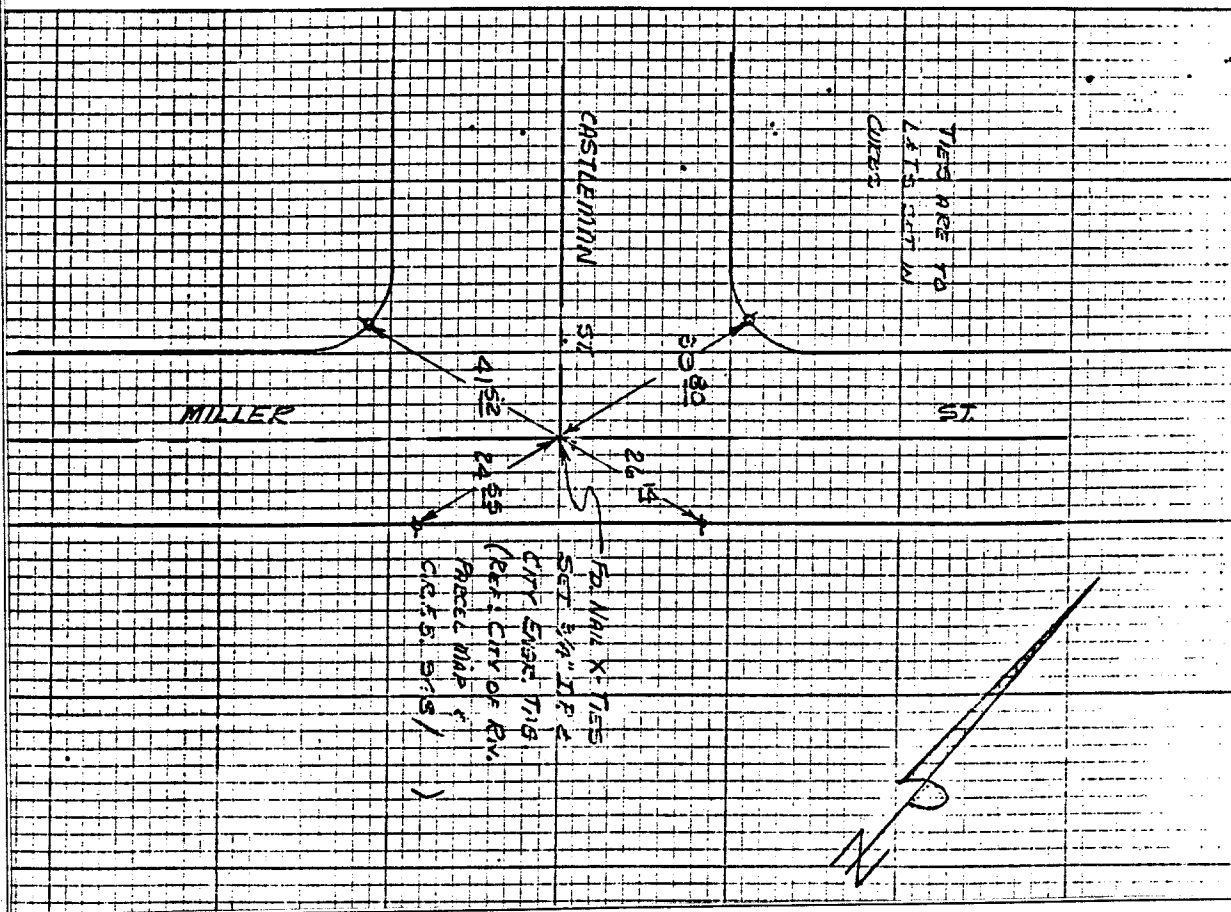

- ✕ FD. Ramset Nail on T/C
- FD. "C" Nail on T/C

- FD. LD. & TK. on T/C
- Set LD. & TK. on T/C

OFFICIAL TIE PLAT

CITY OF RIVERSIDE

These ties are for the purpose of perpetuating the found monumentation. No claim is made as to the relationship of the points or lines shown hereon to true boundary locations.

Sheet 1 of 1
File No.:

Scale:

Date:

Drawn by:

W.O.:

F.B.:

F.I.L. 8221