

13129.TIF

Street:

ALESSANDRO BLVD.

OFFICIAL USE ONLY

X-Street: BC 496' +/- TO CHICAGO

SWING TIES

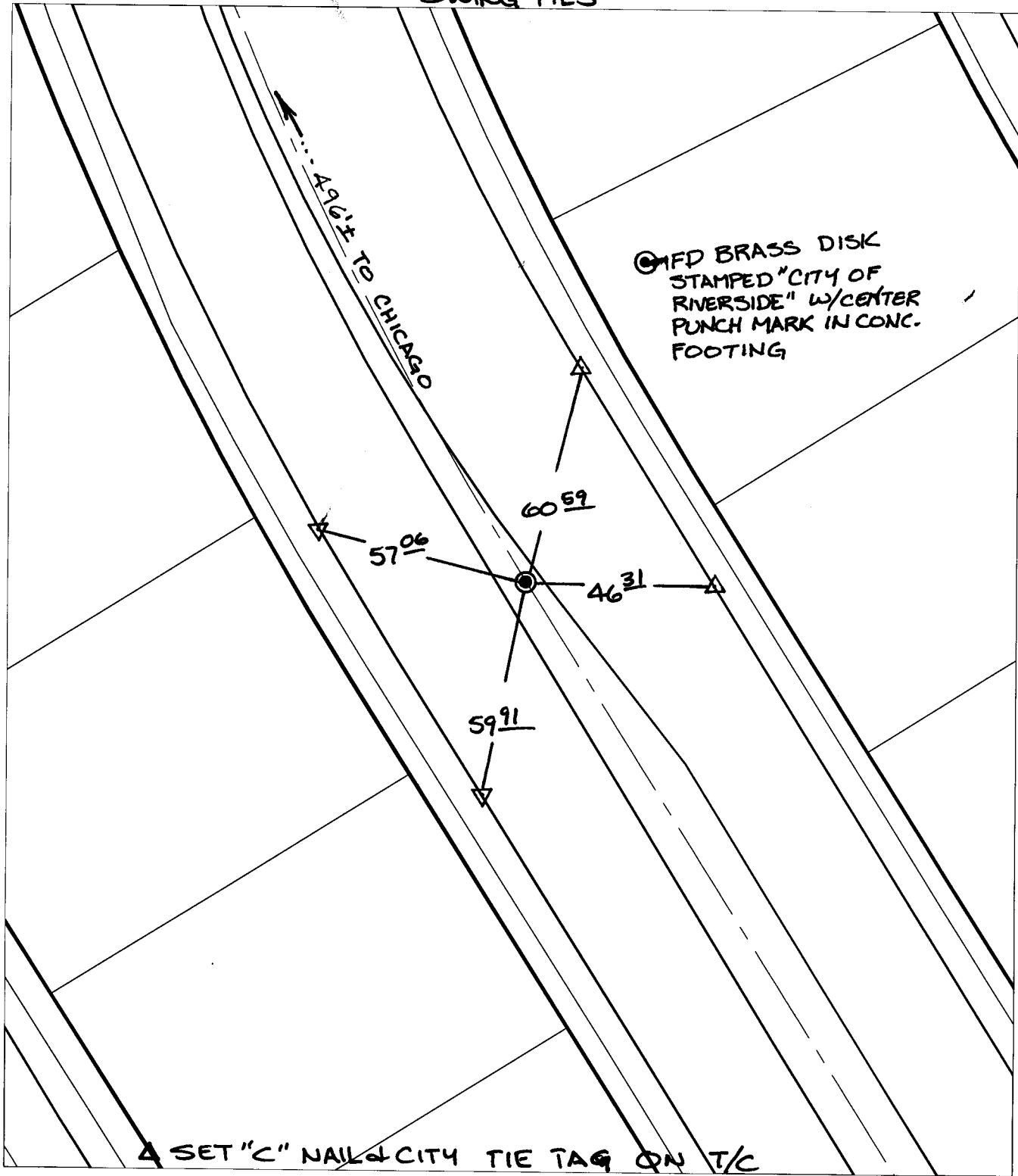

- ✕ FD. Ramset Nail on T/C      ● FD. LD. & TK. on T/C      P.K. and City Engineer tag to be set @ surface after street construction is complete. (if possible)
- FD. "C" Nail on T/C      ○ Set LD. & TK. on T/C

Scale: 1" = 40'  
 Date: 02/09/07  
 Drawn by: pw  
 F.B.:  
 TR-Sec: T3SR5W-1

## OFFICIAL TIE PLAT

### CITY OF RIVERSIDE

*These ties are for the purpose of perpetuating the found monumentation. No claim is made as to the relationship of the points or lines shown hereon to true boundary locations.*



Sheet 1 of 1  
 Cadme MB: 55-6