

13494.T1E

STREET: MAIN STREET

OFFICIAL USE ONLY

X-STREET: UNIVERSITY AVENUE

MAIN STREET REVITALIZATION

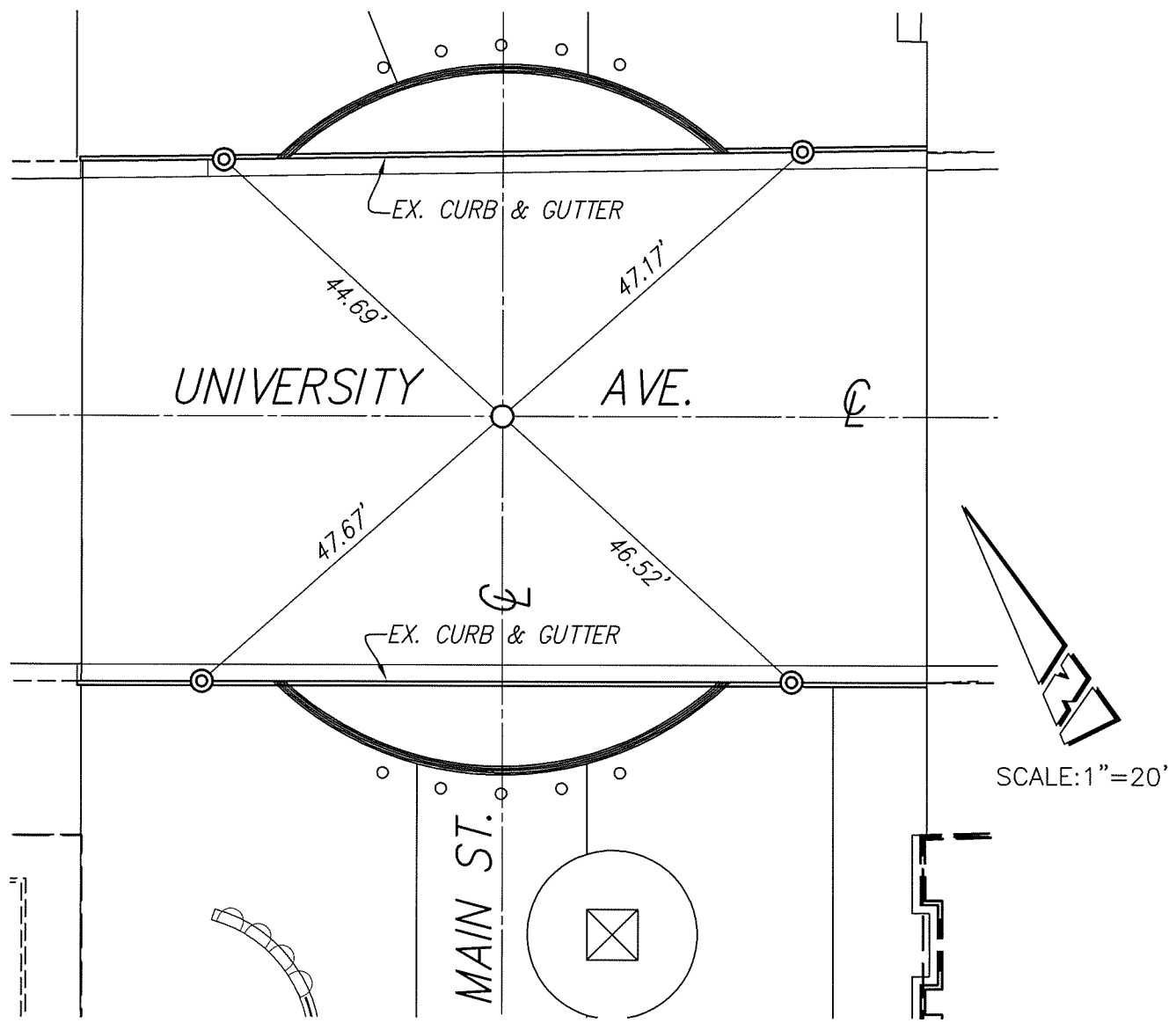

LEGEND

- -INDICATES SET NAIL AND LS 7663 TAG FLUSH IN BRICK PAVEMENT C/L INTERSECTION, REPLACES FOUND 1" I.P. WITH P.P. ILL.
- ⊙ -INDICATES SET CONCRETE NAIL AND LS 7663 TAG IN T.C.

MONUMENT TIES SHOWN HEREON ARE "TRANSIT TIES"

SCALE: 1"=20'
 DATE: 03/11/10
 DRAWN BY: JB
 F.B.:
 TR-SEC: T.2S,R.5W-23

OFFICIAL TIE PLAT

CITY OF RIVERSIDE

THESE TIES ARE FOR THE PURPOSE OF PERPETUATING THE FOUND MONUMENTATION. NO CLAIM IS MADE AS TO THE RELATIONSHIP OF THE POINTS OR LINES SHOWN HEREON TO TRUE BOUNDARY LOCATIONS

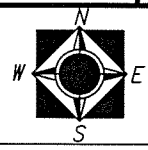

SHEET 1 OF 1