

SWING TIES

HISTORICAL DATA

F.B. V1/61
2478.TIF
PLAN R-426

13868.TIF

STREET: ALESSANDRO BLVD.

OFFICIAL USE ONLY

X-STREET: BC & EC N'LY ROYAL HILL

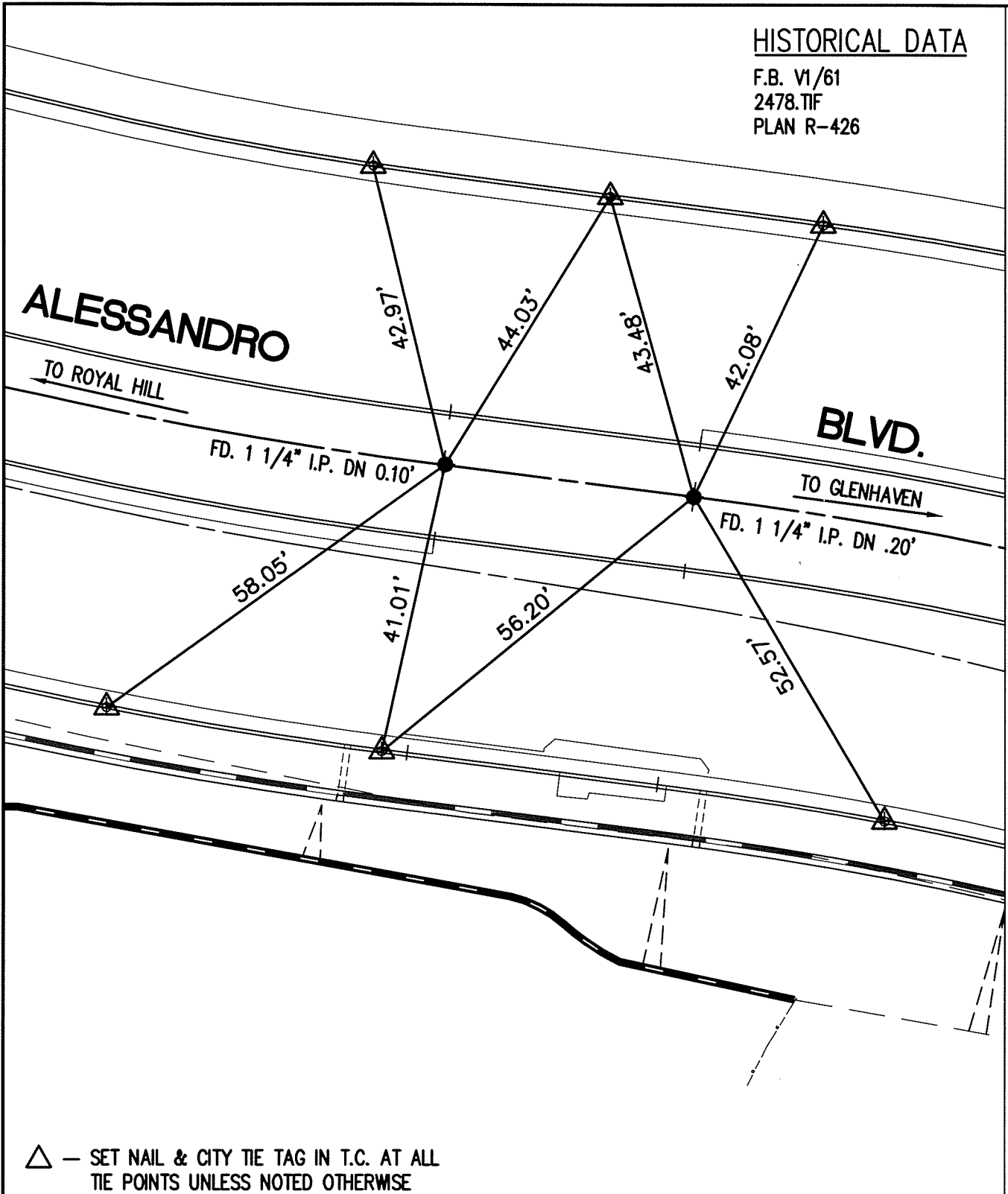

△ — SET NAIL & CITY TIE TAG IN T.C. AT ALL TIE POINTS UNLESS NOTED OTHERWISE

SCALE: 1"=20'
DATE: 2/2011
DRAWN BY: B DURENTE
F.B.: SEE HISTORICAL DATA
SEC: T.2 S., R.5 W

OFFICIAL TIE PLAT CITY OF RIVERSIDE

THESE TIES ARE FOR THE PURPOSE OF PERPETUATING THE FOUND MONUMENTATION. NO CLAIM IS MADE AS THE RELATIONSHIP OF THE POINTS OR LINES SHOWN HEREON TO TRUE BOUNDARY LOCATIONS

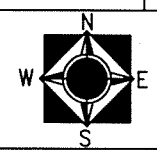

SHEET 1 OF 1