

13884.TIF

STREET: LA SIERRA AVENUE

OFFICIAL USE ONLY

X-STREET: WHITFORD AVENUE

WHITFORD AVENUE

# SWING TIES

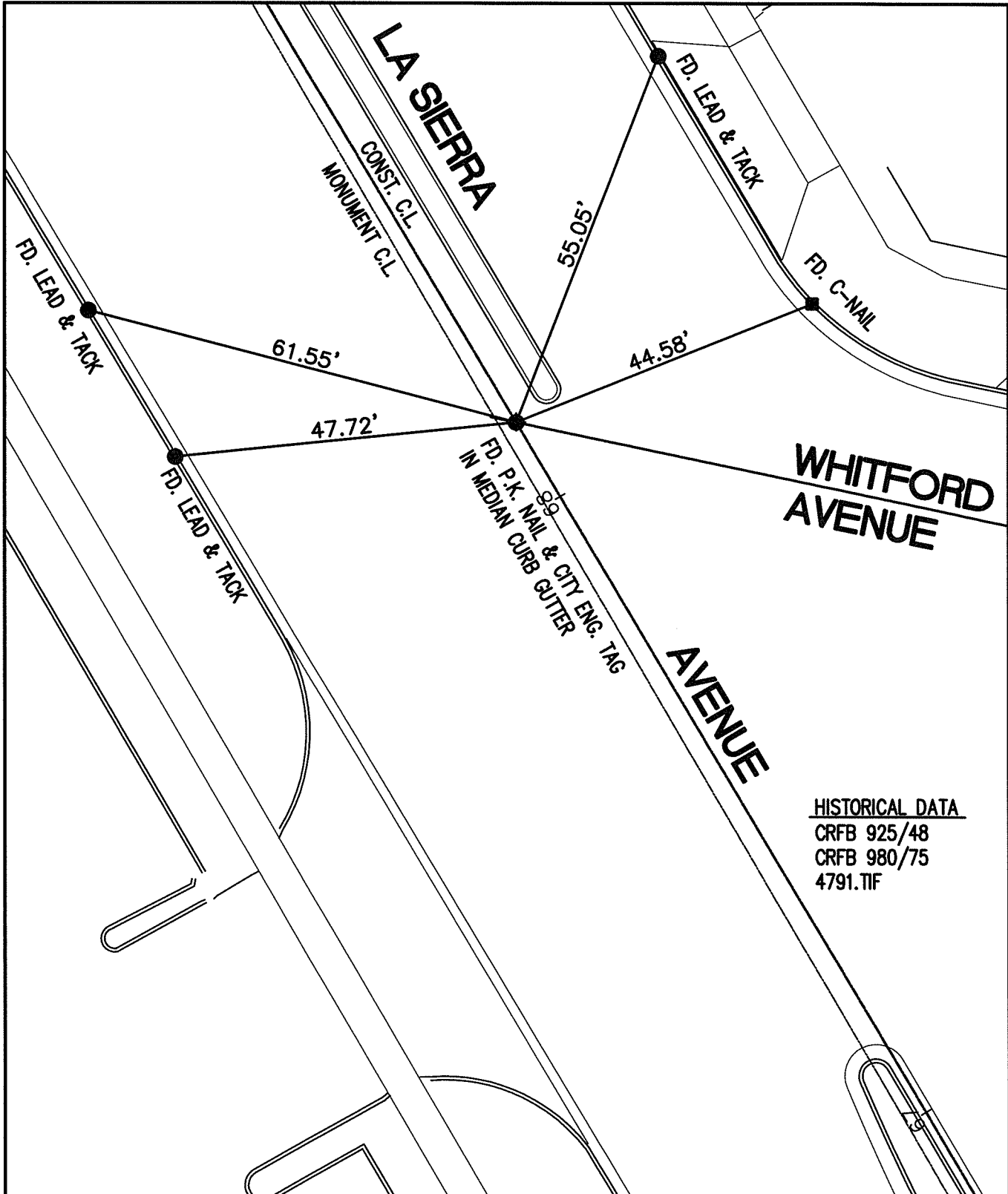

HISTORICAL DATA  
 CRFB 925/48  
 CRFB 980/75  
 4791.TIF

SCALE: 1"=20'  
 DATE: 03/08/2011  
 DRAWN BY: B DURENTE  
 F.B.: SEE HISTORICAL DATA  
 SEC: 11 T. 3 S., R. 6 W

## OFFICIAL TIE PLAT CITY OF RIVERSIDE

THESE TIES ARE FOR THE PURPOSE OF PERPETUATING THE FOUND MONUMENTATION. NO CLAIM IS MADE AS THE RELATIONSHIP OF THE POINTS OR LINES SHOWN HEREON TO TRUE BOUNDARY LOCATIONS

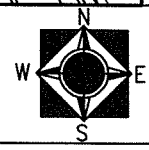

SHEET 1 OF 1