

1928.107

MONS TIES ON CLEVELAND AVE.
FROM STEWARD TO MCALLISTER

11-6-61

See R15 13/21 (file
NO. 5123) old 2x2 Fd
- RESET WITH BRONZE
DISC IN 2" I.P. SET
IN CONC. SHAW
RE # 1229 =
ALBERT WEBB X

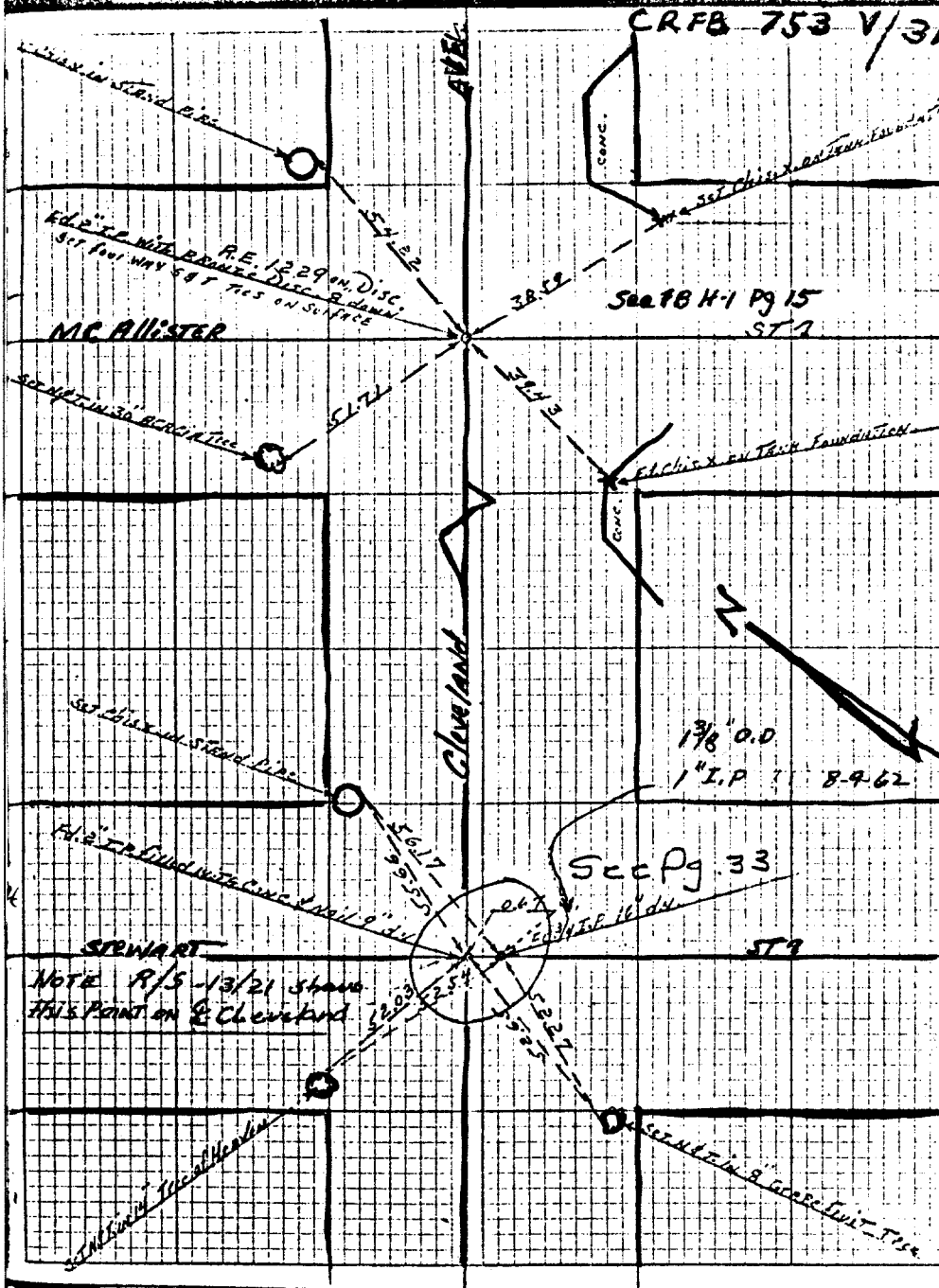

NOTE - 1" I.P. SET
BY E.W.T APR 15TH
1925
PER J.F. DAVIDSON
SURVEY
F.B. 227 PG 26
SHAW
SEE ALSO J.F.D.
F.B. 230 PG 14,
348 PG 15
F.B. 287 PG. 44
SHAW
SPIKE SET PER
GAGE CANAL
BK 1 PG 19

Street: **CLEVELAND AVE.**
 X-Street: **B/T STEWARD & MCALLISTER**
 OFFICIAL USE ONLY

- X FD. Ramset Nail on T/C
- FD. LD. & TK. on T/C
- FD. "C" Nail on T/C
- Set LD. & TK. on T/C

OFFICIAL TIE PLAT

CITY OF RIVERSIDE

These ties are for the purpose of perpetuating the found
monumentation. No claim is made as to the relationship of
the points or lines shown hereon to true boundary locations.

Scale:
Date:
Drawn by:
W.O.:
F.B.:

Sheet 1 of 1
File No.: