

SWING TIES

REF: 4371.TIF

13993.TIF

STREET: DEWEY AVENUE

OFFICIAL USE ONLY

X-STREET: PALM AVENUE

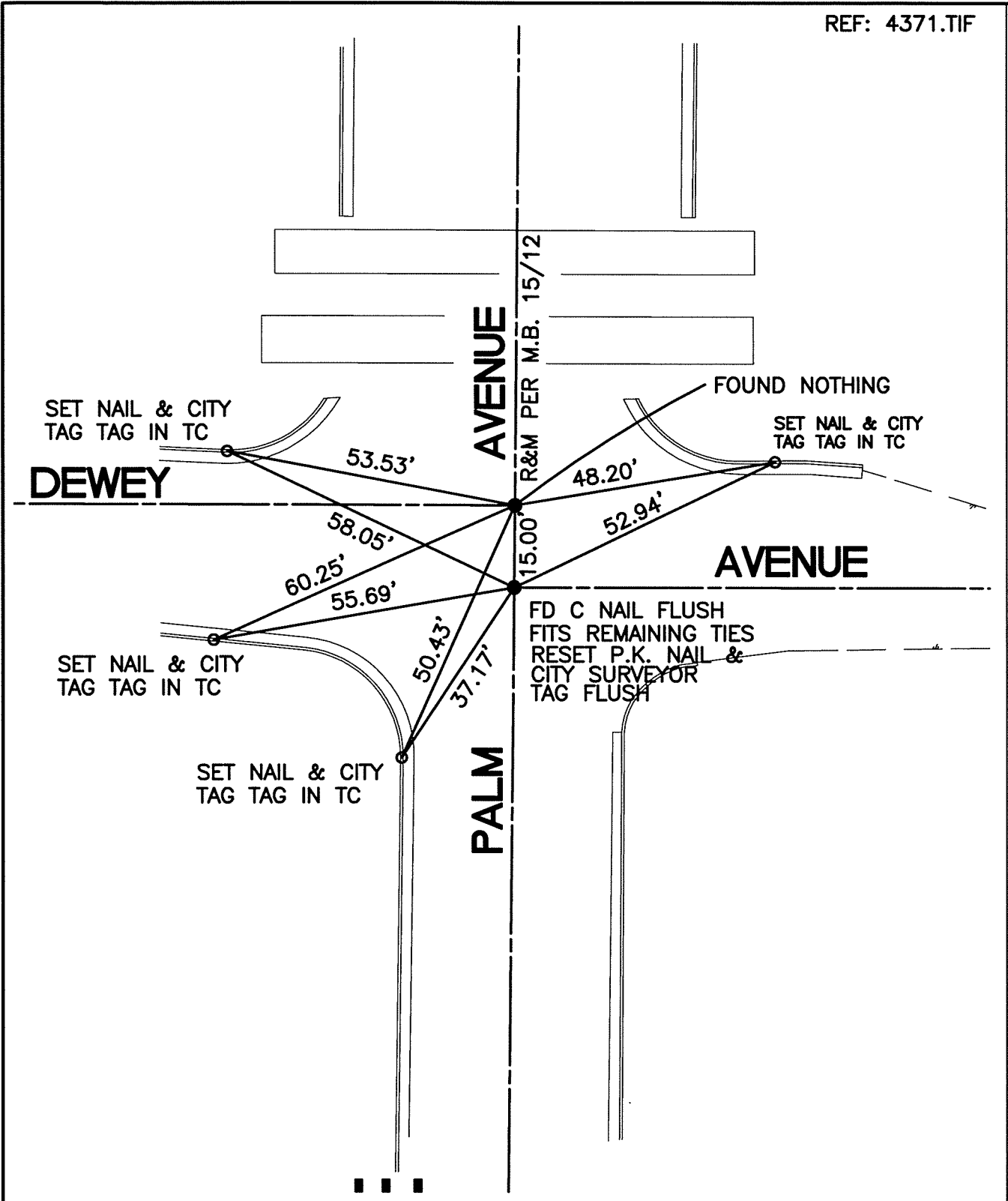

SCALE: 1"=30'
DATE: 7/05/12
DRAWN BY: CURT
F.B.:
SEC: 33 & 34 T2 S.,R.5W

OFFICIAL TIE PLAT
CITY OF RIVERSIDE

THESE TIES ARE FOR THE PURPOSE OF PERPETUATING THE FOUND MONUMENTATION. NO CLAIM IS MADE AS THE RELATIONSHIP OF THE POINTS OR LINES SHOWN HEREON TO TRUE BOUNDARY LOCATIONS

SHEET 1 OF 1