

SWING TIES

REF: 5627.TIF
CRFB779/76

13999.TIF

STREET: MADISON STREET

OFFICIAL USE ONLY

X-STREET: ORCHARD STREET

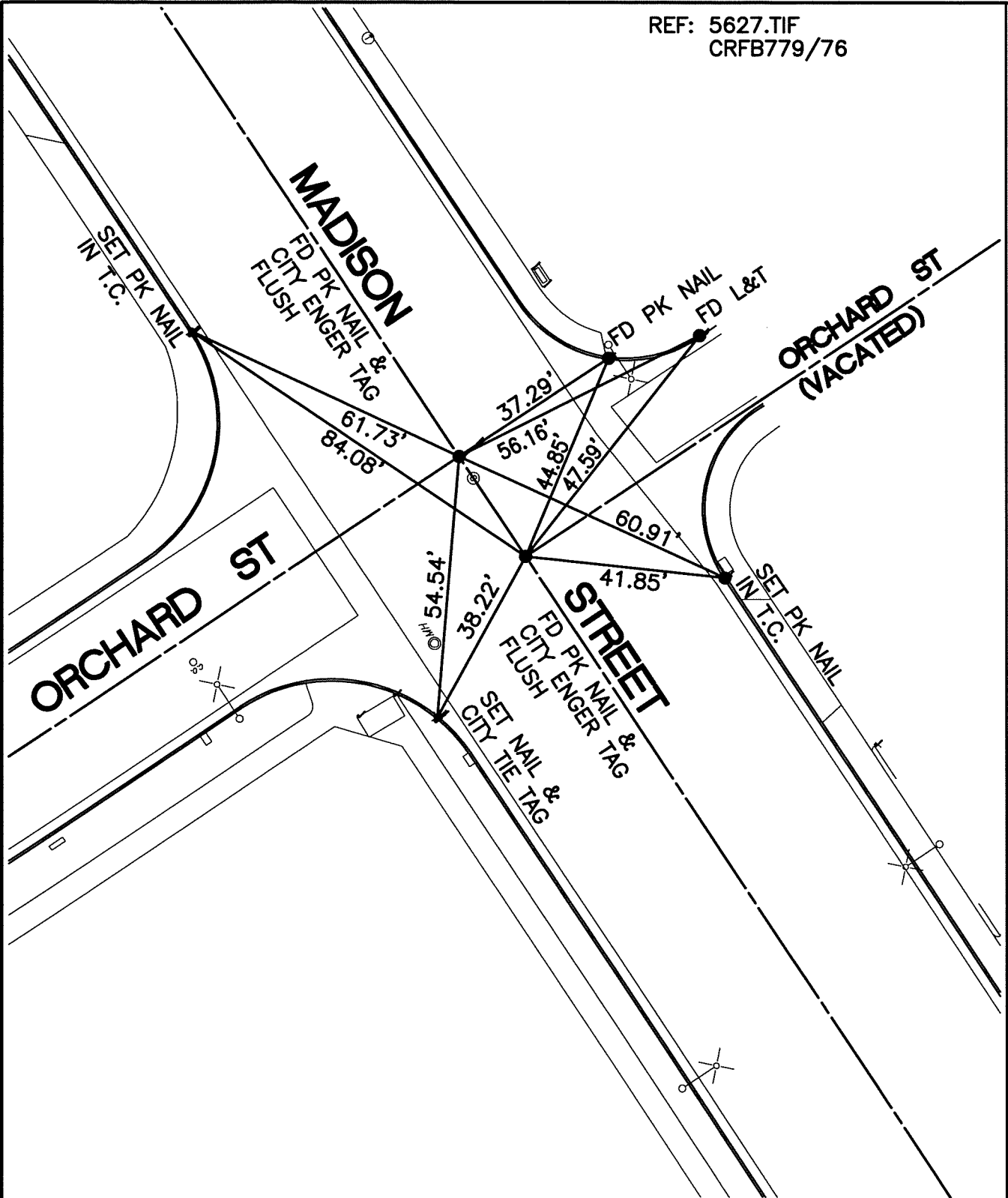

SCALE: 1"=30'
DATE: 7/05/12
DRAWN BY: CURT
F.B.:
SEC: 4 T.3S.,R.5W

OFFICIAL TIE PLAT
CITY OF RIVERSIDE

THESE TIES ARE FOR THE PURPOSE OF PERPETUATING THE FOUND MONUMENTATION. NO CLAIM IS MADE AS THE RELATIONSHIP OF THE POINTS OR LINES SHOWN HEREON TO TRUE BOUNDARY LOCATIONS

SHEET 1 OF 1