

1427.111



J.F. Davidson Associates, Inc.  
ENGINEERING PLANNING SURVEYING  
ARCHITECTURE LANDSCAPE ARCHITECTURE

FB 10491/75

SURVEY OF FINAL MONS & TIES **SHEET 3 OF 3**  
FOR VAN DAELE TR 2163B-5 W.O. No. 10491 Date 8-21-92  
SURVEY PARTY IBARRA PUEBLE REF. \_\_\_\_\_ A.M. \_\_\_\_\_

COLE AVE

SURVEY NOTES

- Denotes FD 2/5 NAIL IN T/C
- " SET 1" I.P. W. P.P. LS. 3018 FLUSH
- ▲ " FD. NAIL TO LS. 3018 R. END W/T/C

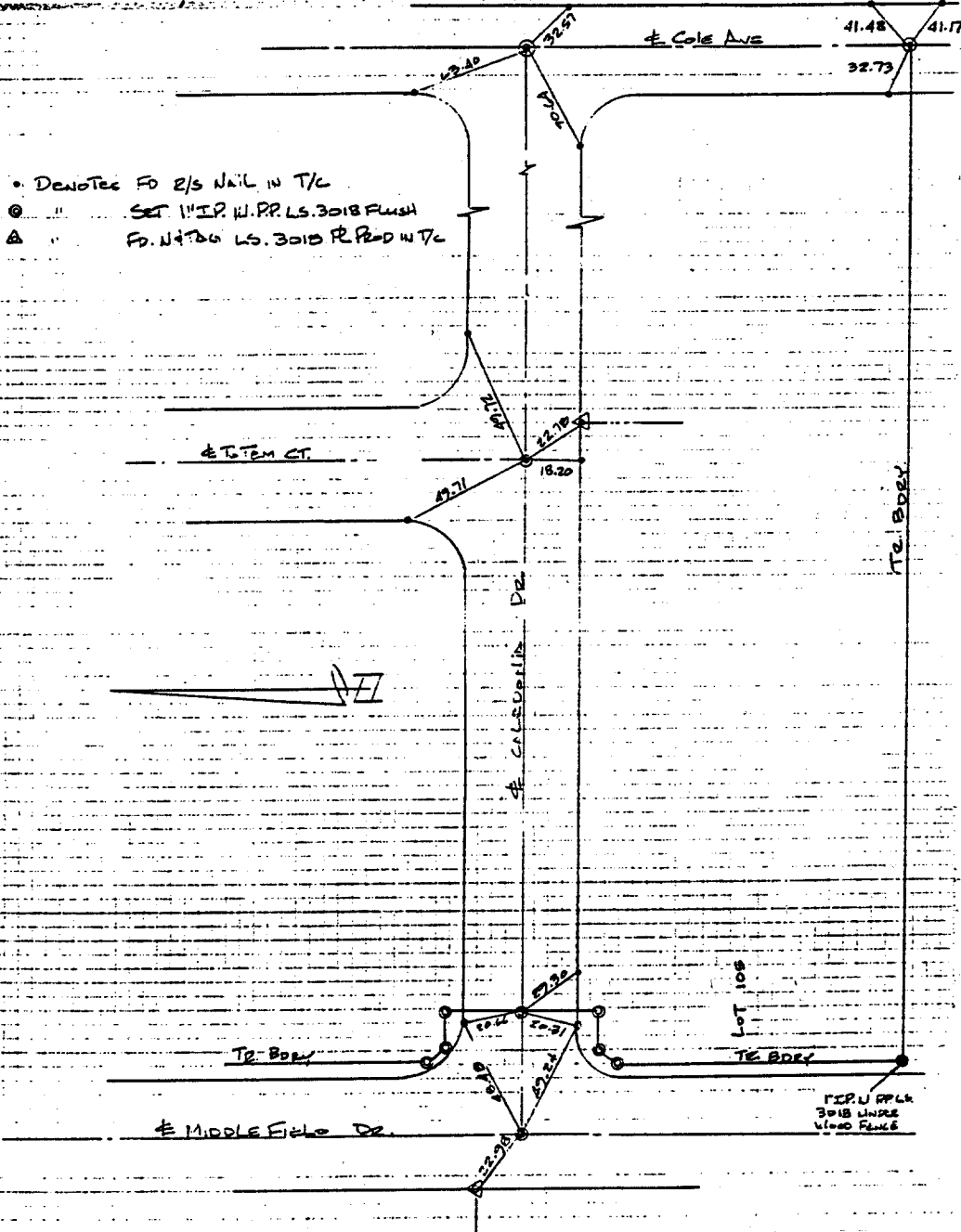

Street: COLE AVE  
X-Street: \_\_\_\_\_  
OFFICIAL USE ONLY

- ✕ FD. Ramset Nail on T/C
- FD. LD. & TK. on T/C
- FD. "C" Nail on T/C
- Set LD. & TK. on T/C

Scale: \_\_\_\_\_  
 Date: \_\_\_\_\_  
 Drawn by: \_\_\_\_\_  
 W.O.: \_\_\_\_\_  
 F.B.: \_\_\_\_\_

**OFFICIAL TIE PLAT**  
**CITY OF RIVERSIDE**

*These ties are for the purpose of perpetuating the found monumentation. No claim is made as to the relationship of the points or lines shown hereon to true boundary locations.*

Sheet **3** of **3**  
 File No.: \_\_\_\_\_