

# SWING TIES

REF: (XX.XX) INDICATES RECORD DISTANCE PER 13720.TIF  
5065.TIF

14276.TIF

STREET: COLE AVENUE

OFFICIAL USE ONLY

X-STREET: KRAMERIA AVENUE

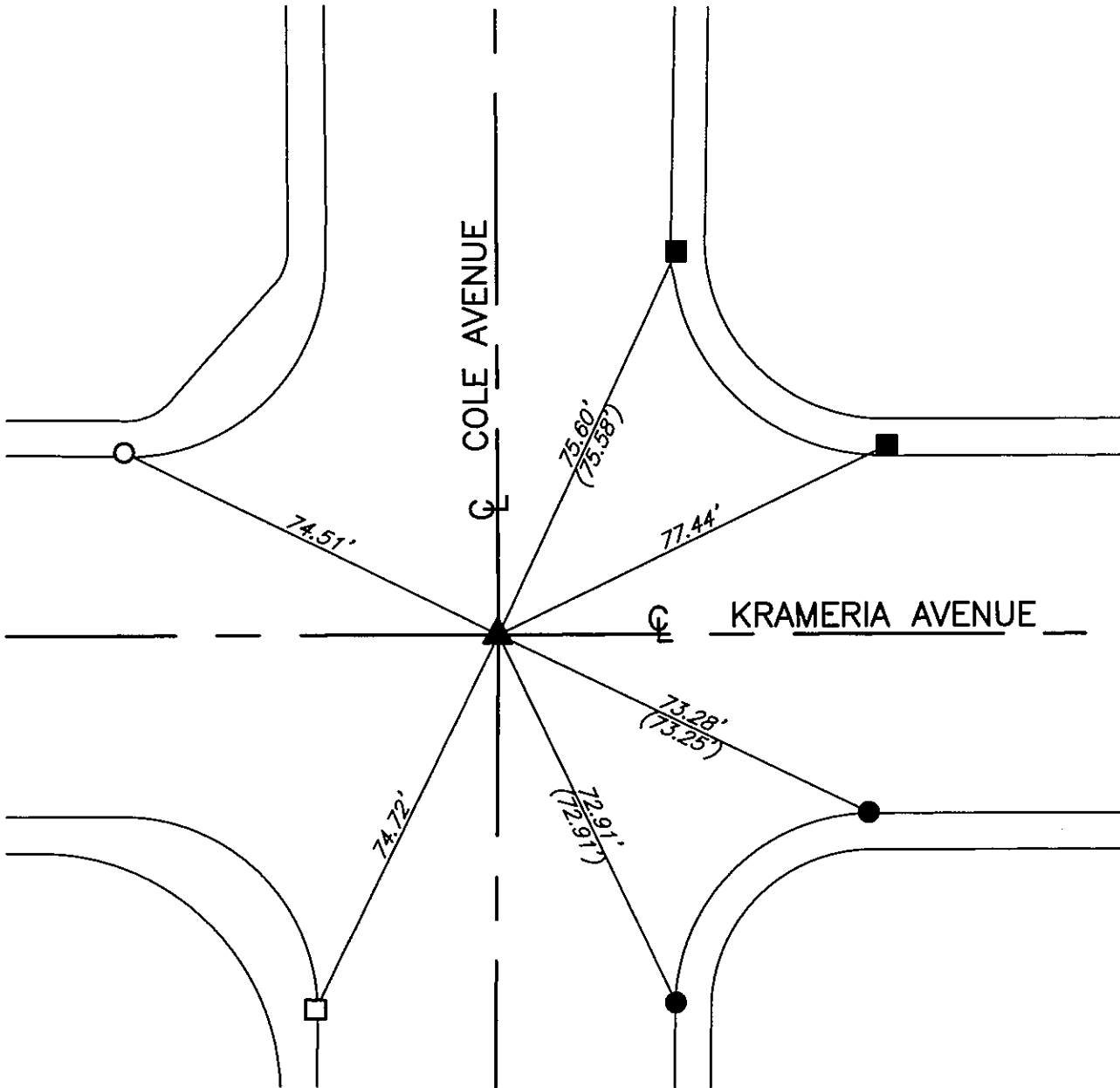

- - SET NAIL & CITY TIE TAG IN T.C.
- - SET PK NAIL IN TC
- - FOUND LEAD & TACK IN T.C.
- - FOUND RAMSET NAIL IN T.C.
- ▲ - FOUND SPIKE AND WASHER, STAMPED 'LS 5928'

SCALE: 1"=30'
DATE: 12/3/14
DRAWN BY: JDF
F.B.:
SEC: T.3S., R.4W SEC. 29

## OFFICIAL TIE PLAT CITY OF RIVERSIDE

THESE TIES ARE FOR THE PURPOSE OF PERPETUATING THE FOUND MONUMENTATION. NO CLAIM IS MADE AS THE RELATIONSHIP OF THE POINTS OR LINES SHOWN HEREON TO TRUE BOUNDARY LOCATIONS

