

Street: CALIFORNIA AVE.

X-Street: SEQUOIA ST.

OFFICIAL USE ONLY

HISTORICAL DATA		SWING TIES		SEQUOIA STREET AT CALIFORNIA AVE	
				CREW: STEELE EWING NEW	
				MAY 18, 1950	
				CREW 542/B	

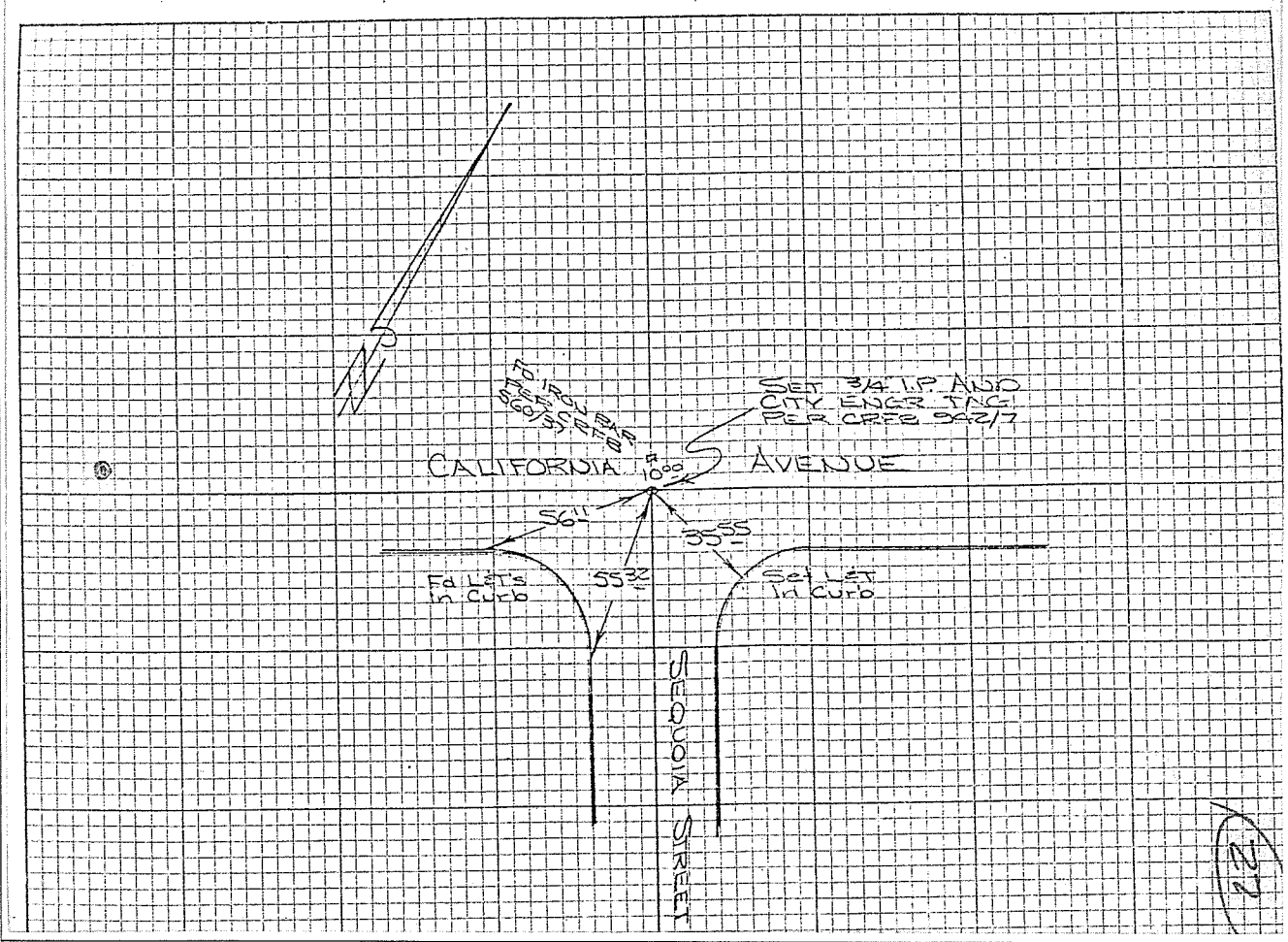

- ✕ FD. Ramset Nail on T/C
- FD. LD. & TK. on T/C
- FD. "C" Nail on T/C
- Set LD. & TK. on T/C
- P.K. and City Engineer tag to be set @ surface after street construction is complete. (If possible)

Scale: .
 Date: .
 Drawn by: .
 F.B.: .
 TR-

OFFICIAL TIE PLAT

CITY OF RIVERSIDE

These ties are for the purpose of perpetuating the found monumentation. No claim is made as to the relationship of the points or lines shown hereon to true boundary locations.

