

14302 TIF

Street: CENTRAL AVE.

X-Street: CAPISTRANO WY.

OFFICIAL USE ONLY

F.B. 926-45

Central Ave
Construction & Angle point
West of Capistrano

Hunt
Thorp
Russell
Nov. 12, 1970

Transit Ties

Historical Data
Plan # R-1168
This F.B. Pg. 40
F.B. 714-51

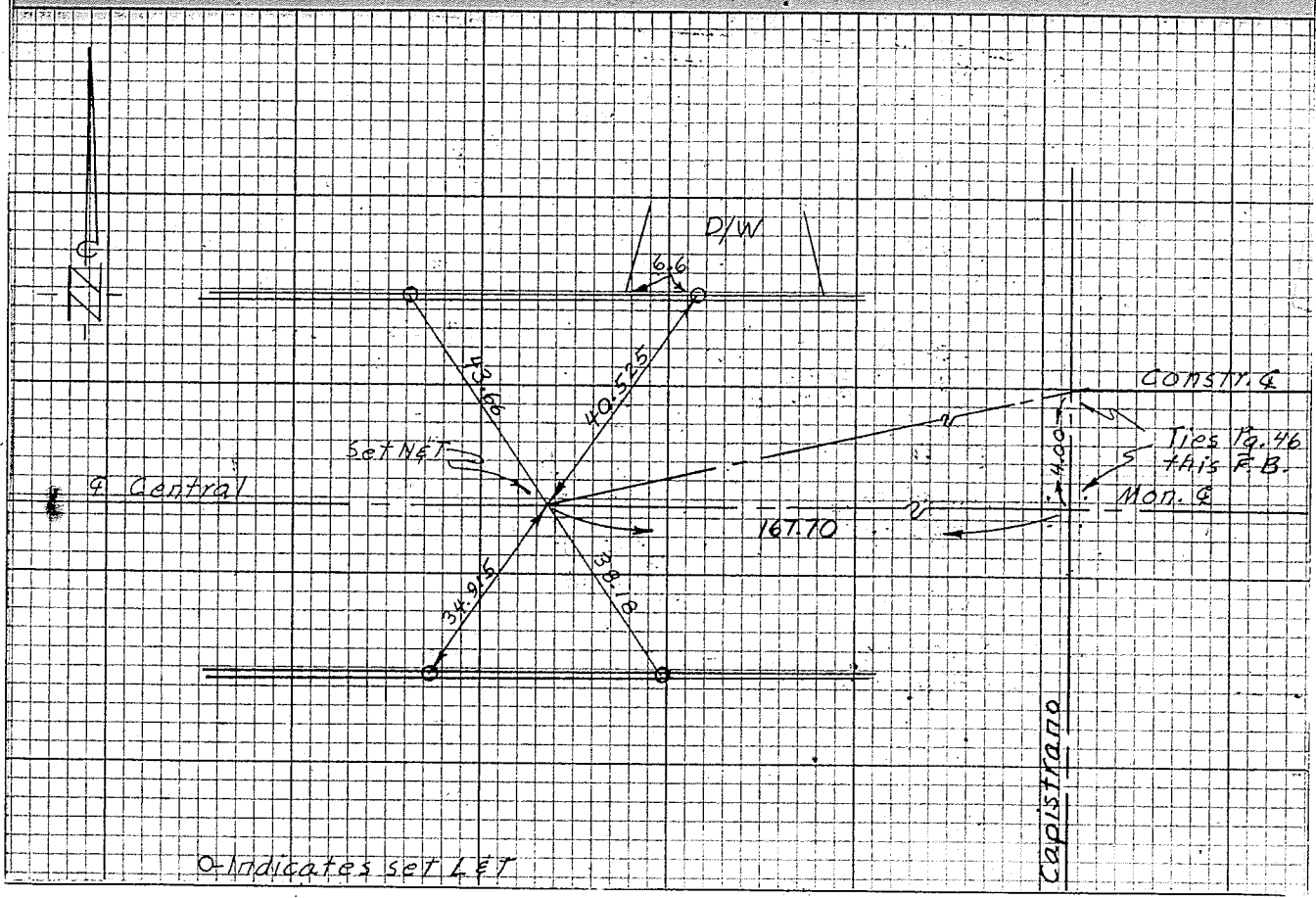

O indicates set LD. & TK.

- × FD. Ramset Nail on T/C
- FD. LD. & TK. on T/C
- FD. "C" Nail on T/C
- Set LD. & TK. on T/C

Scale:
Date:
Drawn by:
W.O.:
F.B.:

OFFICIAL TIE PLAT

CITY OF RIVERSIDE

These ties are for the purpose of perpetuating the found monumentation. No claim is made as to the relationship of the points or lines shown hereon to true boundary locations.

Sheet 1 of 1
File No.: