

SWING TIES

14441.71E

STREET: JURUPA AVENUE

OFFICIAL USE ONLY

X-STREET:

TOWER ROAD

- HISTORICAL DATA
- 12075.TIF
 - 7813.TIF
 - 7812.TIF
 - CRFB 539/31

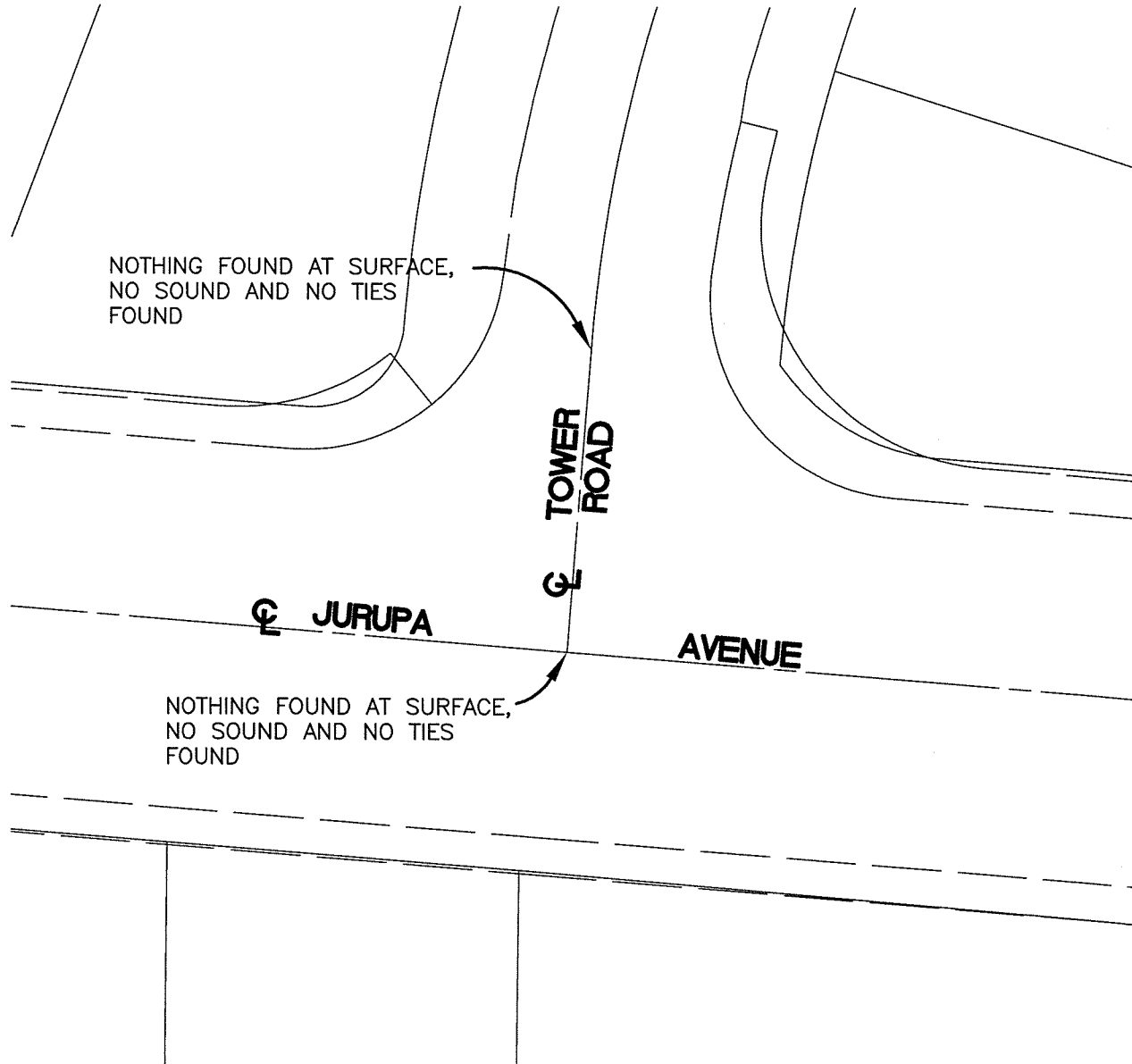

NOTHING FOUND AT SURFACE,
NO SOUND AND NO TIES
FOUND

TOWER
ROAD

JURUPA

AVENUE

NOTHING FOUND AT SURFACE,
NO SOUND AND NO TIES
FOUND

SCALE:	1" = 30'
DATE:	MAY 16, 2016
DRAWN BY:	JDF
F.B.:	
SEC:	28 T.2S., R.5W

OFFICIAL TIE PLAT CITY OF RIVERSIDE

THESE TIES ARE FOR THE PURPOSE OF PERPETUATING THE FOUND MONUMENTATION. NO CLAIM IS MADE AS THE RELATIONSHIP OF THE POINTS OR LINES SHOWN HEREON TO TRUE BOUNDARY LOCATIONS

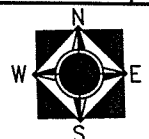

SHEET 1 OF 1