

14540.TIF

Street: MAGNOLIA AVE.

X-Street: LA SIERRA AVE

OFFICIAL USE ONLY

THORN
MONTAGUE
CONNER

DISTANCES MEASURED BY:
STEVE LEWING-ALLEN
APRIL 7, 1975

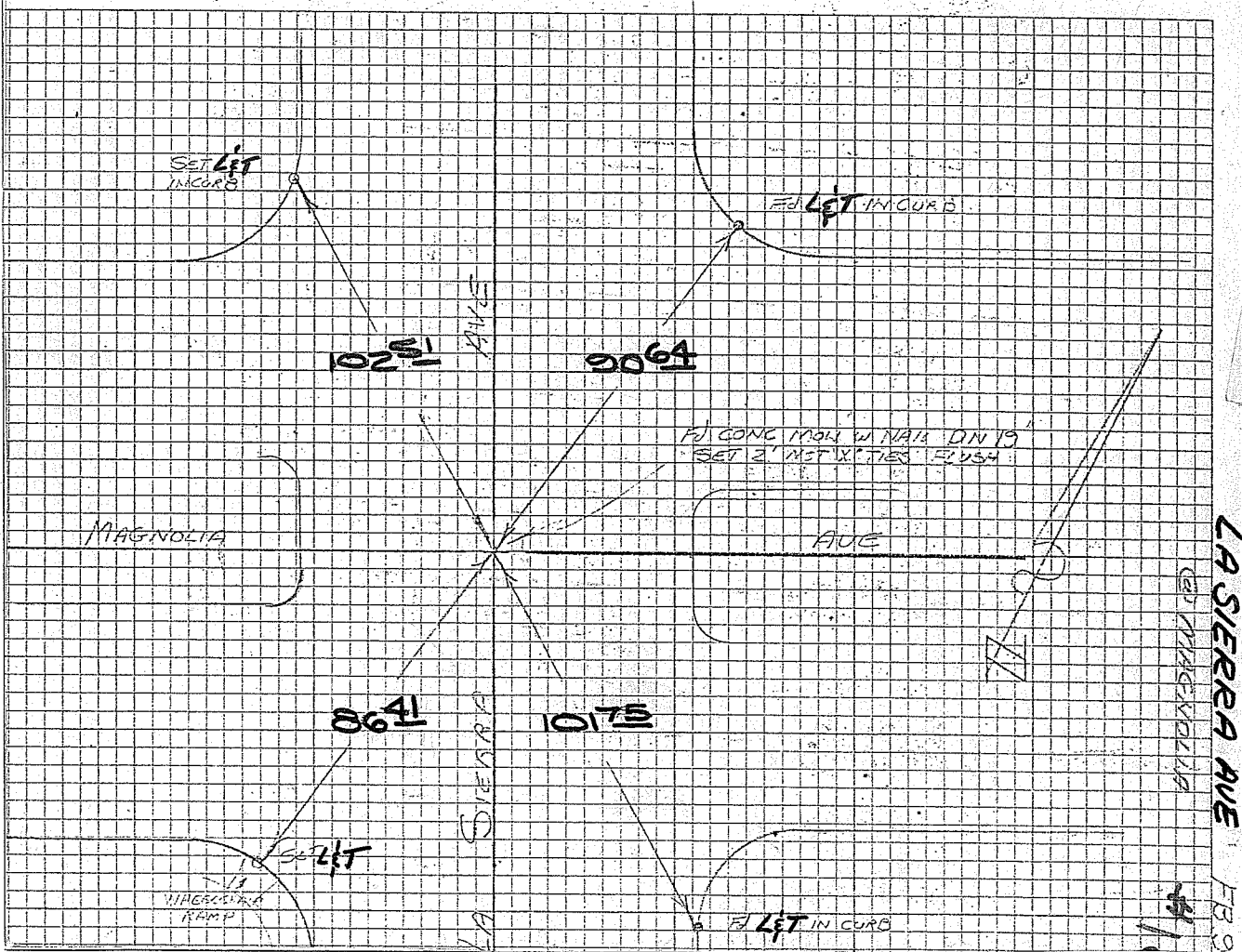

- × FD. Ramset Nail on T/C
- FD. "C" Nail on T/C

- FD. LD. & TK. on T/C
- Set LD. & TK. on T/C

OFFICIAL TIE PLAT

CITY OF RIVERSIDE

These ties are for the purpose of perpetuating the found monumentation. No claim is made as to the relationship of the points or lines shown hereon to true boundary locations.

Scale:
Date:
Drawn by:
W.O.:
F.B.:

Sheet 1 of 1
File No.: