

14559.TIE

Street: HAWARDEEN DR.

X-Street: MARY ST.

OFFICIAL USE ONLY

6-23-66
ARREOLA
SIMPSON
MAHSFIELD

F.B. 717

SWING TIES

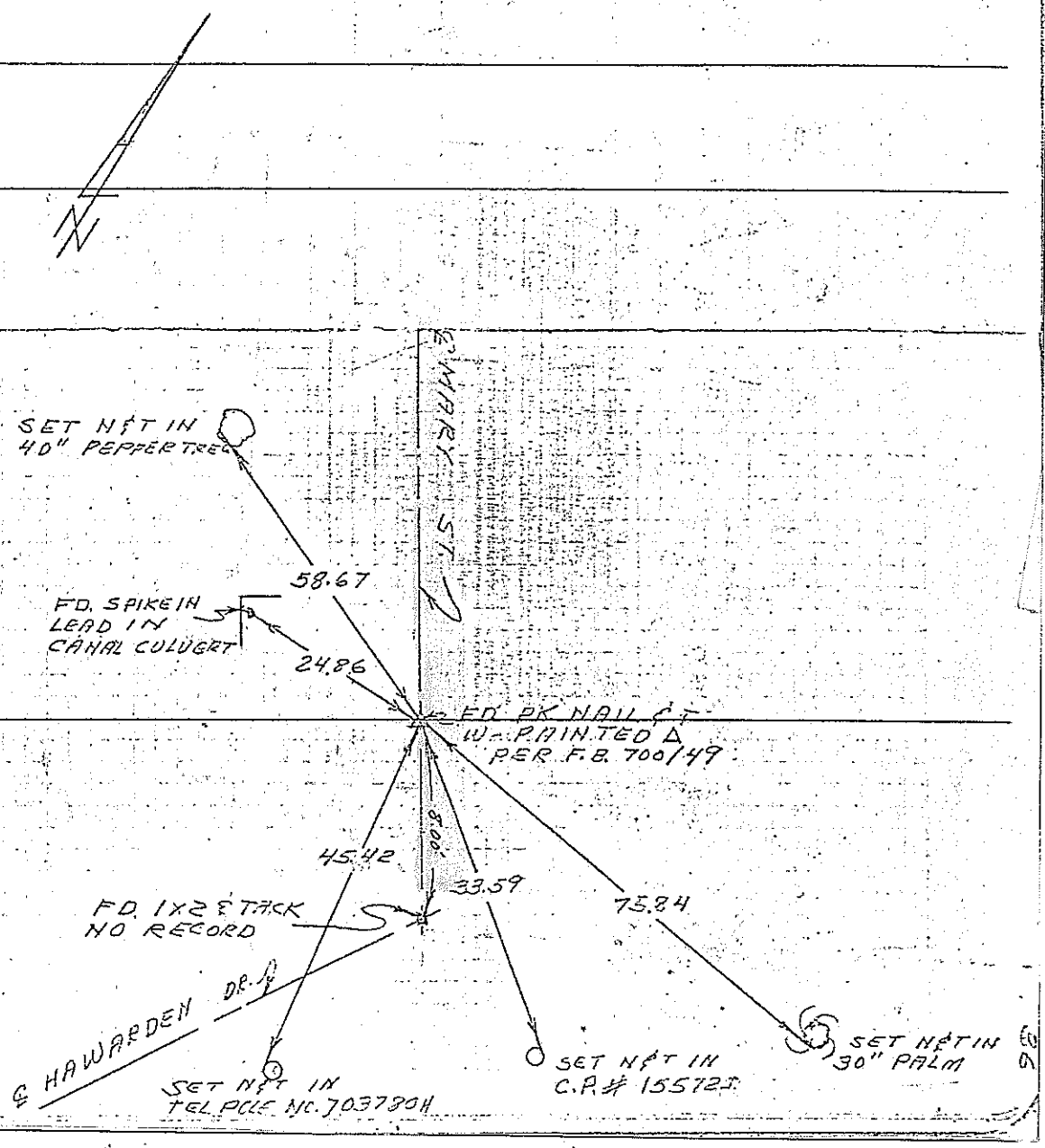

- ✕ FD. Ramset Nail on T/C
- FD. LD. & TK. on T/C
- FD. "C" Nail on T/C
- Set LD. & TK. on T/C

Scale:
Date:
Drawn by:
W.O.:
F.B.:

OFFICIAL TIE PLAT
CITY OF RIVERSIDE

These ties are for the purpose of perpetuating the found monumentation. No claim is made as to the relationship of the points or lines shown hereon to true boundary locations.

Sheet 1 of 1
File No.: