

SWING TIES

REF: (XX.XX) INDICATES RECORD DISTANCE PER 7842.TIF

14839.TIF

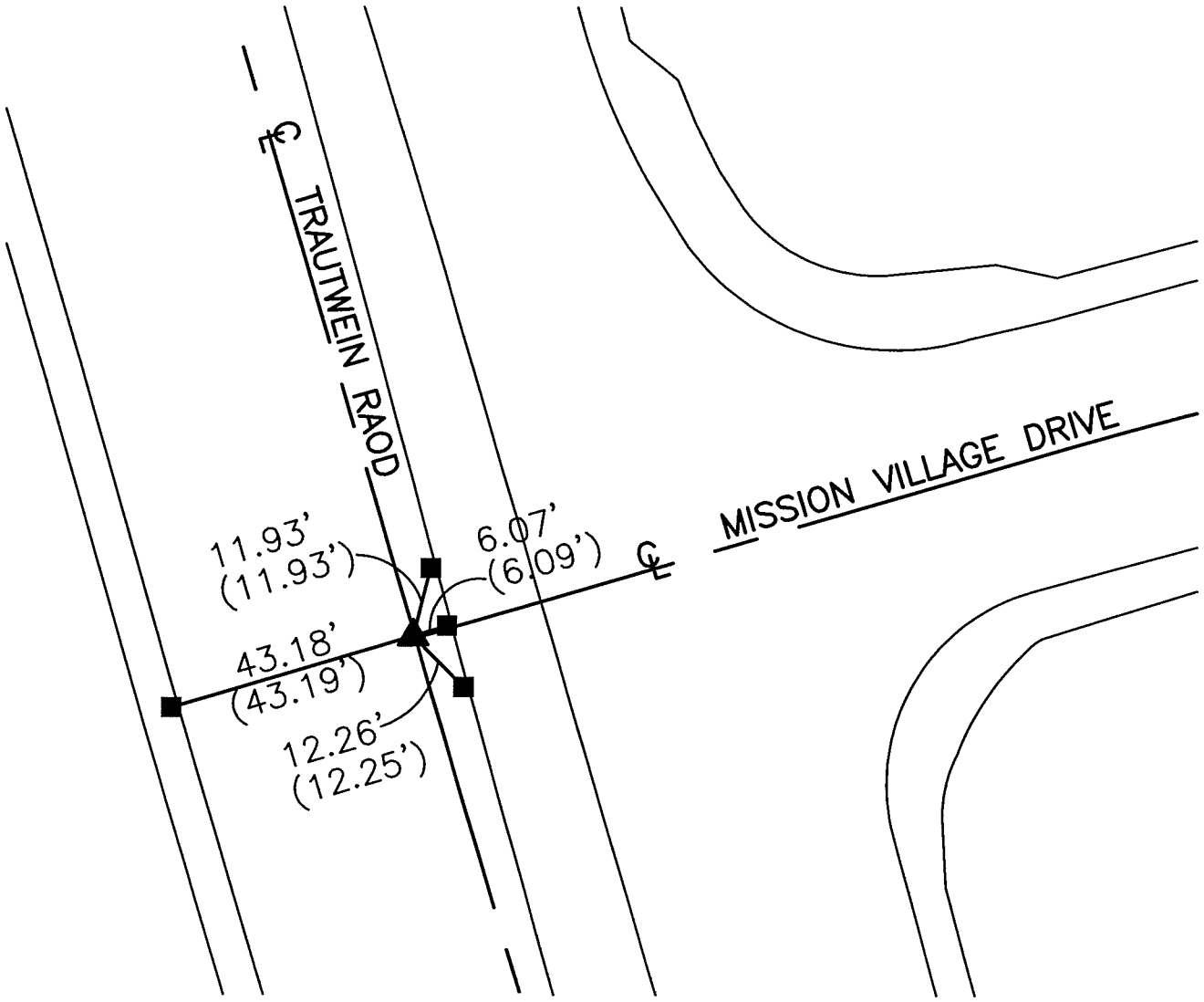

STREET: TRAUTWEIN ROAD

OFFICIAL USE ONLY

X-STREET: MISSION VILLAGE DRIVE

- - SET PK NAIL IN TC
- - FOUND RAMSET NAIL IN T.C.
- ▲ - FOUND 1" I.P., WITH PLUG, ILLEGIBLE, FLUSH, SET MAG NAIL AND WASHER STAMPED "RIVERSIDE CITY SURVEYOR" AFTER CONSTRUCTION

SCALE:	1"=30'
DATE:	8/19/14
DRAWN BY:	JDF
F.B.:	
SEC:	T.3S., R.4W SEC. 17

OFFICIAL TIE PLAT CITY OF RIVERSIDE

THESE TIES ARE FOR THE PURPOSE OF PERPETUATING THE FOUND MONUMENTATION. NO CLAIM IS MADE AS THE RELATIONSHIP OF THE POINTS OR LINES SHOWN HEREON TO TRUE BOUNDARY LOCATIONS

SHEET 1 OF 1