

1626. T1F

" SWING TIES "

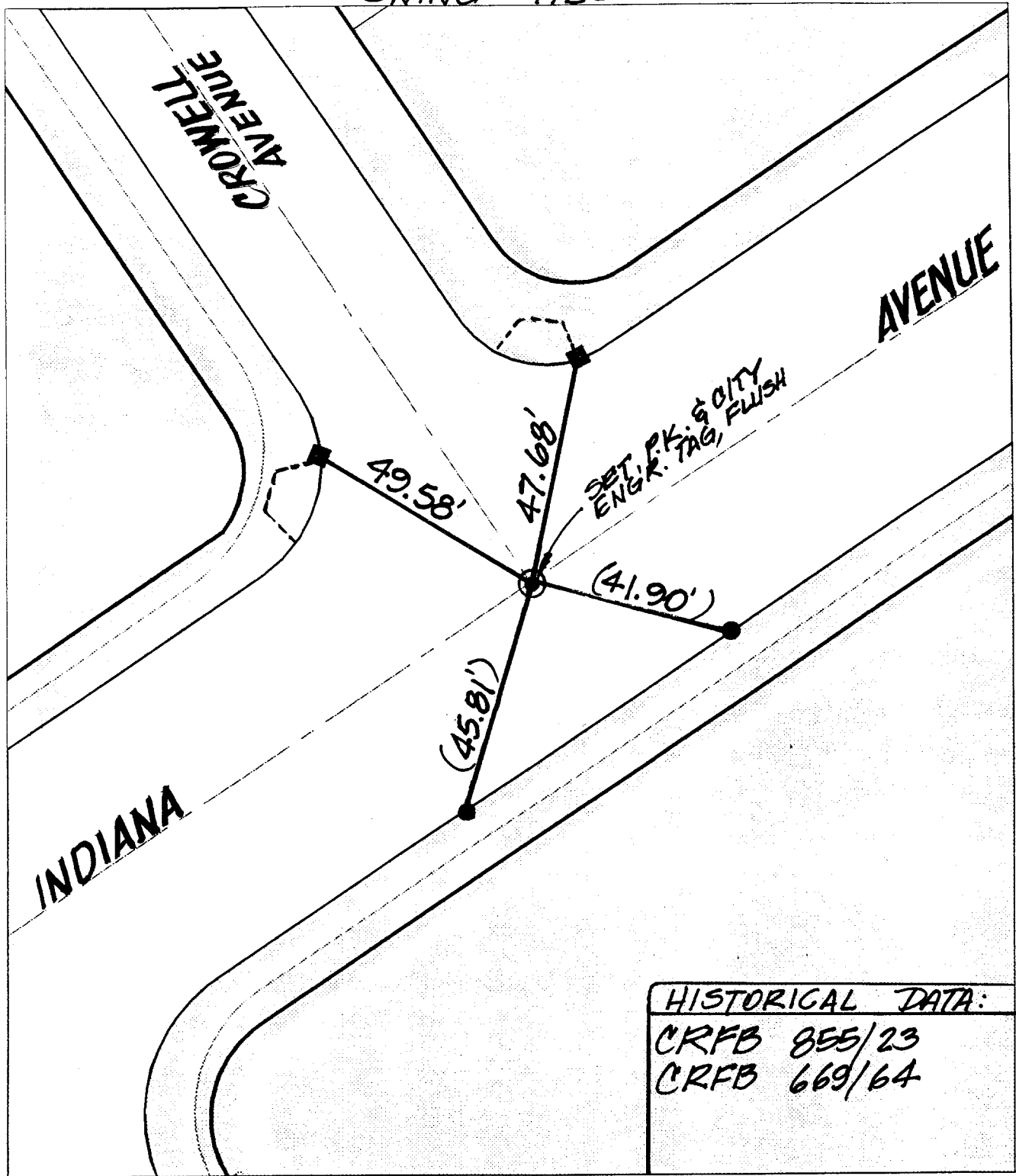

Street:

INDIANA AVE

X-Street:
OFFICIAL USE ONLY

CROWELL AVE

- × FD. Ramset Nail on T/C
- FD. LD. & TK. on T/C
- FD. "C" Nail on T/C
- Set LD. & TK. on T/C

HISTORICAL DATA:
 CRFB 855/23
 CRFB 669/64

Scale: 1" = 30'
 Date: 06/02/99
 Drawn by: fwally/KGE
 W.O.:
 F.B.:

OFFICIAL TIE PLAT

CITY OF RIVERSIDE



These ties are for the purpose of perpetuating the found monumentation. No claim is made as to the relationship of the points or lines shown hereon to true boundary locations.

Sheet 1 of 1
 File No.: