

SURVEY NOTES

- ① $\Delta 56^{\circ}41'30''$ H.D. 60.77' FD. 1 1/4" SP. NO TAG ON O.I'
R-305'18'30"
- ② $\Delta 53^{\circ}35'52''$ H.D. 107.80' FD. BEAT SPIKE & WASHER CS 4430 ON O.I'
R-306'24'14"
- ③ $\Delta 53^{\circ}21'22''$ H.D. 113.07' "
R-306'58'38"
- ④ $\Delta 53^{\circ}16'08''$ H.D. 224.64' FD. P-K NAIL FINISH
R-306'41'48"

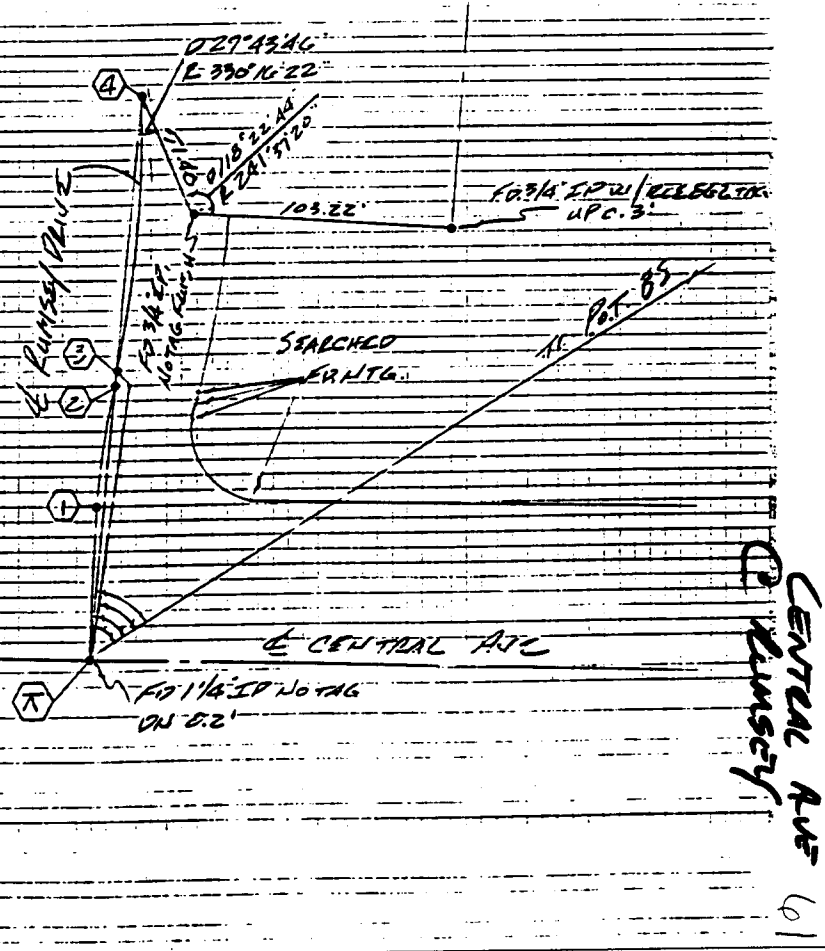

CENTRAL AVE (101)
Rumsey

- ✕ FD. Ramset Nail on T/C
- FD. LD. & TK. on T/C
- FD. "C" Nail on T/C
- Set LD. & TK. on T/C

Scale:
Date:
Drawn by:
W.O.:
F.B.:

OFFICIAL TIE PLAT
CITY OF RIVERSIDE

These ties are for the purpose of perpetuating the found monumentation. No claim is made as to the relationship of the points or lines shown hereon to true boundary locations.

Sheet 1 of 1
File No.: