

2003. TIF

SWING TIE

Street:

CLEVELAND AVE

X-Street:
OFFICIAL USE ONLY

JOHN ST

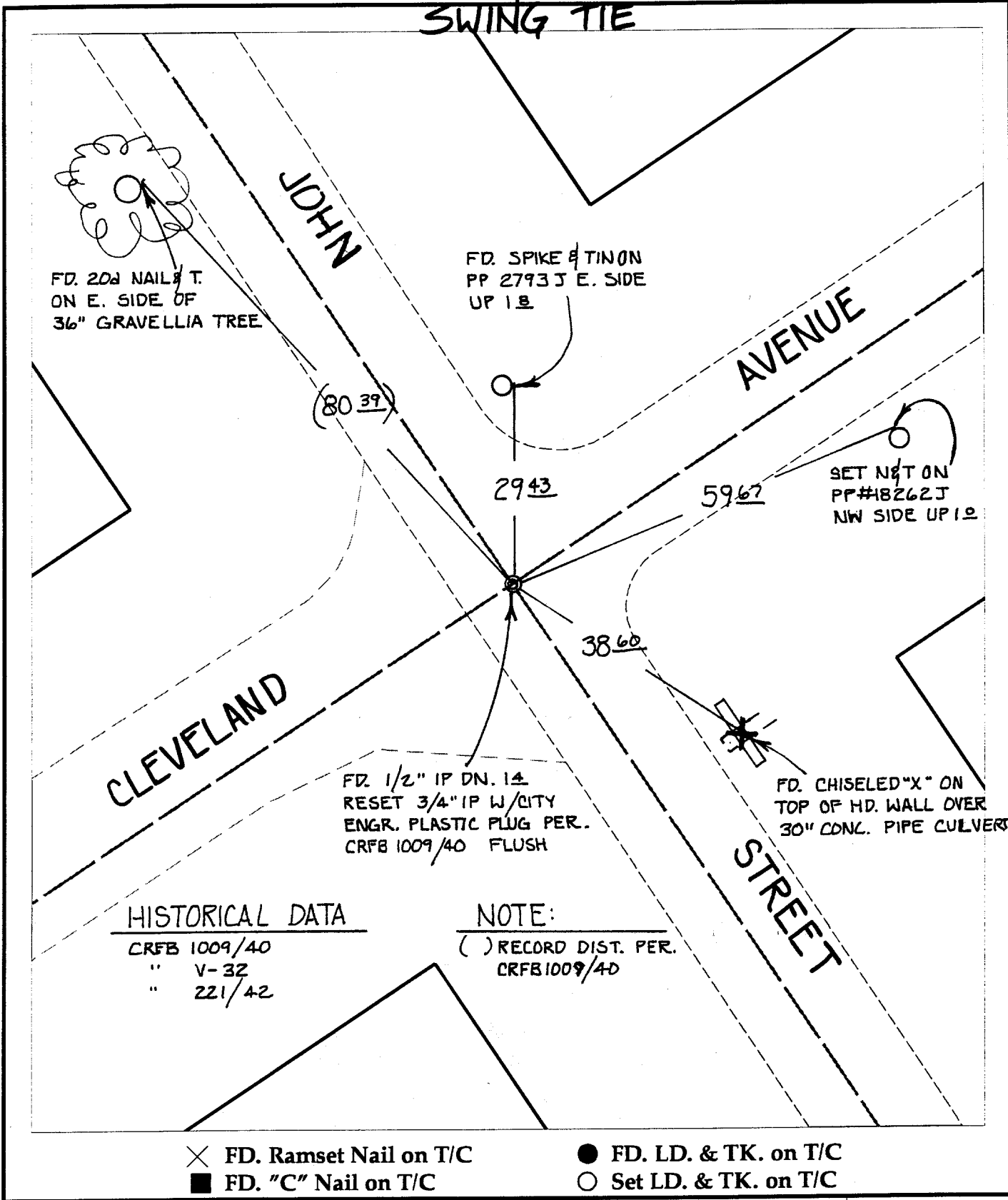

HISTORICAL DATA

CRFB 1009/40
" V-32
" 221/42

NOTE:

() RECORD DIST. PER.
CRFB 1009/40

✕ FD. Ramset Nail on T/C
■ FD. "C" Nail on T/C

● FD. LD. & TK. on T/C
○ Set LD. & TK. on T/C

Scale: 1" = 20'
Date: ~~12/17/99~~ 4/13/98
Drawn by: scurtis
W.O.:
F.B.:

OFFICIAL TIE PLAT
CITY OF RIVERSIDE

These ties are for the purpose of perpetuating the found monumentation. No claim is made as to the relationship of the points or lines shown hereon to true boundary locations.



Sheet 1 of 1
File No.: