

Street: **DOANE**

OFFICIAL USE ONLY

X-Street: **BUSHNELL & WELLS**

SWING TIES

Wells Ave & Bushnell Ave

HISTORICAL DATA
 FB 692/33
 FB 702/17

Crews
 HUTCHINSON
 THORP
 RUSSELL

DATE
 Sept 6, 1968

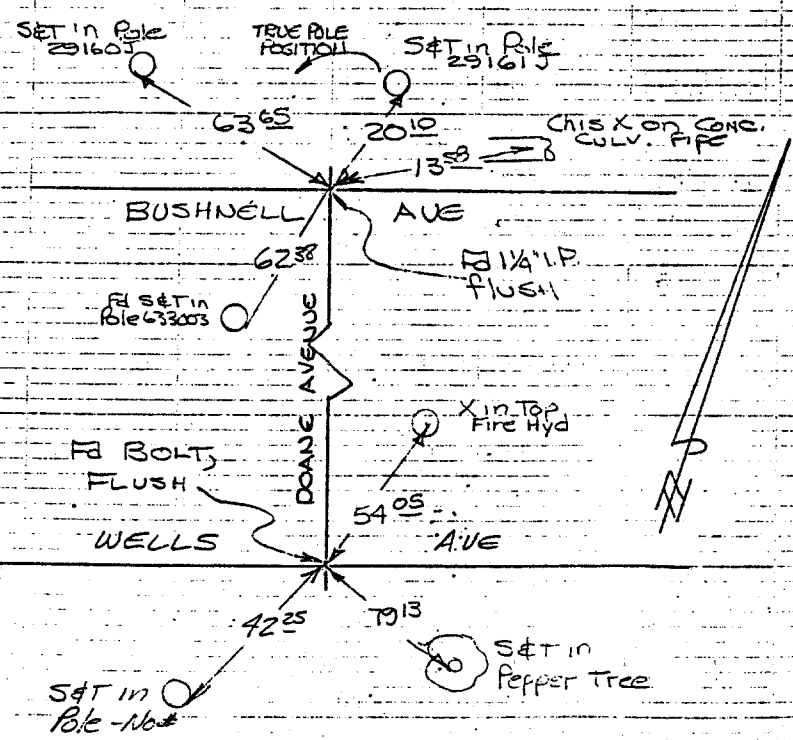

DOANE
 Bushnell
 Wells
 852/52

- ✕ FD. Ramset Nail on T/C
- FD. LD. & TK. on T/C
- FD. "C" Nail on T/C
- Set LD. & TK. on T/C

Scale:
 Date:
 Drawn by:
 W.O.:
 F.B.:

OFFICIAL TIE PLAT
CITY OF RIVERSIDE

These ties are for the purpose of perpetuating the found monumentation. No claim is made as to the relationship of the points or lines shown hereon to true boundary locations.

Sheet 1 of 1
 File No.: