

2371. TIF

Street: DORINDA DR.

X-Street: JO JO WAY
OFFICIAL USE ONLY

**CENTERLINE TIES
FOR TRACT NO. 3540**

DORINDA DR.
AT
JO JO WAY

Recorded in M.B. 57/41-42, Records of Riverside Co., California.

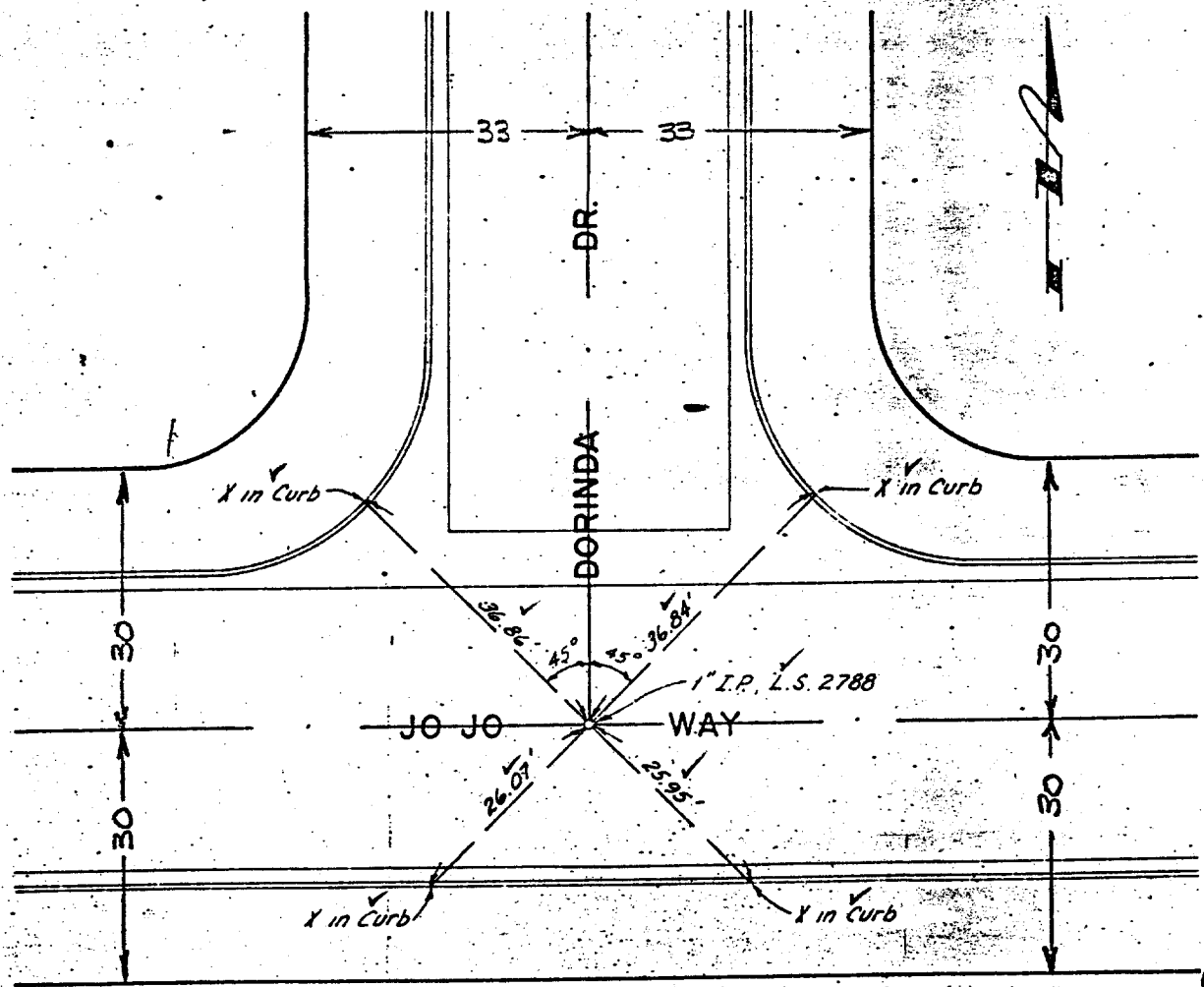

- ✕ FD. Ramset Nail on T/C
- FD. LD. & TK. on T/C
- FD. "C" Nail on T/C
- Set LD. & TK. on T/C

Scale: _____
Date: _____
Drawn by: _____
W.O.: _____
F.B.: _____

**OFFICIAL TIE PLAT
CITY OF RIVERSIDE**

These ties are for the purpose of perpetuating the found monumentation. No claim is made as to the relationship of the points or lines shown hereon to true boundary locations.

Sheet 1 of 1
File No.: _____