

EC. (8)

"NOTE"

Historical DATA	EGY EG. LOCATION SEE 107 [#] 14 R/S - 48/37. MON. POINT ESTABL. FD 1X2-T FLUSH REG. STATION 167+2523 SEC. COUNTY F.B. P. 3 SET CITY F.B. 2/1/16 F.B. P. 6/33 TRANSIT TIES	Field Crew Lorty PRALTT 11-7-1967 FB 629/50
	"NOTE" SET CITY DISC. IN CONC. 3" ABOVE SURFACE 1-3-1968 F.E.H.	

Blank space for notes or additional data.

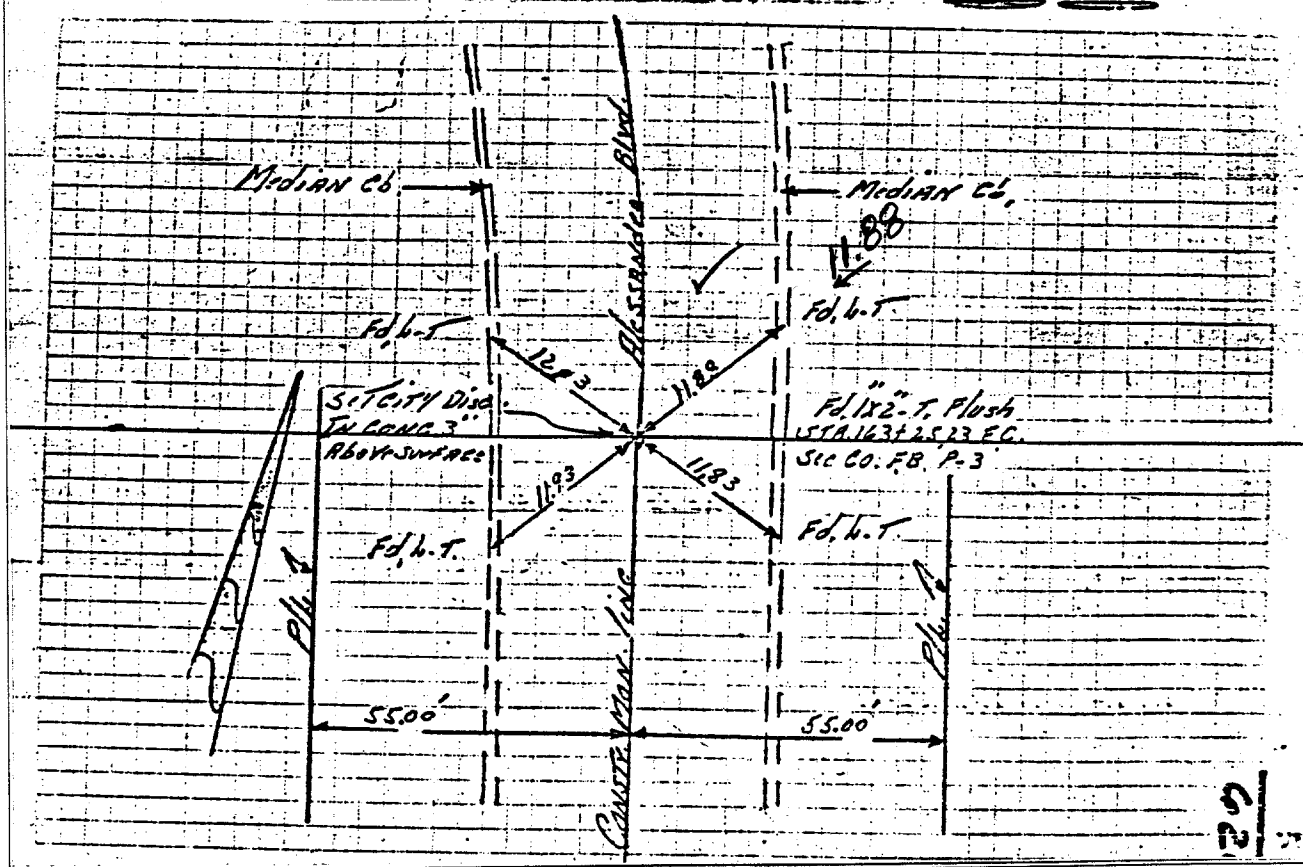

- ✕ FD. Ramset Nail on T/C
- FD. LD. & TK. on T/C
- FD. "C" Nail on T/C
- Set LD. & TK. on T/C

Scale:
Date:
Drawn by:
W.O.:
F.B.:

OFFICIAL TIE PLAT

CITY OF RIVERSIDE

These ties are for the purpose of perpetuating the found monumentation. No claim is made as to the relationship of the points or lines shown hereon to true boundary locations.

Sheet 1 of 1
File No.:

Street: ALESSANDRO X-Street: OFFICIAL USE ONLY

14