

Street: **Alessandra**

OFFICIAL USE ONLY

X-Street: **N. of Trautwein**

35

Alessandra Blvd
 @ South line N.E. 1/4 - S.E. 1/4 of Sec. 7

(27)

HISTORICAL DATA Sec. FB. 679/65-66 F.B. 6-1/35 FLS-42/42		FIELD PARTY NEWBY THOMP FIVE	
		EB. 679/65-66 2-7-1962	

"NOTE" TRANSIT TIES

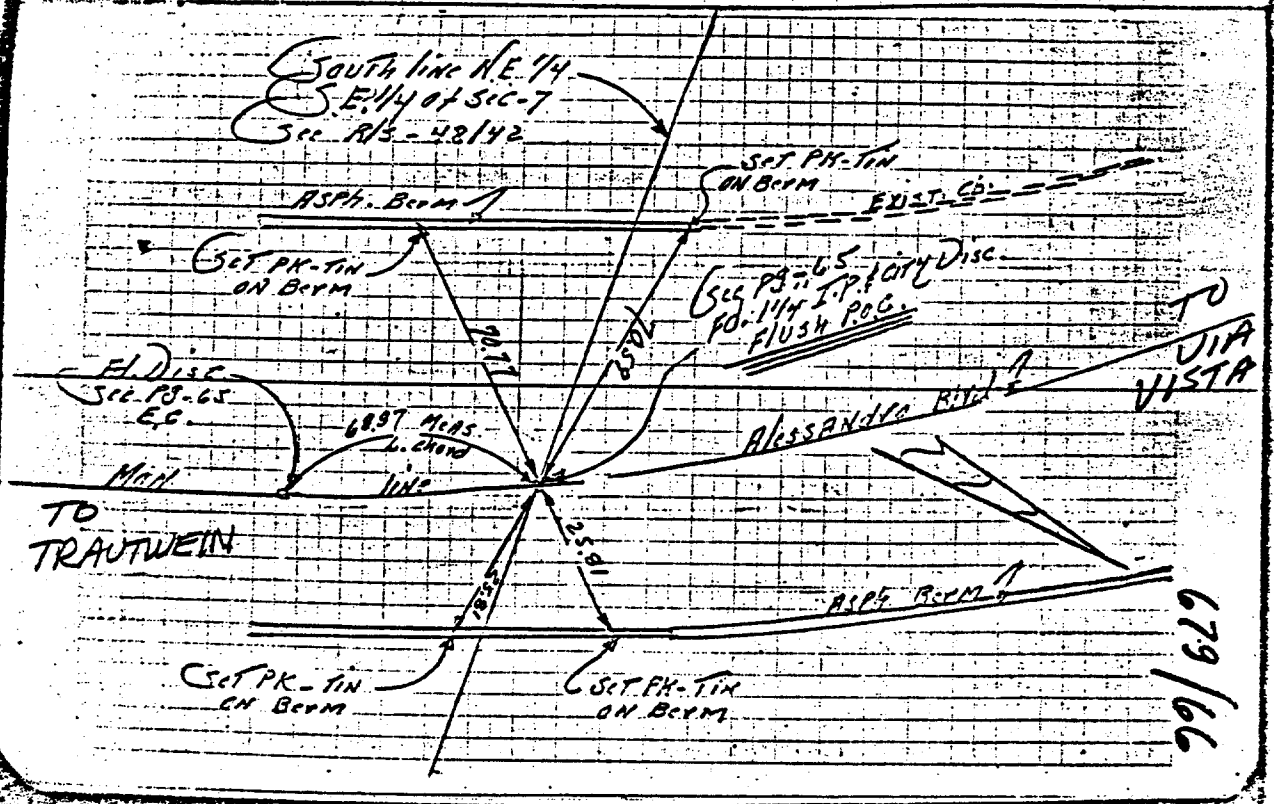

- ✕ FD. Ramset Nail on T/C
- FD. LD. & TK. on T/C
- FD. "C" Nail on T/C
- Set LD. & TK. on T/C

Scale:
 Date:
 Drawn by:
 W.O.:
 F.B.:

OFFICIAL TIE PLAT
 CITY OF RIVERSIDE

These ties are for the purpose of perpetuating the found monumentation. No claim is made as to the relationship of the points or lines shown hereon to true boundary locations.

Sheet 1 of 1
 File No.: