

Street: **ARROYO DRIVE**

X-Street: _____
OFFICIAL USE ONLY

18

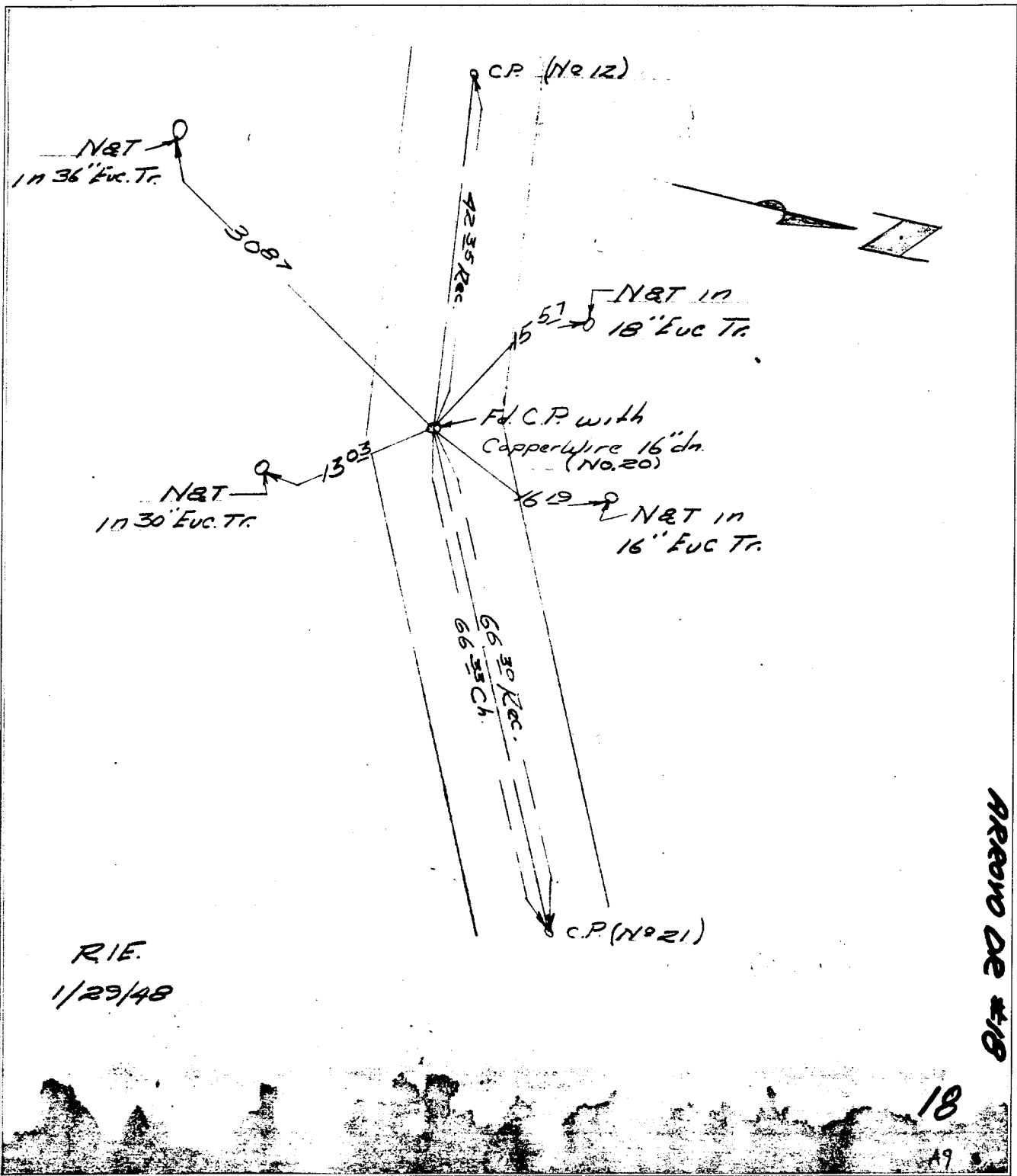

ARROYO DE #18

R.I.E.
1/29/48

- × FD. Ramset Nail on T/C
- FD. LD. & TK. on T/C
- FD. "C" Nail on T/C
- Set LD. & TK. on T/C

OFFICIAL TIE PLAT
CITY OF RIVERSIDE

These ties are for the purpose of perpetuating the found monumentation. No claim is made as to the relationship of the points or lines shown hereon to true boundary locations.

Scale: _____
Date: _____
Drawn by: _____
W.O.: _____
F.B.: _____

Sheet 1 of 1
File No.: _____