

SWING TIES

HISTORICAL DATA

- CITY TIES
- TIE SHT FOR TR 2903
- MB 53/9-11

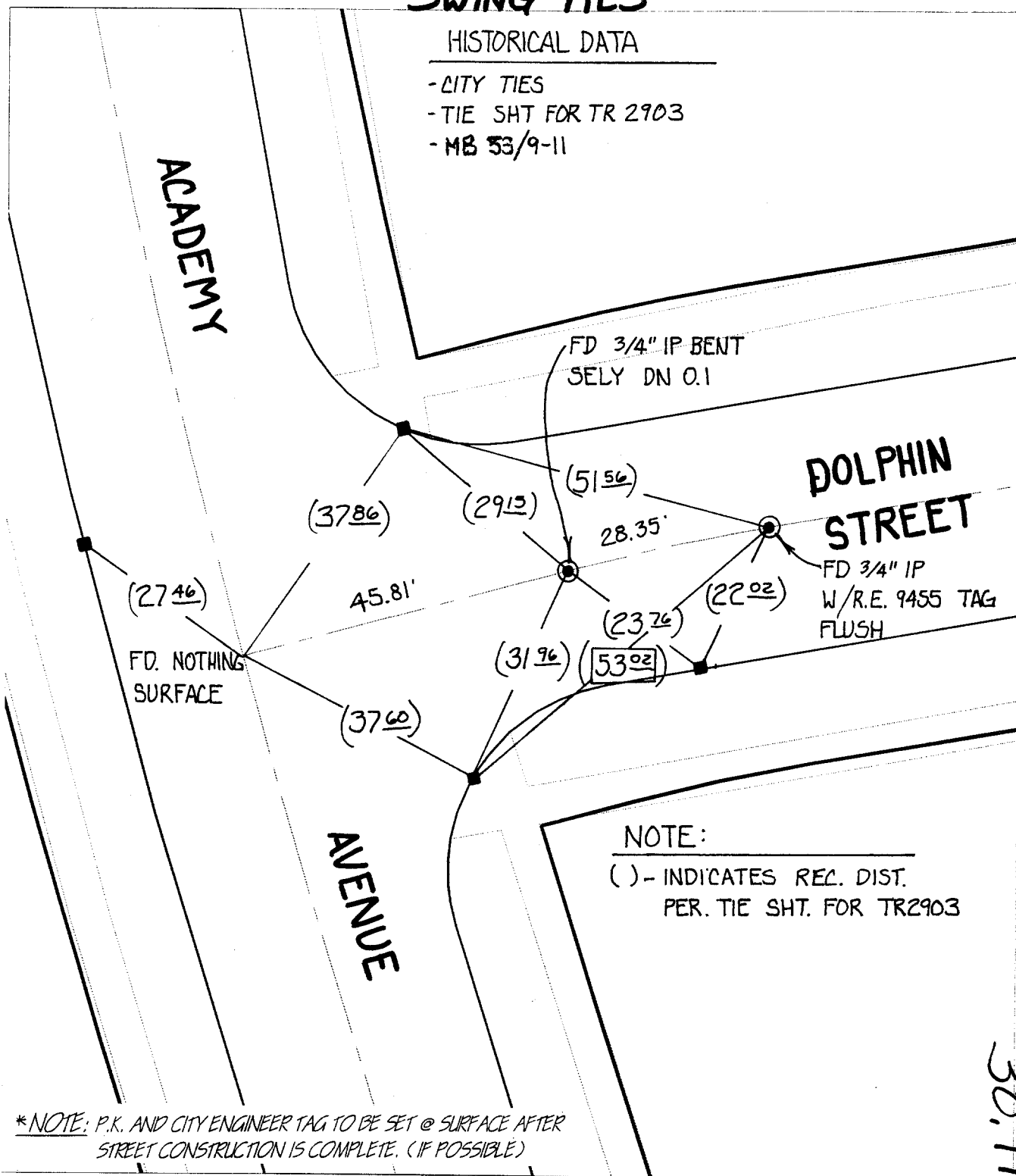

Street: ACADEMY AVENUE
 X-Street: DOLPHIN STREET
 OFFICIAL USE ONLY
 DOLPHIN STREET

NOTE:
 () - INDICATES REC. DIST.
 PER. TIE SHT. FOR TR2903

*NOTE: P.K. AND CITY ENGINEER TAG TO BE SET @ SURFACE AFTER STREET CONSTRUCTION IS COMPLETE. (IF POSSIBLE)

- ✕ FD. Ramset Nail on T/C
- FD. LD. & TK. on T/C
- FD. "C" Nail on T/C
- Set LD. & TK. on T/C

30.71'

Scale: 1" = 20'
 Date: 06/14/00
 Drawn by: SURVEY
 W.O.:
 F.B.:

OFFICIAL TIE PLAT CITY OF RIVERSIDE

These ties are for the purpose of perpetuating the found monumentation. No claim is made as to the relationship of the points or lines shown hereon to true boundary locations.



Sheet 1 of 1
 File No.: