

5194.TIF

F.B.:
W.O.:
Drawn by: scurtis
Date: 11/26/97
Scale: 1" = 20'

OFFICIAL TIE PLAT

CITY OF RIVERSIDE

These ties are for the purpose of perpetuating the found monumentation. No claim is made as to the relationship of the points or lines shown hereon to true boundary locations.

File No.:
Sheet 1 of 1



- × FD. Rammet Nail on T/C
- FD. "C" Nail on T/C
- FD. LD. & TK. on T/C
- Set LD. & TK. on T/C

Street: FIFTEENTH
X-Street: MAIN ST. (NORTH INT.)
OFFICIAL USE ONLY

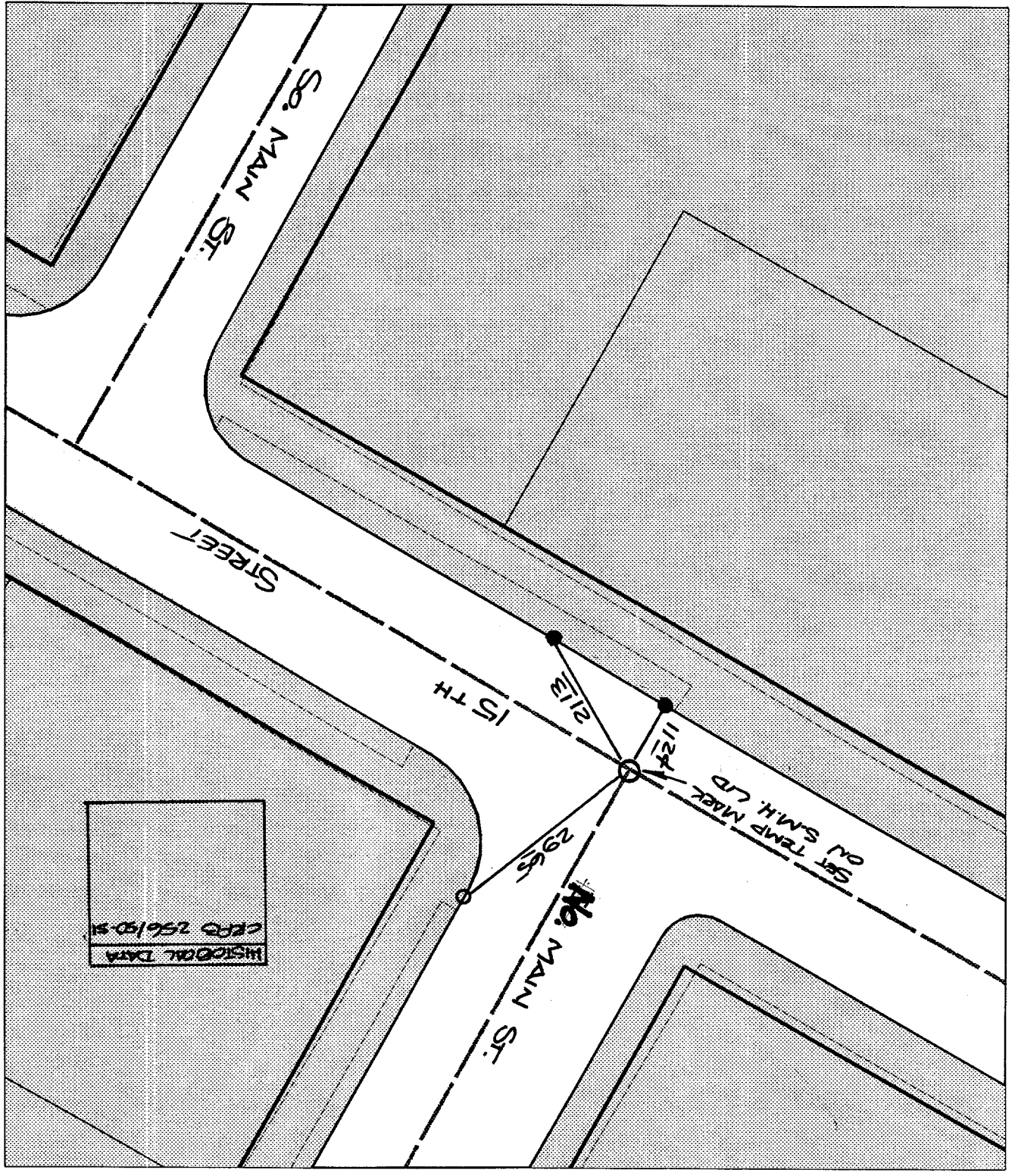

HISTORICAL DATA
CPRS 256190.SI