

3452.TIF

GLENCOE DR.

SURVEY NOTES

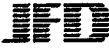

J.F. Davidson Associates, Inc.
ENGINEERING PLANNING SURVEYING
ARCHITECTURE LANDSCAPE ARCHITECTURE

F.B. 12845/22

SURVEY OF TRACT 27654, E TIES
FOR MARCO REY W.O. No. 12845 Date 11-9-93
SURVEY PARTY FURONG BRANKO REF. AM.

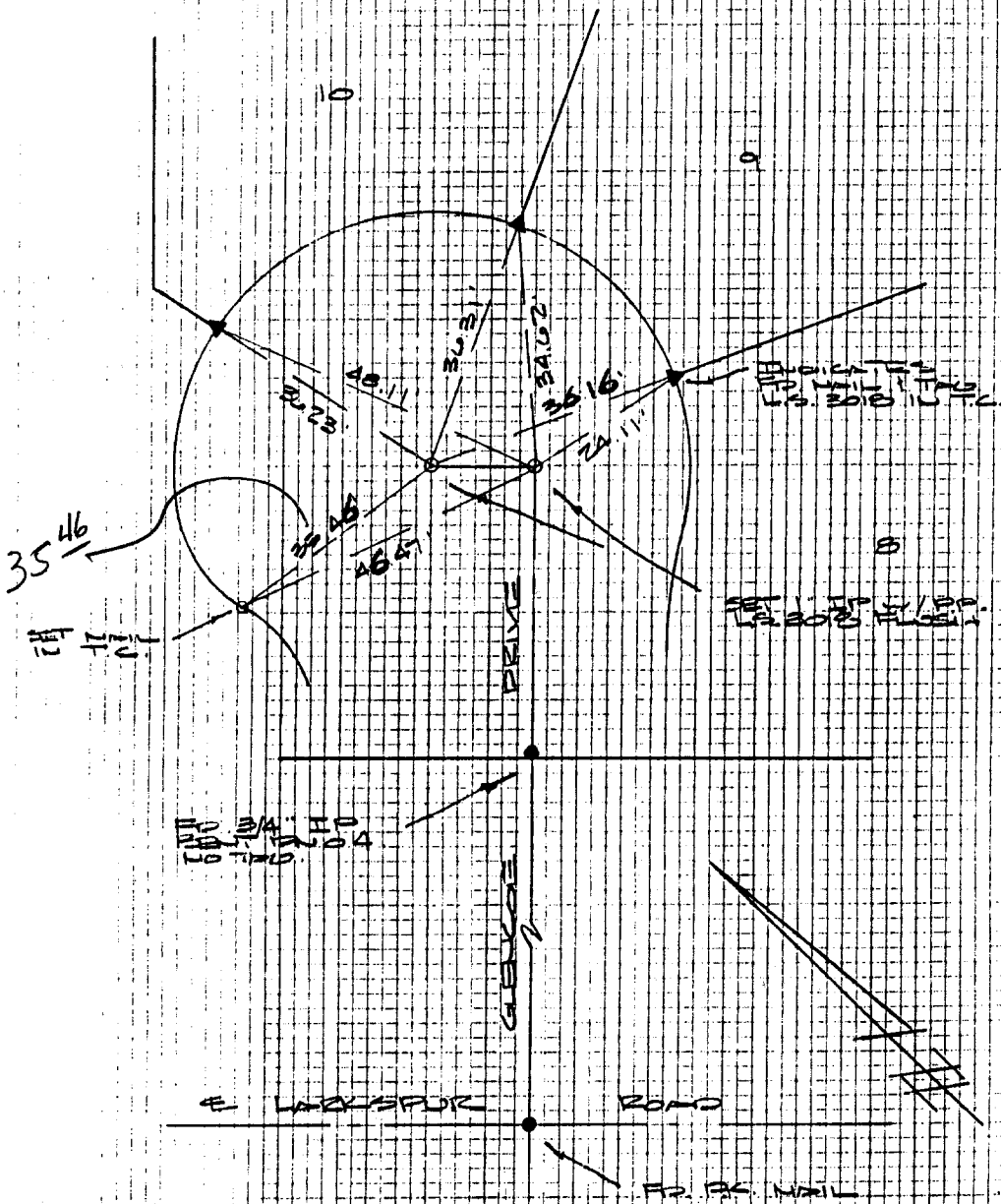

- ✕ FD. Ramset Nail on T/C
- FD. LD. & TK. on T/C
- FD. "C" Nail on T/C
- Set LD. & TK. on T/C

Scale:
Date:
Drawn by:
W.O.:
F.B.:

OFFICIAL TIE PLAT

CITY OF RIVERSIDE

These ties are for the purpose of perpetuating the found monumentation. No claim is made as to the relationship of the points or lines shown hereon to true boundary locations.

Sheet 1 of 1
File No.:

Street: GLENCOE DR.
X-Street: Cal de Sac
OFFICIAL USE ONLY