

3477.TIF

*** TRANSIT & RADIAL TIES ***

HISTORICAL DATA:

TR. 3670 ~ M.B. 62/3-4
TR. 2238 ~ M.B. 46/91-92
A.A. WEBB F.B. 1004/112

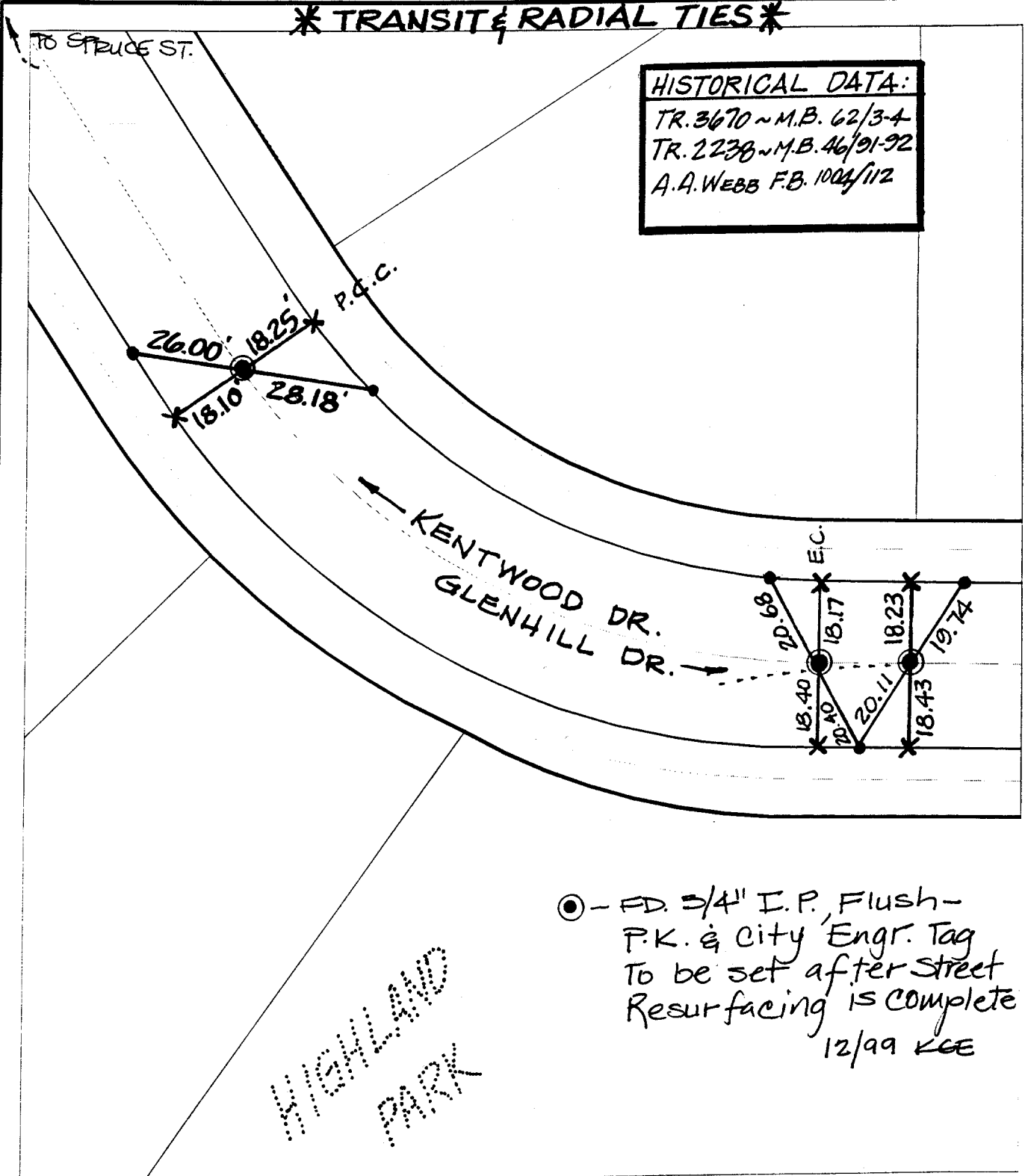

○ - FD. 3/4" I.P., Flush - P.K. & City Engr. Tag
To be set after Street Resurfacing is complete
12/99 KGE

- × FD. Ramset Nail on T/C
- FD. "C" Nail on T/C

- FD. LD. & TK. on T/C
- Set LD. & TK. on T/C

Scale: 1" = 30'

Date: 12/03/99

Drawn by: survey

W.O.:

F.B.:

**OFFICIAL TIE PLAT
CITY OF RIVERSIDE**

These ties are for the purpose of perpetuating the found monumentation. No claim is made as to the relationship of the points or lines shown hereon to true boundary locations.



Sheet 1 of 1

File No.:

Street:

KENTWOOD DR

X-Street:
OFFICIAL USE ONLY

GLENHILL DR