

3700.TIF

J. F. DAVIDSON ASSOCIATES
CIVIL ENGINEERS • SURVEYORS • PLANNERS

F.B. 82-7685/387

SURVEY OF E TIES TRACT 18376-3
FOR PRESLEY W.O.No. 82-7685 DATE 9-19-85
SURVEY PARTY SIMENTAL ANHORN FURLONG REF. _____ A.M. _____

SURVEY NOTES

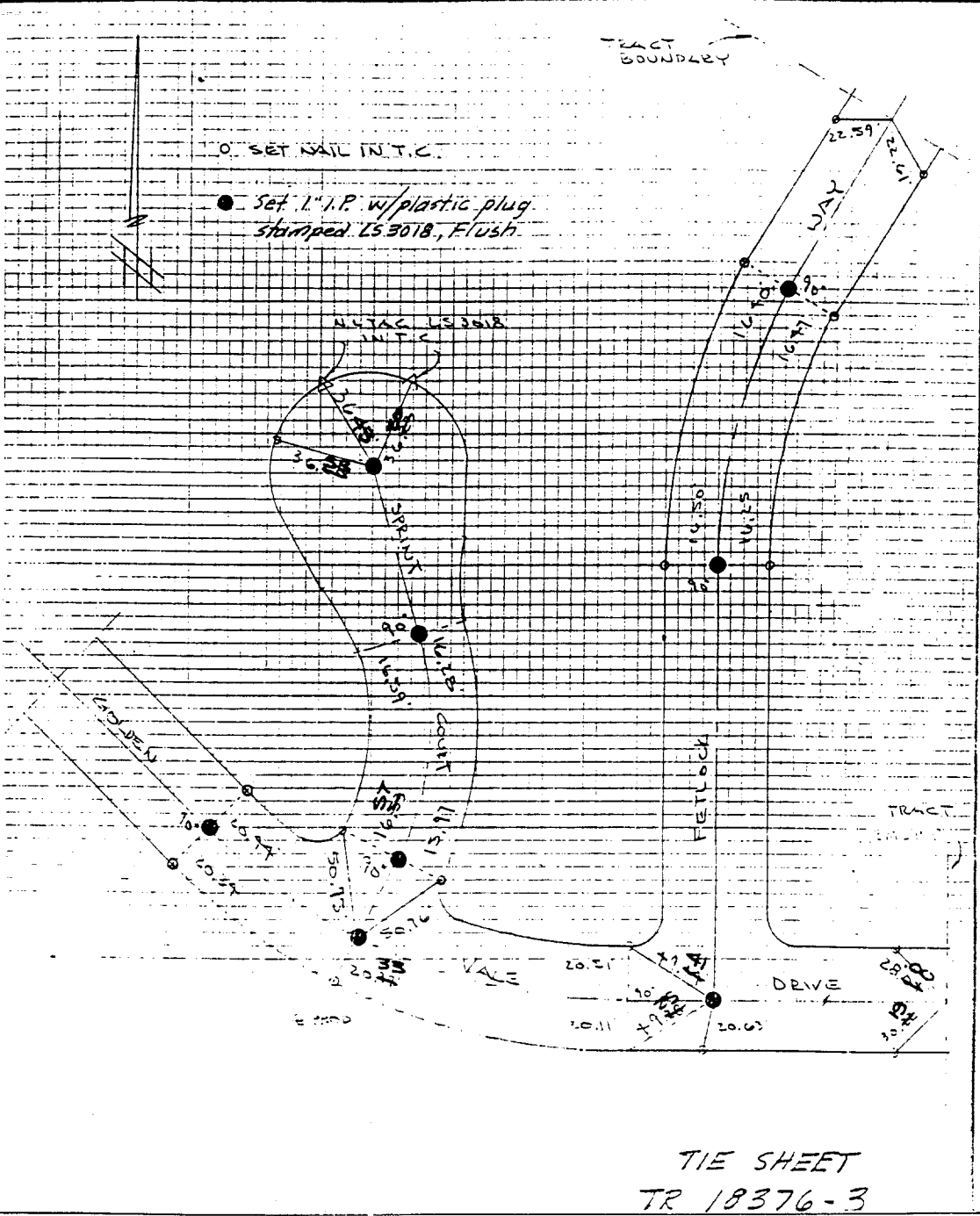

TIE SHEET
TR 18376-3

Street: GOLDEN VALE DR.
X-Street: B/H SPRINT & FELLOCK WAY
OFFICIAL USE ONLY

- × FD. Ramset Nail on T/C
- FD. LD. & TK. on T/C
- FD. "C" Nail on T/C
- Set LD. & TK. on T/C

OFFICIAL TIE PLAT CITY OF RIVERSIDE

These ties are for the purpose of perpetuating the found monumentation. No claim is made as to the relationship of the points or lines shown hereon to true boundary locations.

Sheet 1 of 1
File No.:

Scale: _____
 Date: _____
 Drawn by: _____
 V.O.: _____
 .B.: _____