

* SWING TIES *

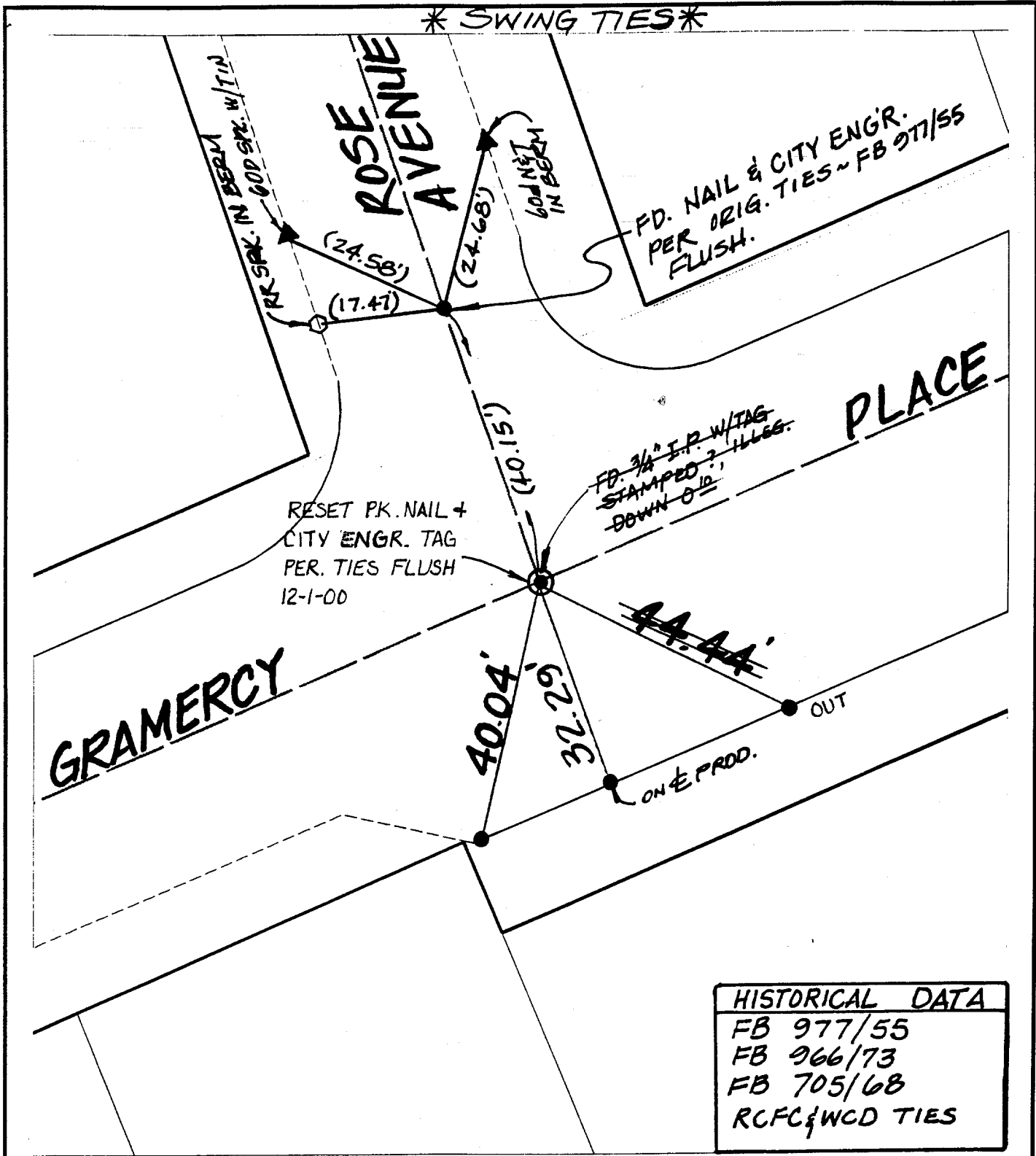

Street: GRAMERCY PLACE X-Street: ROSE AVENUE
 OFFICIAL USE ONLY

RESET PK. NAIL +
 CITY ENGR. TAG
 PER. TIES FLUSH
 12-1-00

FD. 3/4" I.P. W/TAG
 STAMPED ?
 DOWN 0.10

HISTORICAL DATA	
FB	977/55
FB	966/73
FB	705/68
RCFC & WCD TIES	

- × FD. Ramset Nail on T/C
- FD. LD. & TK. on T/C
- FD. "C" Nail on T/C
- Set LD. & TK. on T/C

Scale: 1" = 20'
 Date: 12/09/99
 Drawn by: KGE
 W.O.:
 F.B.:

OFFICIAL TIE PLAT
 CITY OF RIVERSIDE

These ties are for the purpose of perpetuating the found monumentation. No claim is made as to the relationship of the points or lines shown hereon to true boundary locations.

Sheet 1 of 1
 File No.: