

111-213

ARLINGTON AVE. ARBOR DR. INDEX LL 11 PAGE 58.1
GARCIA - FAUND - RELOUEN DATE JULY 16, 1985

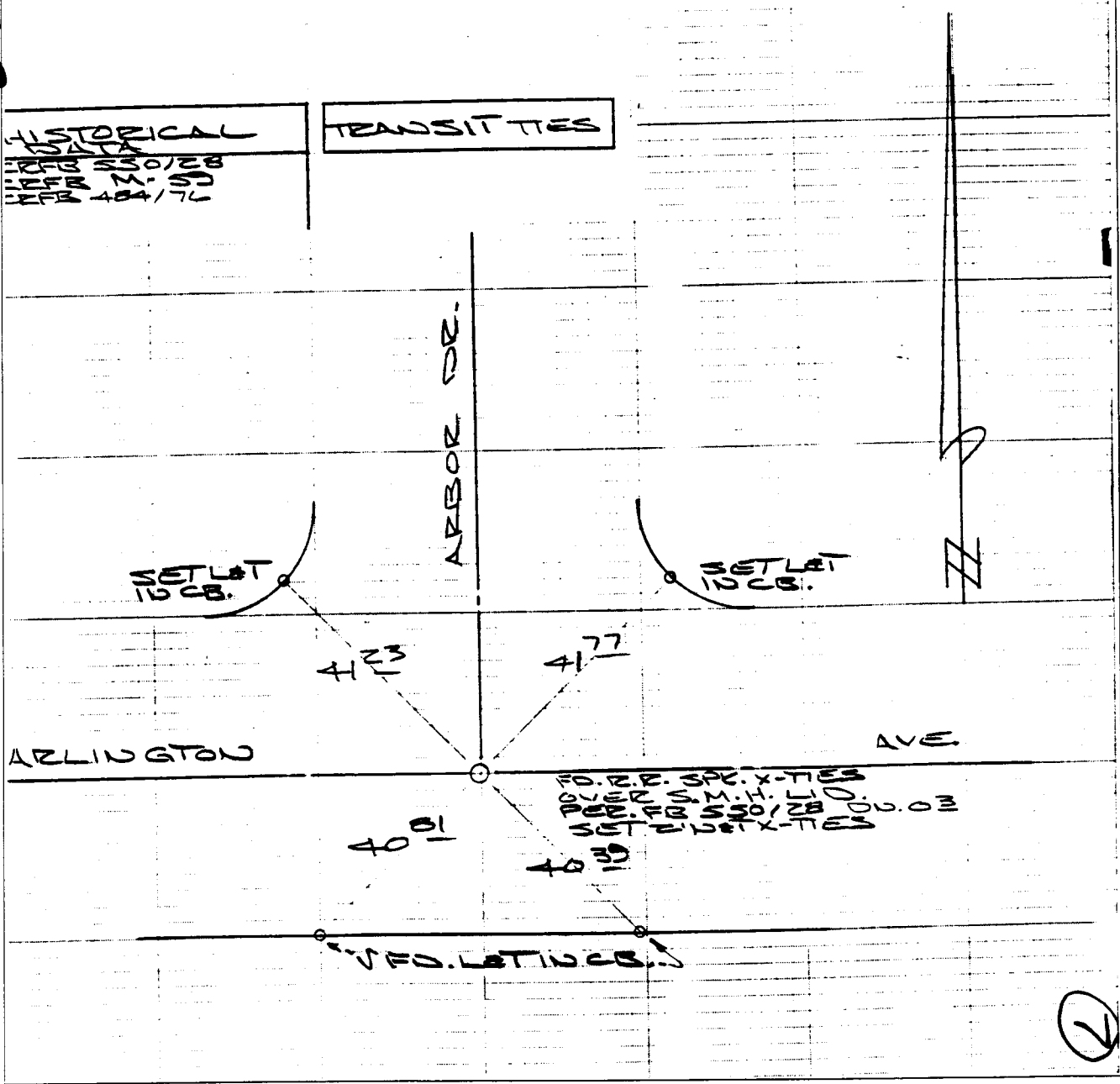

Street: Arlington Ave
X-Street: Arbor Dr.
OFFICIAL USE ONLY #7

- ✕ FD. Ramset Nail on T/C
- FD. LD. & TK. on T/C
- FD. "C" Nail on T/C
- Set LD. & TK. on T/C

Scale:
Date:
Drawn by:
W.O.:
F.B.:

OFFICIAL TIE PLAT

CITY OF RIVERSIDE

These ties are for the purpose of perpetuating the found monumentation. No claim is made as to the relationship of the points or lines shown hereon to true boundary locations.

Sheet 1 of 1
File No.: