

3858. T/F

Street: IDYLLWILD LANE (NEAR) X-Street: MEDALLION & JURUPA

OFFICIAL USE ONLY

IDYLLWILD LANE
NEAR MEDALLION PLACE

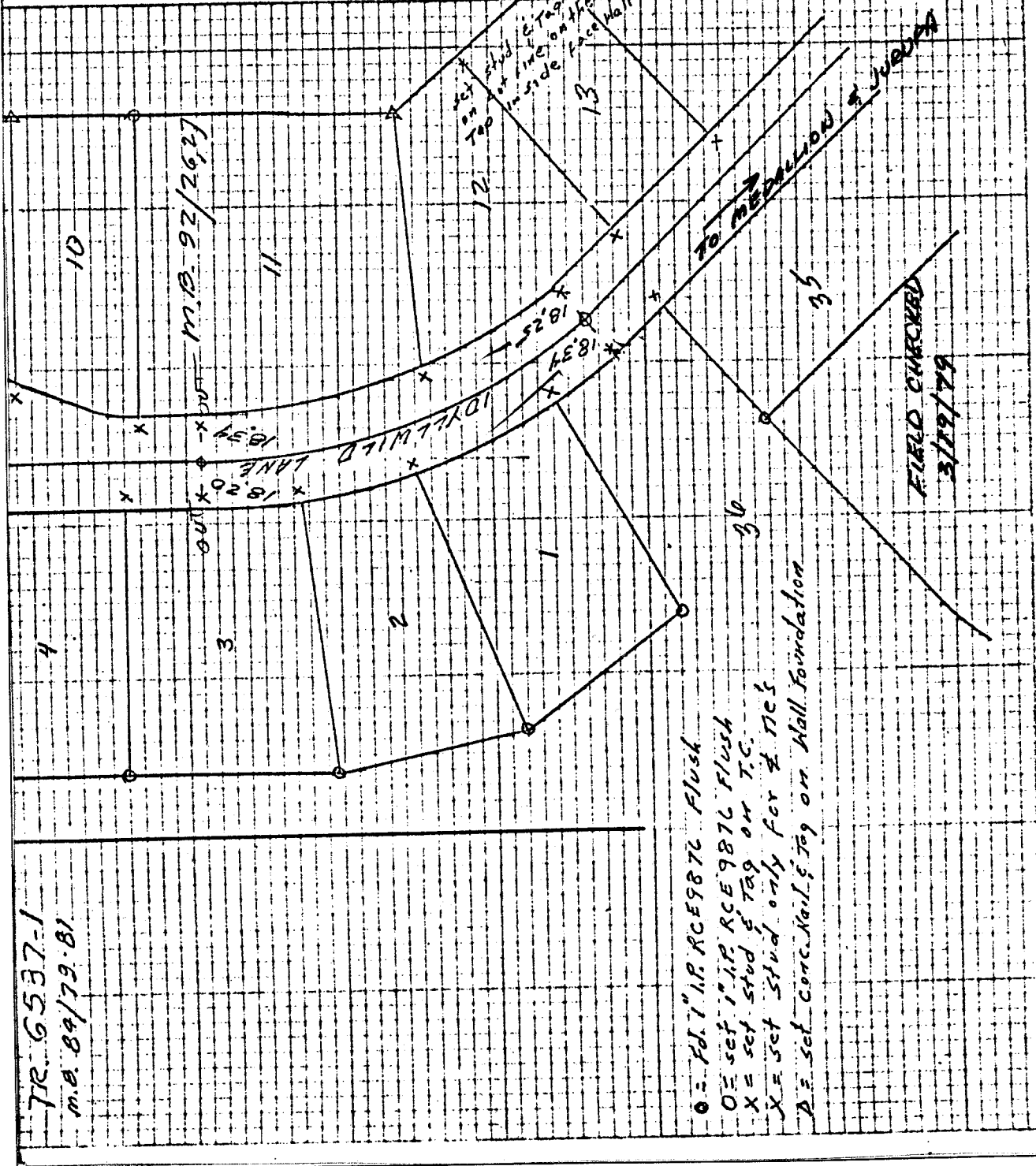

- ✕ FD. Ramset Nail on T/C
- FD. LD. & TK. on T/C
- FD. "C" Nail on T/C
- Set LD. & TK. on T/C

Scale: _____
 Date: _____
 Drawn by: _____
 W.O.: _____
 F.B.: 1031

OFFICIAL TIE PLAT

CITY OF RIVERSIDE

These ties are for the purpose of perpetuating the found monumentation. No claim is made as to the relationship of the points or lines shown hereon to true boundary locations.

TR 6537-1

Sheet 1 of 1
 File No.: