

392-716

Street: WILMINGTON AVE

OFFICIAL USE ONLY

X-Street: DIVISION ST.

20

HISTORICAL DATA REV. 05/82		TRANSIT TIES	DIVISION AT ARUNGT
			CREW STELLE
			FRYC NEW
			NOV 11, 70
			F.B. 518/73

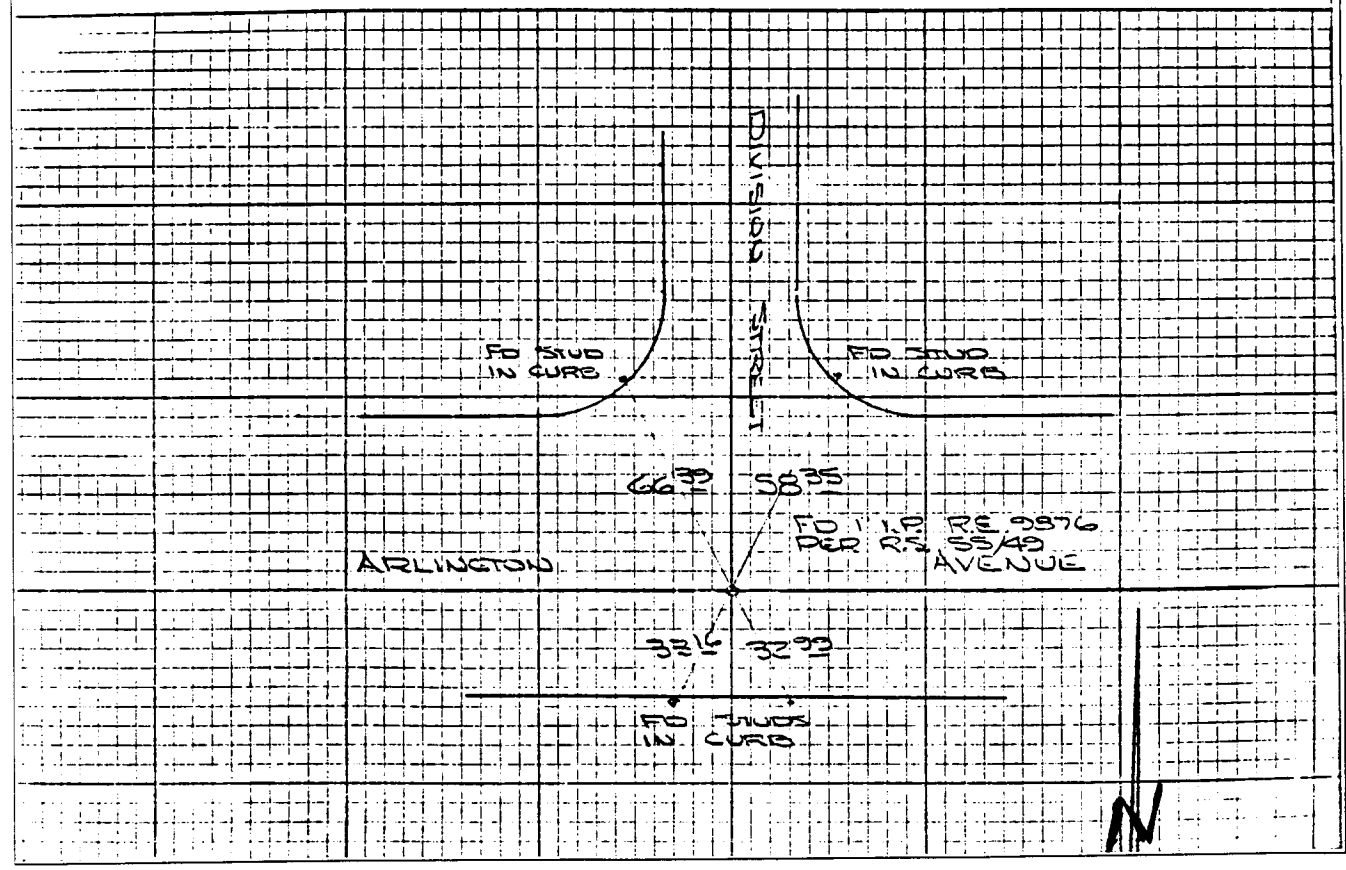

- ✕ FD. Ramset Nail on T/C
- FD. LD. & TK. on T/C
- FD. "C" Nail on T/C
- Set LD. & TK. on T/C

Scale:
Date:
Drawn by:
W.O.:
F.B.:

OFFICIAL TIE PLAT

CITY OF RIVERSIDE

These ties are for the purpose of perpetuating the found monumentation. No claim is made as to the relationship of the points or lines shown hereon to true boundary locations.

Sheet 1 of 1
File No.: