

3951.111

Street: INDIANA AVE

X-Street: HARDING ST.

OFFICIAL USE ONLY

Indiana Ave
F.B.: 272/22

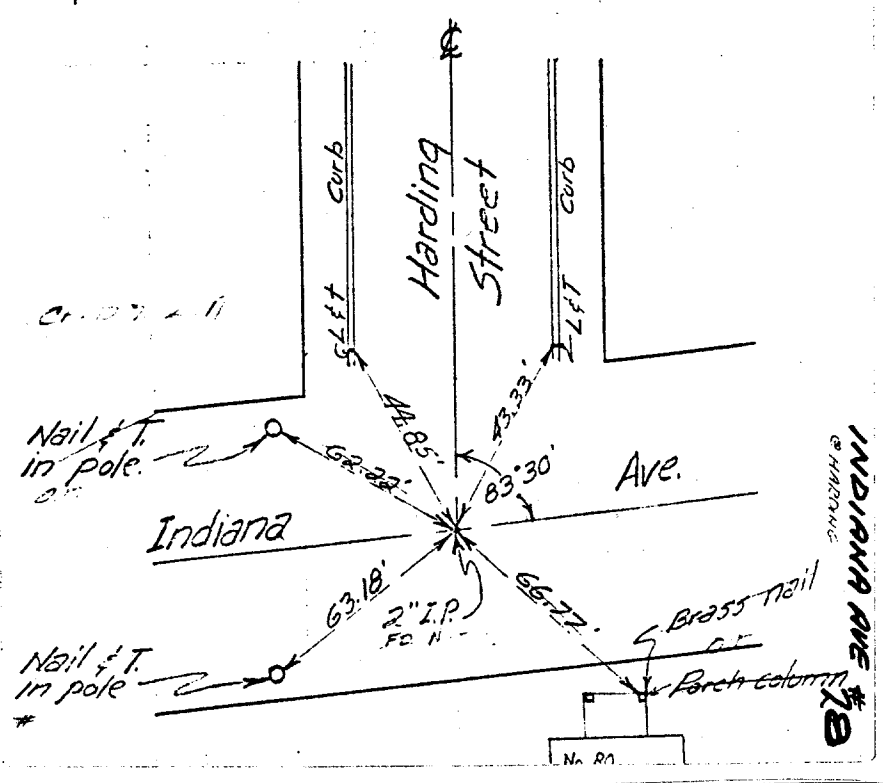
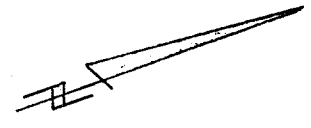
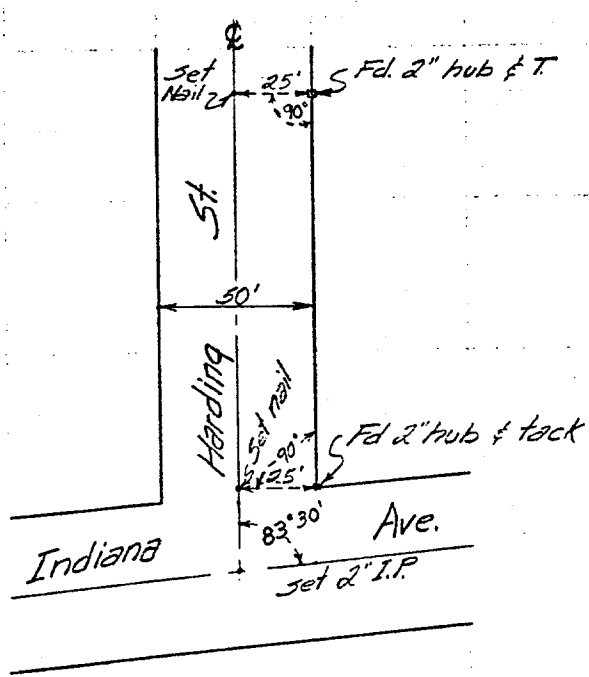

Pod
11/23/65

INDIANA AVE #70
HARDING ST

- ✕ FD. Ramset Nail on T/C
- FD. "C" Nail on T/C

- FD. LD. & TK. on T/C
- Set LD. & TK. on T/C

Scale:
Date:
Drawn by:
W.O.:
F.B.: 272/22

OFFICIAL TIE PLAT

CITY OF RIVERSIDE

These ties are for the purpose of perpetuating the found monumentation. No claim is made as to the relationship of the points or lines shown hereon to true boundary locations.

Sheet 1 of 1
File No.:

802