

399.71A

ARLINGTON AVE.

OF DURANGO RD. & HORACE ST INDEX

LL 11

PAGE

30

ED BY GARCIA-FANN-BELDEN

DATE MAY 17, 1985

HISTORICAL DATA	
LE	1000/61-62
LE	1000/74
LE	1000/6
LE	1000/20
LE	1000/4
LE	1000/30

TRANSIT TIES

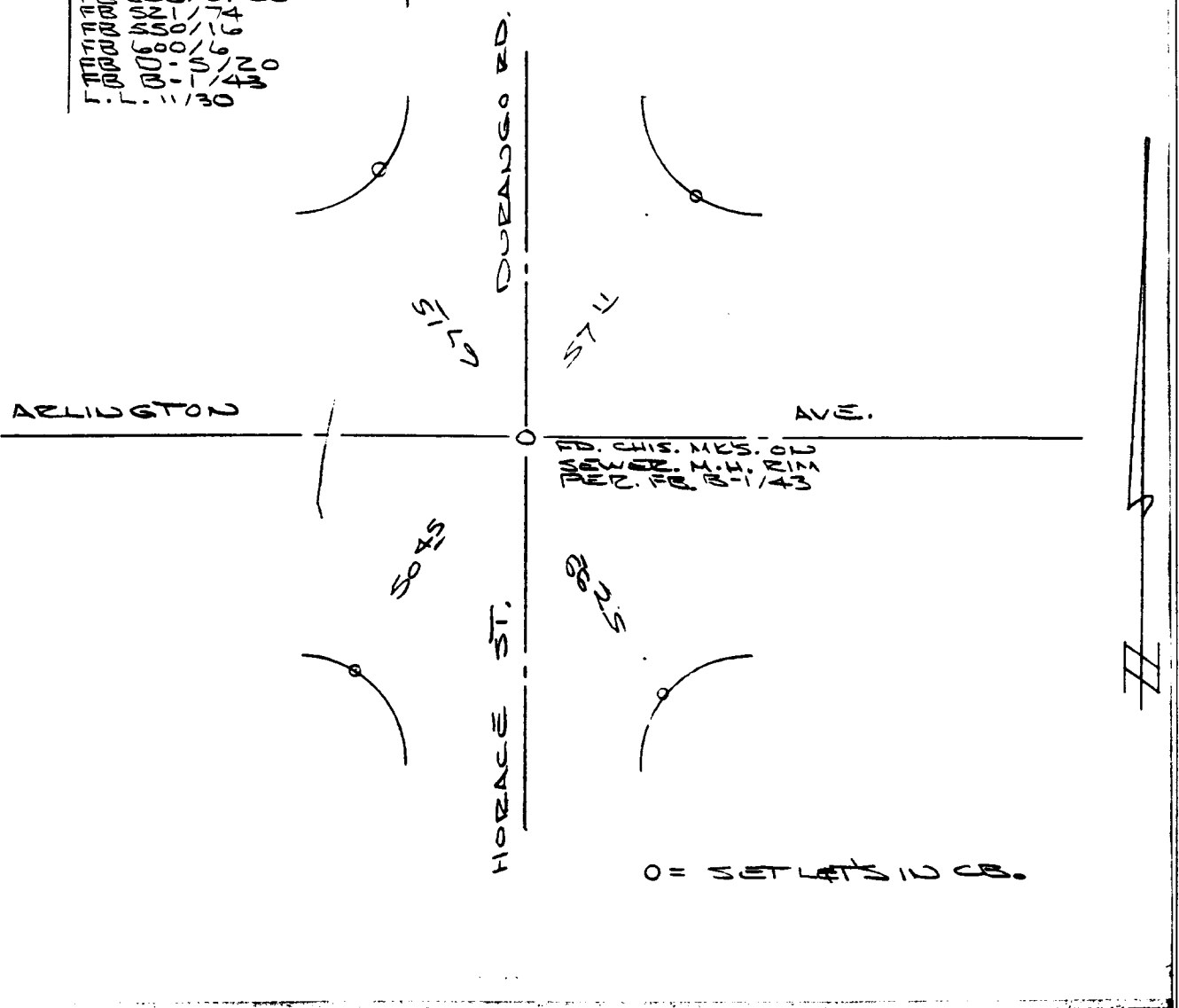

FD. CHIS. MKS. NO. 1
DUR. CH. M.H. NO. 133
HOR. CH. B-1/43

Street: Arlington Ave
X-Street: Durango & Horace # 21
OFFICIAL USE ONLY

- ✕ FD. Ramset Nail on T/C
- FD. "C" Nail on T/C

- FD. LD. & TK. on T/C
- Set LD. & TK. on T/C

Scale:
Date:
Drawn by:
W.O.:
F.B.:

OFFICIAL TIE PLAT
CITY OF RIVERSIDE

These ties are for the purpose of perpetuating the found monumentation. No claim is made as to the relationship of the points or lines shown hereon to true boundary locations.

Sheet 1 of 1
File No.: