

4040. TIF

Street: HASKELL ST.

X-Street: 5/8 ARROWHEAD ST.

OFFICIAL USE ONLY

HASKELL ST.
southerly
of
Arrowhead St.
F.B. 610/60

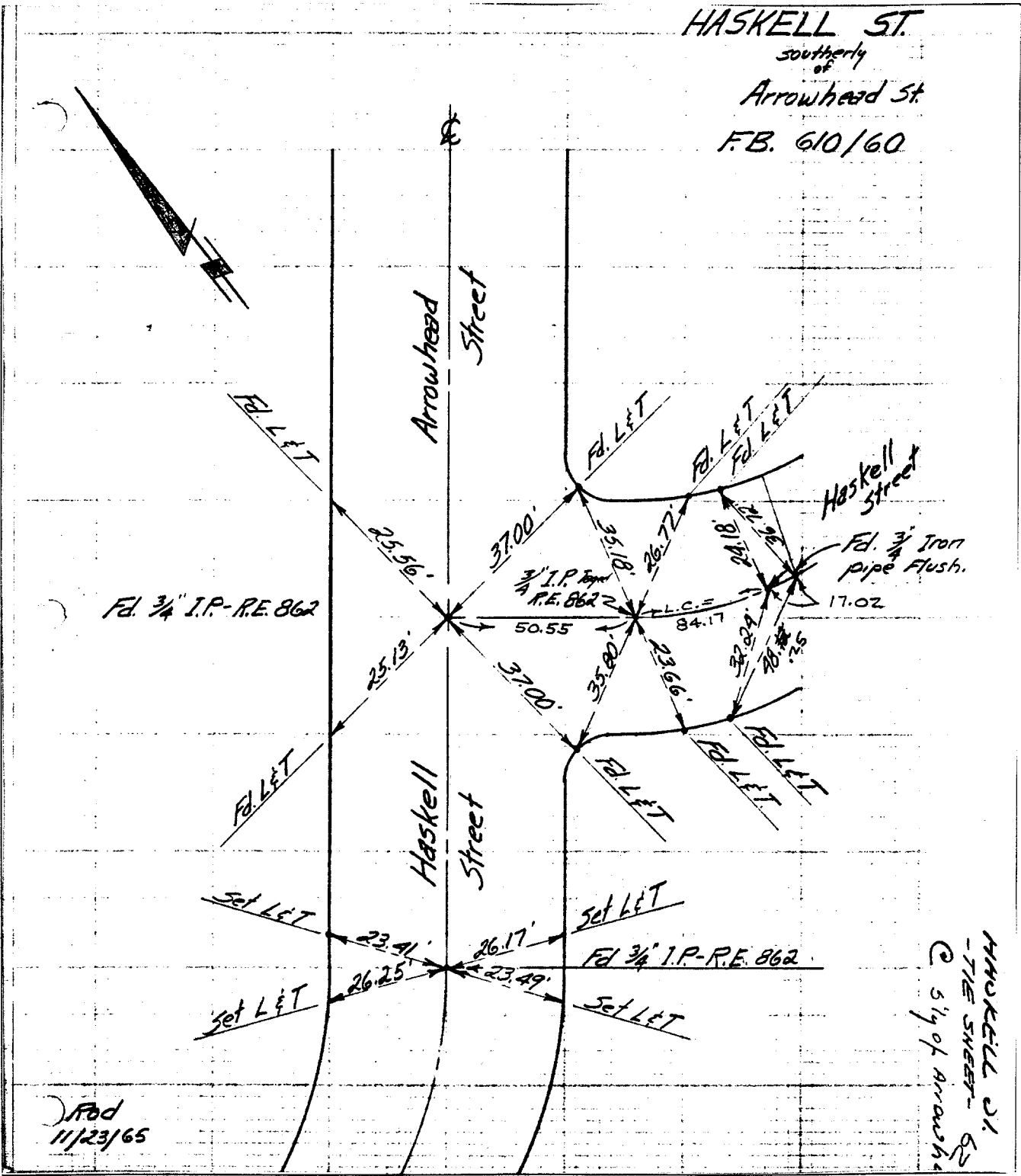

- ✗ FD. Ramset Nail on T/C
- FD. LD. & TK. on T/C
- FD. "C" Nail on T/C
- Set LD. & TK. on T/C

Scale:
 Date:
 Drawn by:
 W.O.:
 F.B.: 610/60

OFFICIAL TIE PLAT
CITY OF RIVERSIDE

These ties are for the purpose of perpetuating the found monumentation. No claim is made as to the relationship of the points or lines shown hereon to true boundary locations.

Sheet 1 of 1
 File No.:

HASKELL ST.
-TIE SHEET- 60
@ 5/8 of Arrowhead

Fod
11/23/65