

Street: HAWARDEEN

X-Street: WASHINGTON
OFFICIAL USE ONLY

HISTORICAL DATA		SWING TIES		CREW: STEELE	
				FRYE	
				NEW	
				DEPT 22/51	
				FB: 921/61	

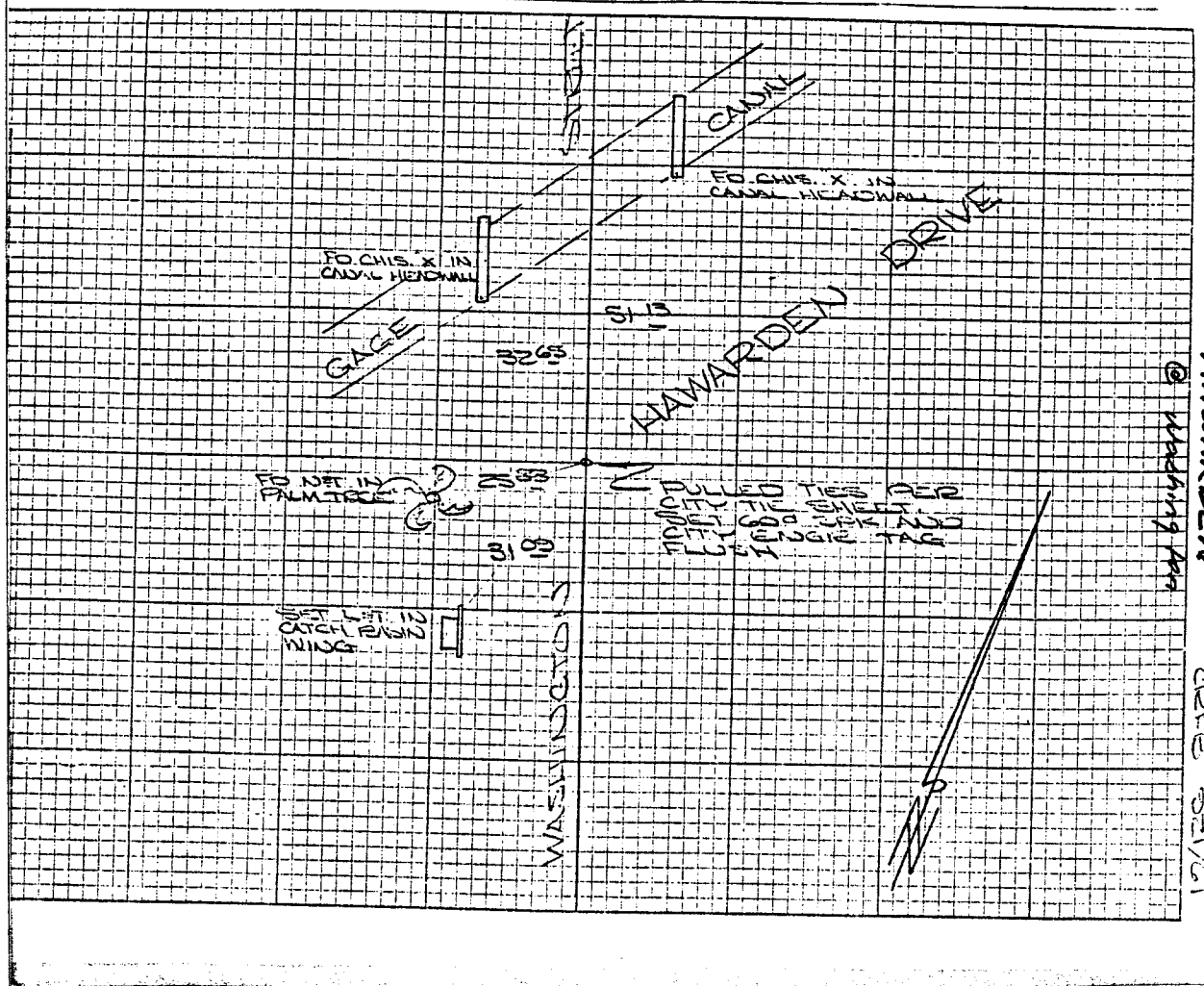

- × FD. Ramset Nail on T/C
- FD. LD. & TK. on T/C
- FD. "C" Nail on T/C
- Set LD. & TK. on T/C

Scale:
Date:
Drawn by:
W.O.:
F.B.: 921/61

OFFICIAL TIE PLAT
CITY OF RIVERSIDE

These ties are for the purpose of perpetuating the found monumentation. No claim is made as to the relationship of the points or lines shown hereon to true boundary locations.

Sheet 1 of 1
File No.: