

STREET ACADEMY AVE X-STREET YUMA CT OFFICE USE ONLY

41.71F

- INDICATES 3/4" I.P. SET TAGGED R.E. 9455
- INDICATES NAIL SET IN CURB

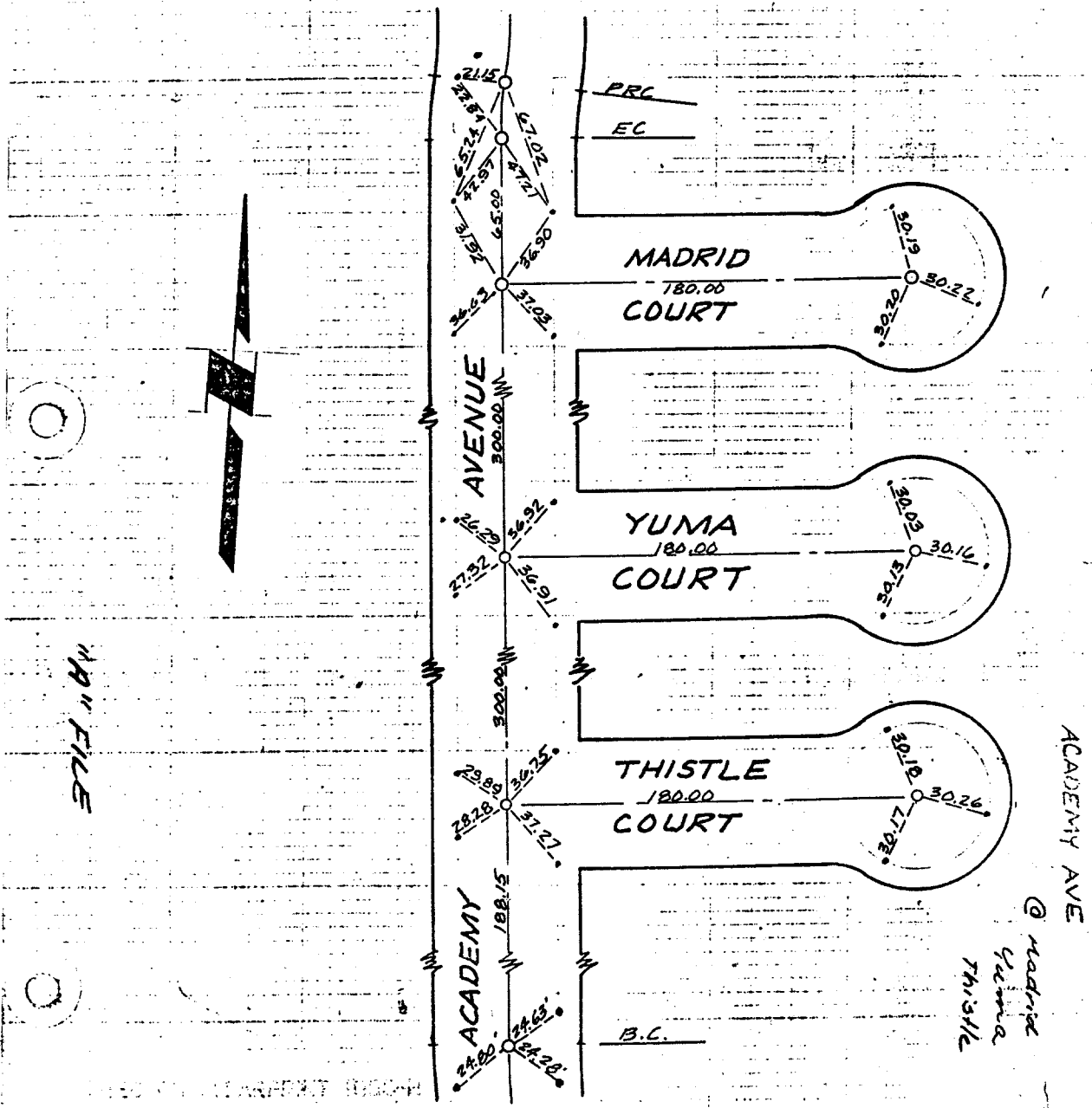

- × FD. Ramset Nail on T/C
- FD. "C" Nail on T/C

- FD. LD. & TK. on T/C
- SET LD. & TK. On T/C

SCALE:

DATE:

DR. BY:

W.O.:

F.B.:

OFFICIAL TIE PLAT

CITY OF RIVERSIDE

These ties are for the purpose of perpetuating the found monumentation. No claim is made as to the relationship of the points or lines shown hereon to true boundary locations.

SHEET

OF SHEETS

FILE NO.: