

TRACT 2623
AA WEBB
FB. 439 -
498 -
549 -

SWING
TIES

HOWE AVENUE
& MALVERN WAY
& MALVERN WAY
CUL-DE-SAC
COPY
CHECKED
6-13-69
JWS JR

Street: HOWE AVE
X-Street: MALVERN
OFFICIAL USE ONLY

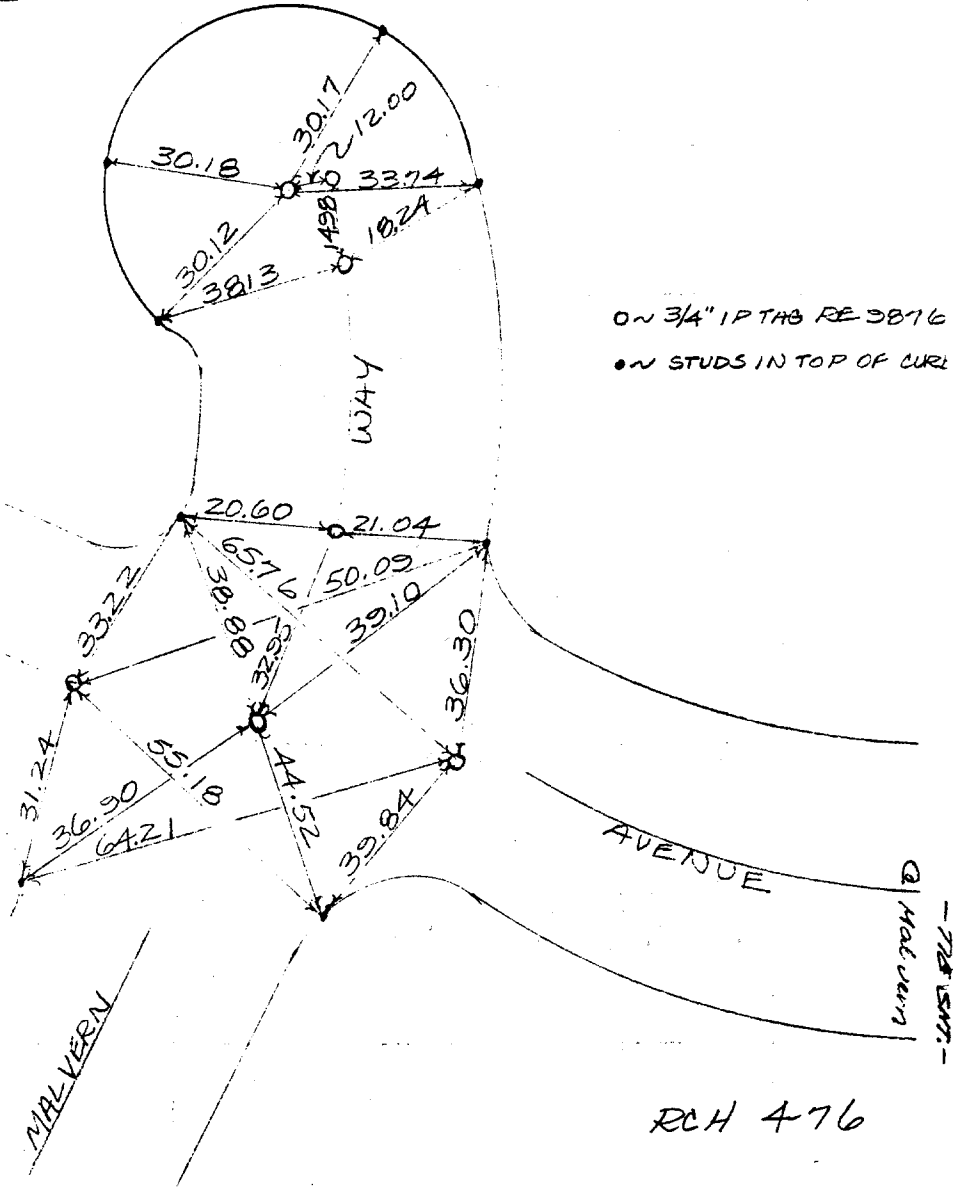

- ✕ FD. Ramset Nail on T/C
- FD. LD. & TK. on T/C
- FD. "C" Nail on T/C
- Set LD. & TK. on T/C

Scale:
Date:
Drawn by:
W.O.:
F.B.:

OFFICIAL TIE PLAT
CITY OF RIVERSIDE

These ties are for the purpose of perpetuating the found monumentation. No claim is made as to the relationship of the points or lines shown hereon to true boundary locations.

Sheet 1 of 1
File No.:

RCH 476