

328.71F

Street: ARLINGTON AVE

OFFICIAL USE ONLY

X-Street:

MONROE & AIRPORT RD #50

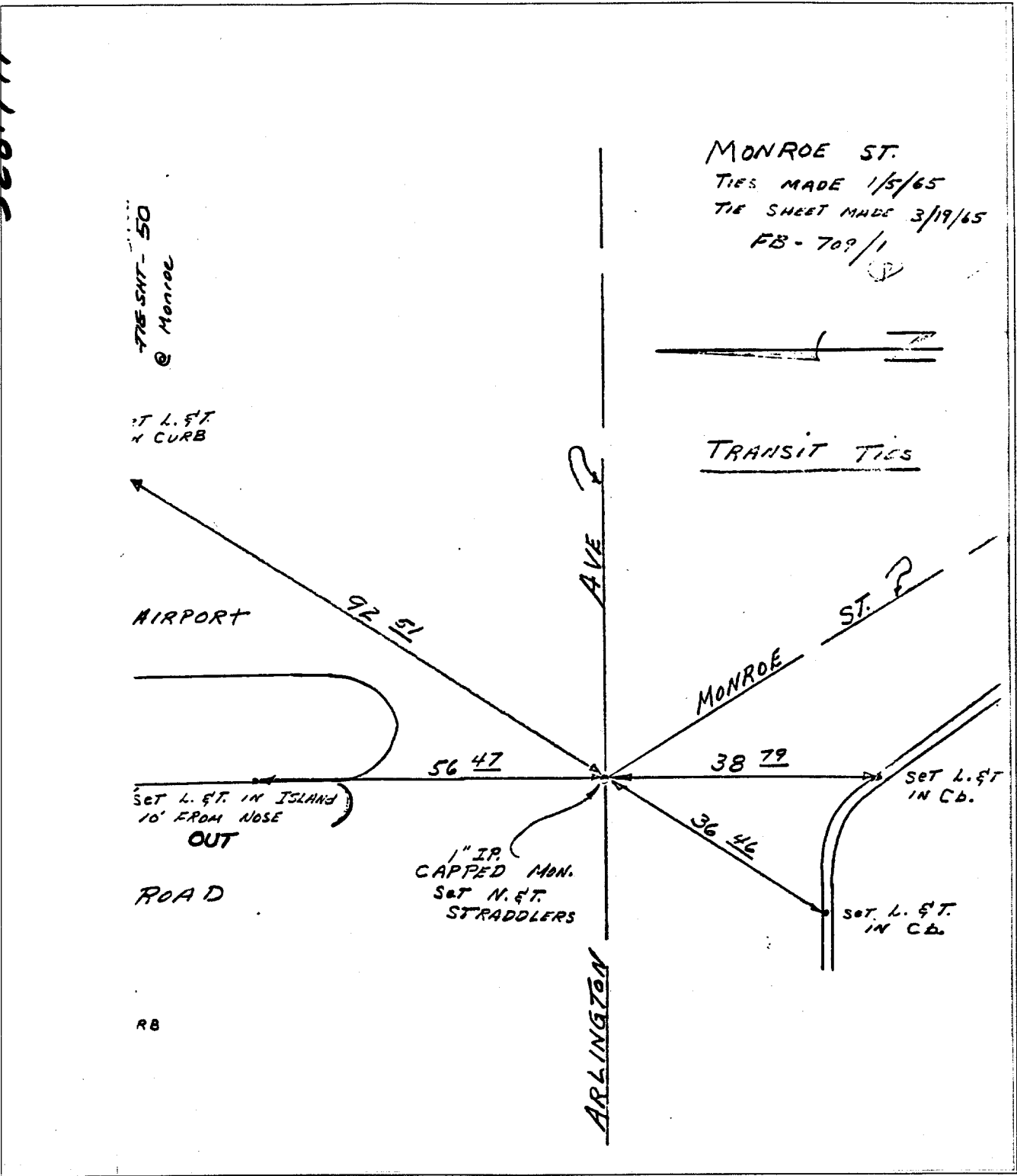

MONROE ST.
 TIES MADE 1/5/65
 TIE SHEET MADE 3/19/65
 FB-709/1

TIE SHEET - 50
 @ Monroe

Set L. & T.
 IN CURB

AIRPORT

Set L. & T. IN ISLAND
 10' FROM NOSE
 OUT

ROAD

RB

1" IP.
 CAPPED MAN.
 SET N. & T.
 STRADDLERS

TRANSIT TIES

- ✕ FD. Ramset Nail on T/C
- FD. "C" Nail on T/C

- FD. LD. & TK. on T/C
- Set LD. & TK. on T/C

Scale:
 Date:
 Drawn by:
 W.O.:
 F.B.:

OFFICIAL TIE PLAT

CITY OF RIVERSIDE

These ties are for the purpose of perpetuating the found monumentation. No claim is made as to the relationship of the points or lines shown hereon to true boundary locations.

Sheet 1 of 1
 File No.: