

439. TIE

TRANSIT TIES TO 1&1P
SWING TIES TO X TIED MH

ARLINGTON AVE
AT PHOENIX AVE
AND VIA SAN LUIS

HISTORICAL DATA
FB M/66
FB R1/7,8
FB R5/37
FB 301/17

CRFB

DATE	4-16-71
CREW	THORP
	FRIC
	NEW

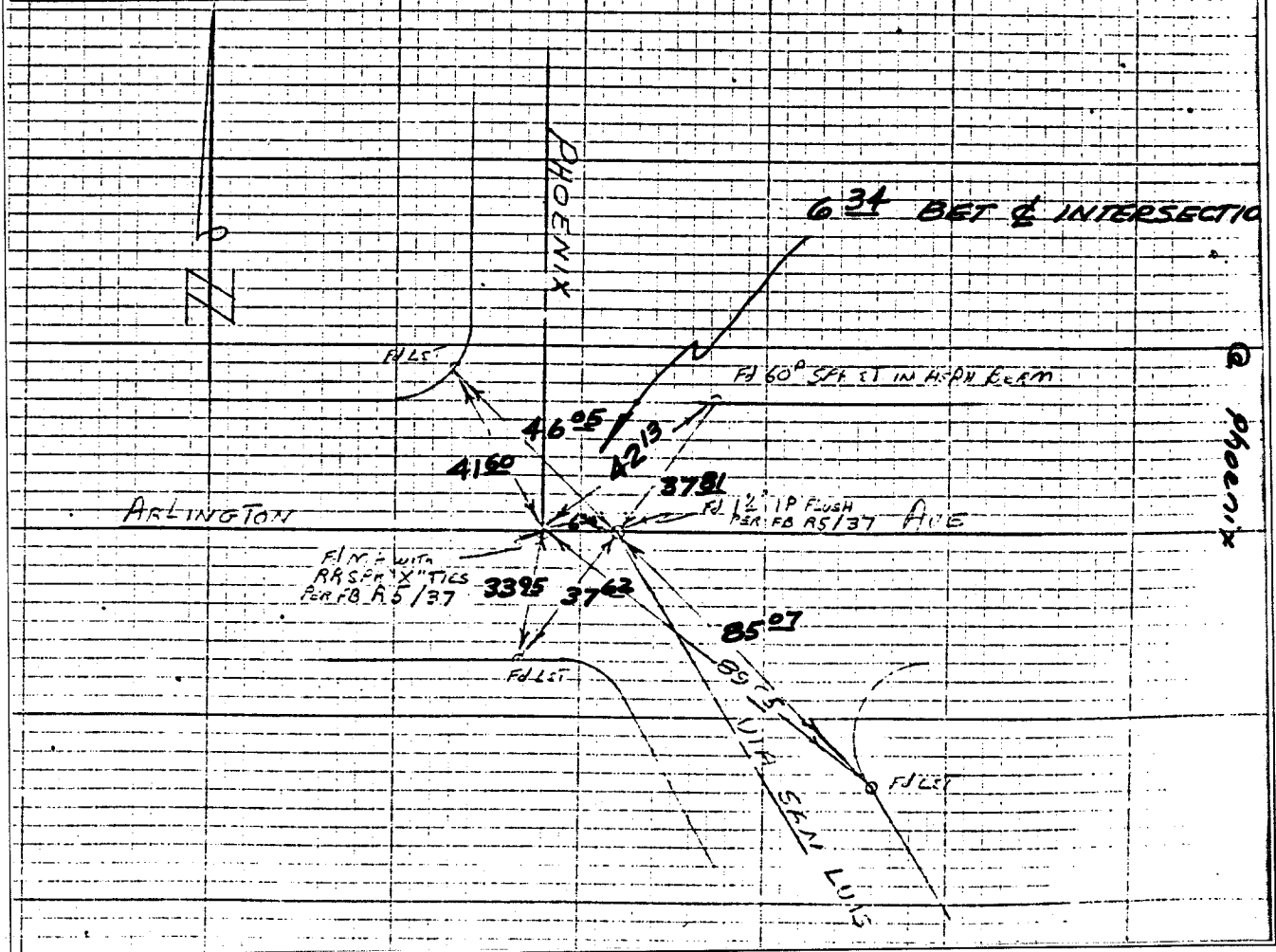

Street: ARLINGTON AVE
X-Street: PHOENIX & VIA SAN LUIS
OFFICIAL USE ONLY

- ✕ FD. Ramset Nail on T/C
- FD. LD. & TK. on T/C
- FD. "C" Nail on T/C
- Set LD. & TK. on T/C

Scale: _____
 Date: _____
 Drawn by: _____
 W.O.: _____
 F.B.: _____

OFFICIAL TIE PLAT

CITY OF RIVERSIDE

These ties are for the purpose of perpetuating the found monumentation. No claim is made as to the relationship of the points or lines shown hereon to true boundary locations.