

436.71F

Avl. Ave. EXT.  
B.C. E/4. Piedmont Dr.

Historical Data  
F.B. I/78

Field PARTY  
Went  
THUR  
F.B. 6.51/78  
3.20.68

TRANSIT TIES

"NOTE" B.C. APPROX. 925' E/4 OF Piedmont Dr.

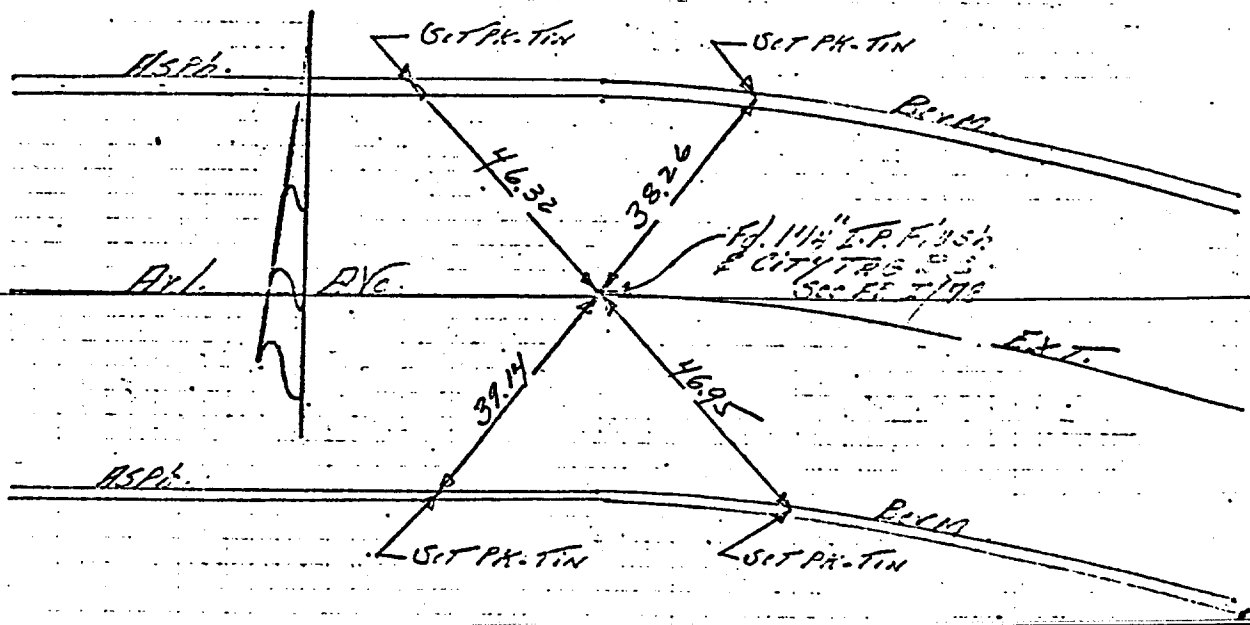

- ✗ FD. Ramset Nail on T/C
- FD. LD. & TK. on T/C
- FD. "C" Nail on T/C
- Set LD. & TK. on T/C

Street: Arlington Ave

X-Street: E/4 of Piedmont

# 58

OFFICIAL USE ONLY

Scale:  
Date:  
Drawn by:  
W.O.:  
F.B.:

## OFFICIAL TIE PLAT

### CITY OF RIVERSIDE

These ties are for the purpose of perpetuating the found  
monumentation. No claim is made as to the relationship of  
the points or lines shown hereon to true boundary locations.

Sheet 1 of 1  
File No.: