

4477.TIF

SWING TIES MT. VIEW & JURUPA

HISTORICAL DATA

- 1. 11/16/10
- 2. 5/14/56
- 3. 6/7/77

CREW

- HUTCHINSON
- THORP
- RUSSELL

DATE

10-14-68

CRFB 852/65

NOTE & REMARK ON SWING TIE SURVEYS - FB 446/65-70 FOR DISCREPANCY INFO. SEE 6PH

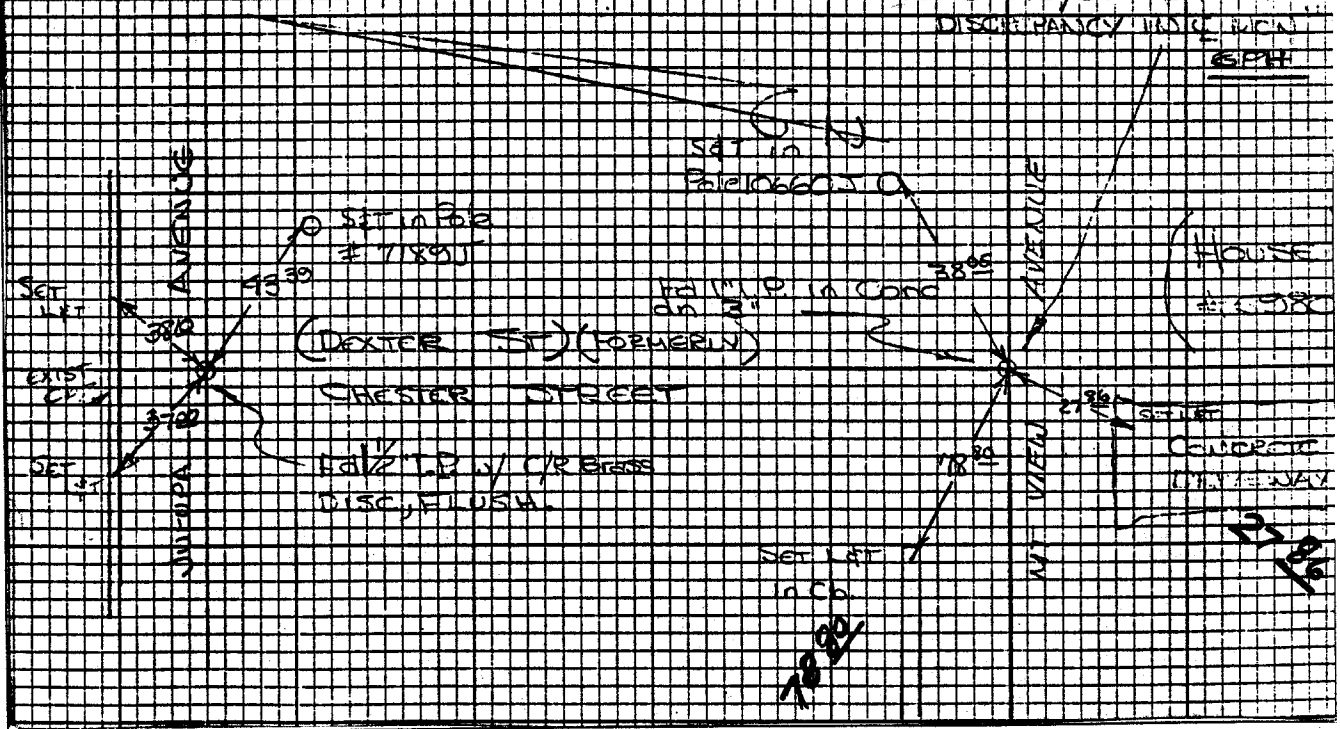

- × FD. Ramset Nail on T/C
- FD. LD. & TK. on T/C
- FD. "C" Nail on T/C
- Set LD. & TK. on T/C

Street: JURUPA AVE

OFFICIAL USE ONLY

X-Street: CHESTER

CHESTER

Scale:  
Date:  
Drawn by:  
W.O.:  
F.B.:

**OFFICIAL TIE PLAT**  
CITY OF RIVERSIDE

*These ties are for the purpose of perpetuating the found monumentation. No claim is made as to the relationship of the points or lines shown hereon to true boundary locations.*

Sheet 1 of 1  
File No.:

9