

450.71F

Street: *Arlington Ave*

OFFICIAL USE ONLY

X-Street: *Urban St*

#71

SWING TIES
CRFB 942/65

ARLINGTON AVE
@ URBAN ST

HISTORICAL DATA
FB 942/65
RS 2413

DATE	4-15-71
CREW	THORP RUSSELL NEW

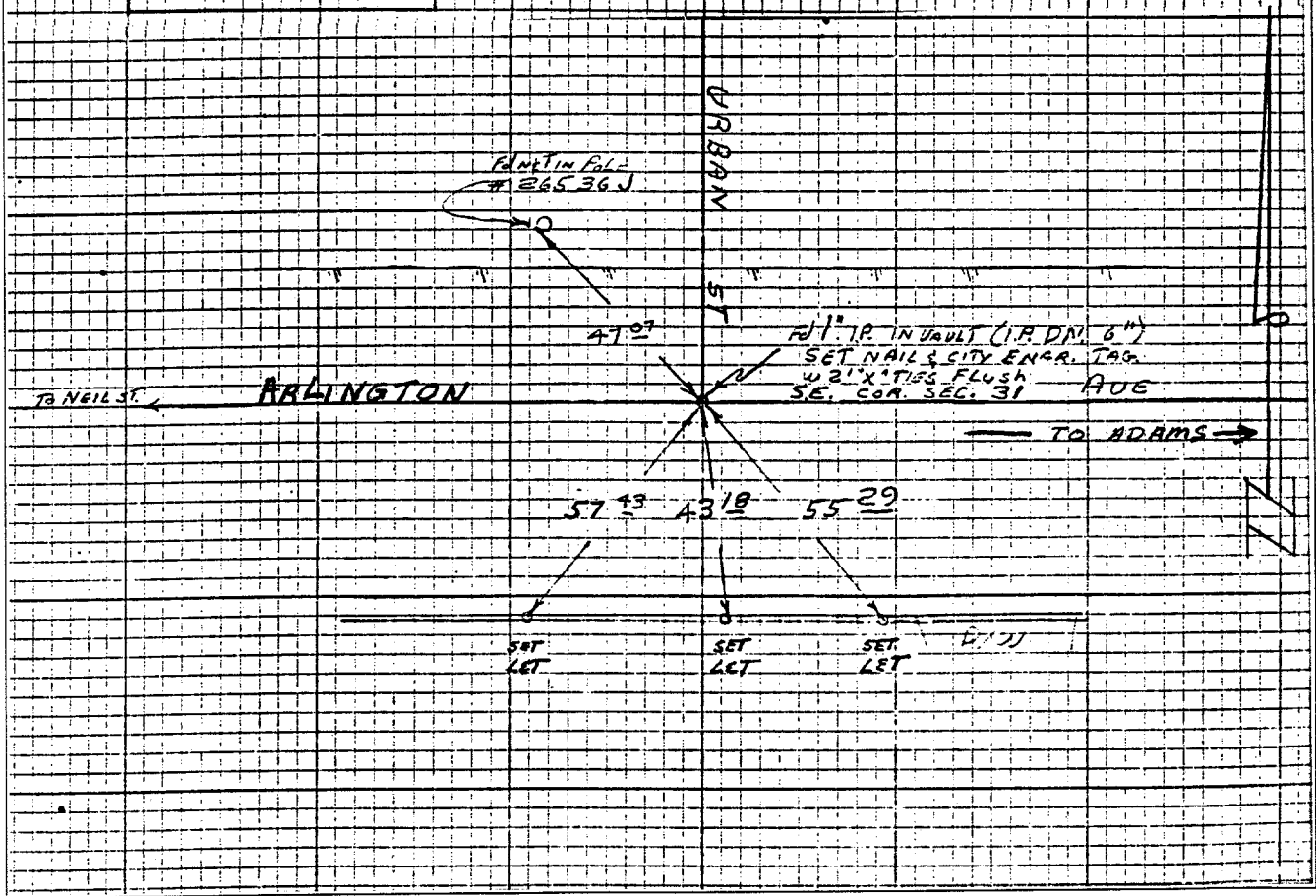

✕ FD. Ramset Nail on T/C
 ■ FD. "C" Nail on T/C

● FD. LD. & TK. on T/C
 ○ Set LD. & TK. on T/C

Scale:
 Date:
 Drawn by:
 W.O.:
 F.B.:

OFFICIAL TIE PLAT
CITY OF RIVERSIDE

These ties are for the purpose of perpetuating the found monumentation. No claim is made as to the relationship of the points or lines shown hereon to true boundary locations.

Sheet 1 of 1
 File No.: