

Street: LENOX AVE

X-Street: GREYLOCK AVE
OFFICIAL USE ONLY

LENOX AVE
AT THE S.W. CORNER SWLY OF
GREYLOCK AVE

HISTORICAL DATA F.B. 565/14	SWING TIES	CREW FRYO RUSSELL
		JUNE 26, 1972 F.B. 589/37

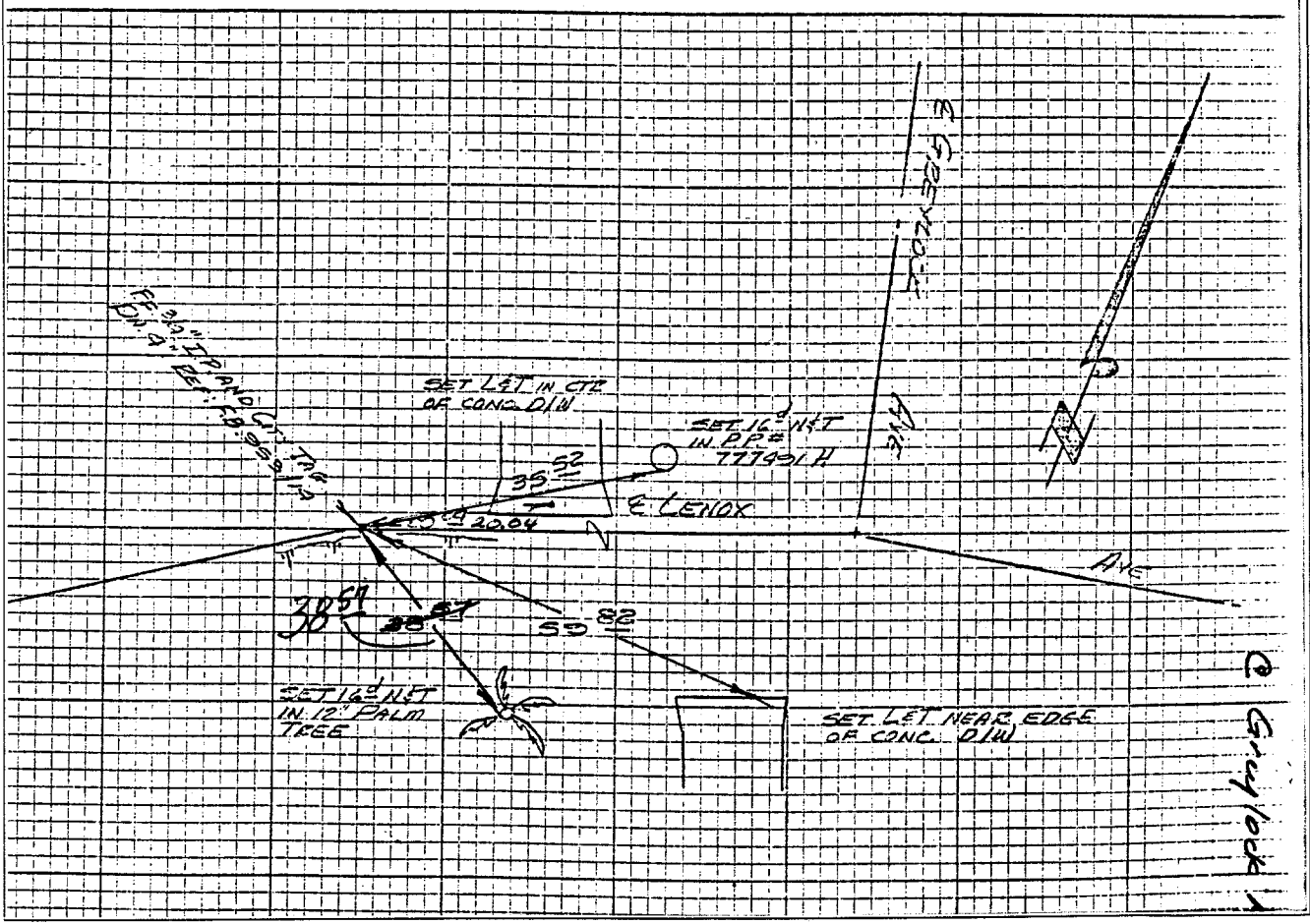

- ✕ FD. Ramset Nail on T/C
- FD. LD. & TK. on T/C
- FD. "C" Nail on T/C
- Set LD. & TK. on T/C

Scale:
Date:
Drawn by:
W.O.:
F.B.:

OFFICIAL TIE PLAT
CITY OF RIVERSIDE

These ties are for the purpose of perpetuating the found monumentation. No claim is made as to the relationship of the points or lines shown hereon to true boundary locations.

Sheet 1 of 1
File No.: